



£499,950

Ramilus Drive, Hayes, UB4



- 3 Bedrooms
- Semi Detached
- Potential To Extend STPP
- Full Width Kitchen
- Garage & Off Street Parking
- Convenient Location

A modern three-bedroom semi-detached family home situated within a highly sought-after 1980s development. Boasting a side garage and a private driveway with parking for up to four cars, the property offers fantastic potential for a substantial extension, subject to planning permission (STPP). The ground floor features a bright, spacious lounge leading into a contemporary, full-width fitted kitchen and dining room. Upstairs, you will find three comfortable bedrooms, a modern family bathroom, and useful loft storage space. Externally, the property enjoys a generous, beautifully maintained lawned garden with rear access. Located in a prime position near Willow Tree Marina and a major Tesco superstore, Ramilus Drive benefits from superb transport links. Commuters are well-served by Northolt (Central Line) and Hayes (Elizabeth Line) stations, alongside excellent road networks including the A40, M4, and Hayes-by-Pass for easy access to Heathrow, London, and surrounding areas.



Ramulis Drive, Yeading, UB4 9QA

Approximate Gross Internal Area = 68.74 sq m / 740 sq ft

Garage = 15.16 sq m / 163 sq ft

Total = 83.90 sq m / 903 sq ft

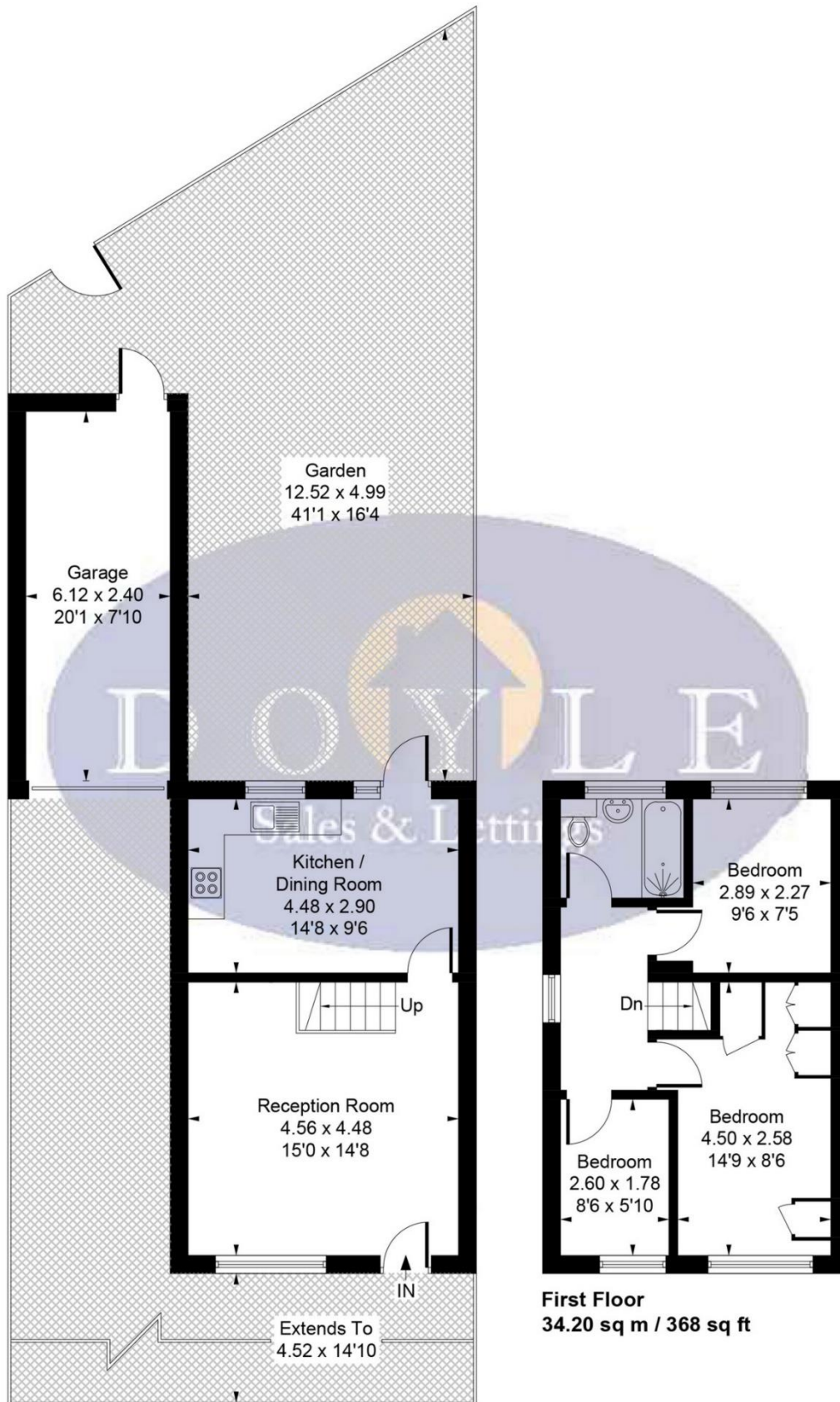
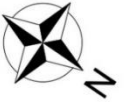

Whilst every attempt has been made to ensure the accuracy of the floor plan contained here, measurements of doors, windows, rooms and any other items are approximate and no responsibility is taken for any error, omission, or mis-statement.

This plan is for illustrative purposes only and should be used as such by any prospective purchaser.

© Vizion Property Marketing Produced for Doyle Sales & Lettings

Map

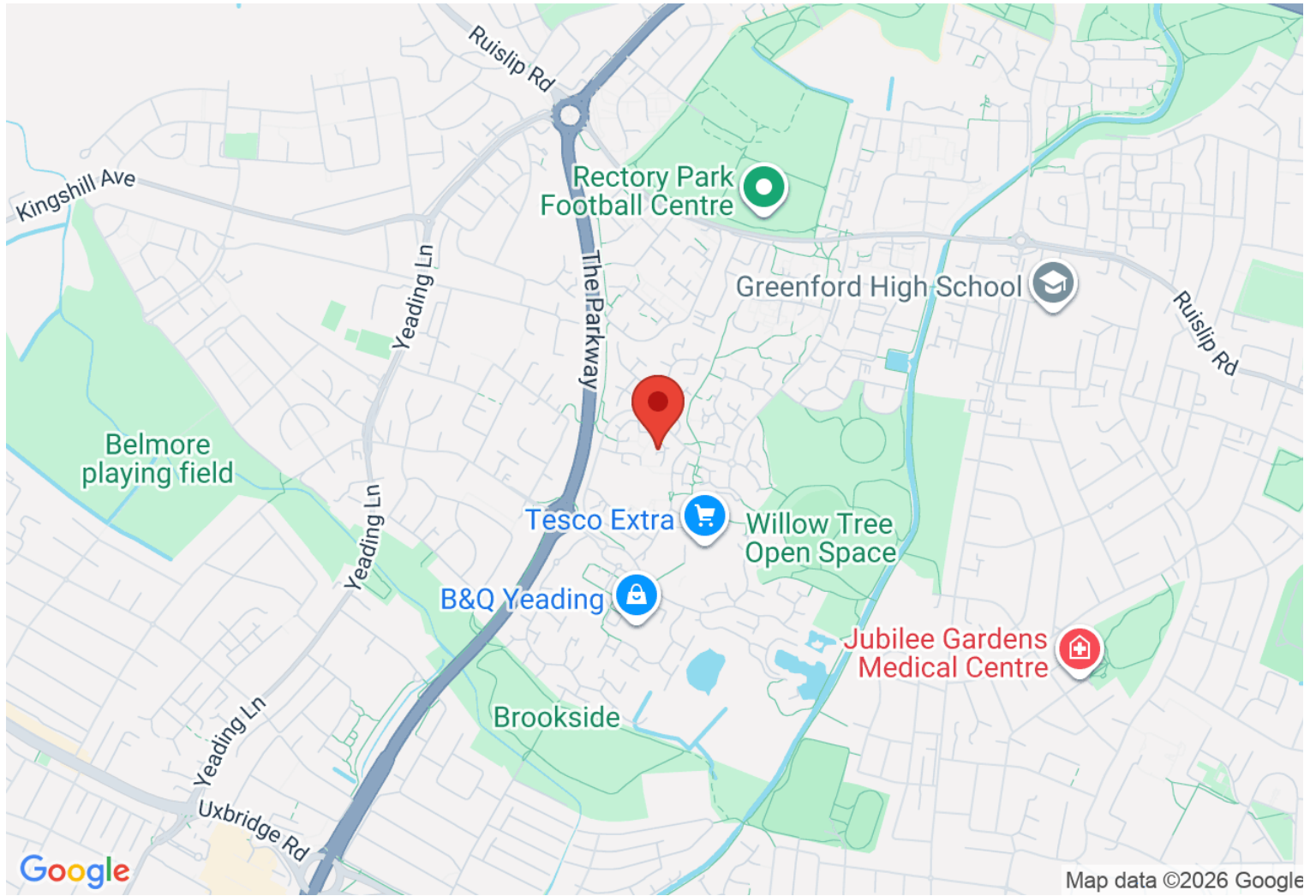

VIEWING BY APPOINTMENT WITH AGENTS DOYLE SALES & LETTINGS

11 Broadway Buildings, Boston Rd, Hanwell, London, W7 3TT T: 020 8840 0171 E: info@doylesalesandlettings.co.uk W: www.doylesalesandlettings.co.uk

General: While we endeavour to make our sales particulars fair, accurate and reliable, they are only a general guide to the property and, accordingly, if there is any point which is of particular importance to you, please contact the office and we will be pleased to check the position for you, especially if you are contemplating travelling some distance to view the property.

Measurements: These approximate room sizes are only intended as general guidance. You must verify the dimensions carefully before ordering carpets or any built-in furniture.

Services: Please note we have not tested the services or any of the equipment or appliances in this property, accordingly we strongly advise prospective buyers to commission their own survey or service reports before finalizing their offer to purchase.

THESE PARTICULARS ARE ISSUED IN GOOD FAITH BUT DO NOT CONSTITUTE REPRESENTATIONS OF FACT OR FORM PART OF ANY OFFER OR CONTRACT. THE MATTERS REFERRED TO IN THESE PARTICULARS SHOULD BE INDEPENDENTLY VERIFIED BY PROSPECTIVE BUYERS OR TENANTS. NEITHER DOYLE SALES & LETTINGS NOR ANY OF ITS EMPLOYEES OR AGENTS HAS ANY AUTHORITY TO MAKE OR GIVE ANY REPRESENTATION OR WARRANTY WHATEVER IN RELATION TO THIS PROPERTY.

YOUR HOME IS AT RISK IF YOU DO NOT KEEP UP REPAYMENTS ON A MORTGAGE OR OTHER LOAN SECURED ON IT.

Written quotations available on request. All loans secured on property. Life assurance is usually required.

EPC Rating C

