



Barlow Drive, SE18

£650,000

Dexters



Barlow Drive, SE18

A well-presented three-bedroom link-detached house, ideally positioned on a quiet cul-de-sac and benefitting from off-street parking. Offering well-balanced accommodation throughout, this property would make an ideal family home. The ground floor comprises a spacious reception room to the front, providing an excellent living and entertaining space. To the rear is a large kitchen/diner with ample room for dining, which flows through to a bright conservatory overlooking the garden. A convenient downstairs WC completes the ground floor accommodation. On the first floor are three well-proportioned bedrooms and a family bathroom, while the principal bedroom further benefits from an en-suite shower room, providing excellent practicality for modern family living. Further benefits include a peaceful residential setting, off-street parking, three WCs in total and no onward chain..

Situated in a much sought after development in Shooters Hill, close to bus routes for the Elizabeth Line, Woolwich Arsenal DLR and to Blackheath Village. There is a much sought after Secondary school within walking distance and Oxleas Woods.

Features

- Three Double Bedrooms
- Link Detached House
- Off Street Parking
- Chain Free
- Garage
- Cul-De-Sac Road







Barlow Drive, London, SE18

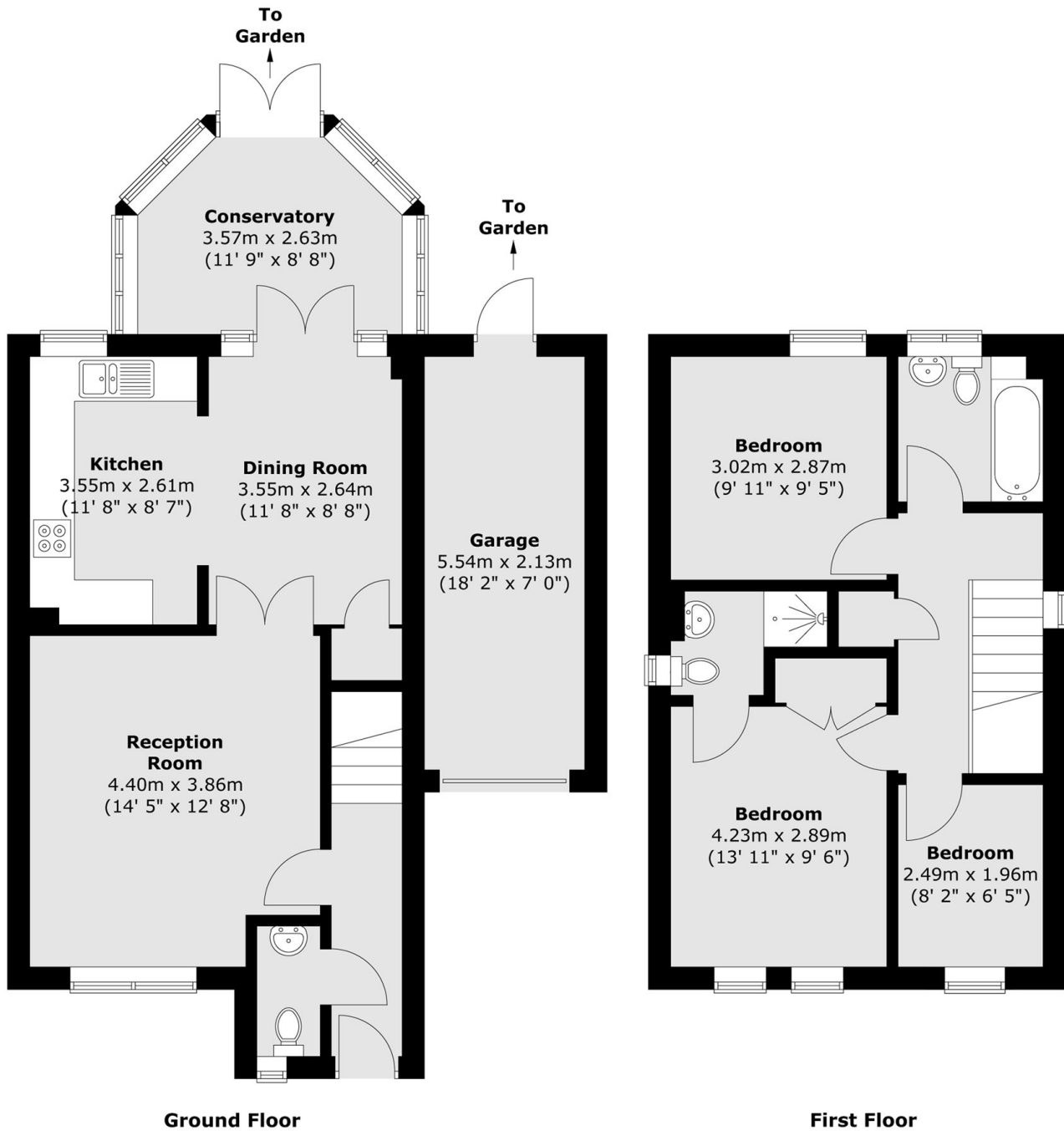

Total area (approx.) : 94.2 sq. m (1014 sq. ft)
Total garage area (approx.) : 12.1 sq. m (130 sq. ft)