



A spacious one bedroom apartment in a central location for all amenities  
Bryant Apartments, Harrow, HA1 1GY

**ROBSONS**

**Asking Price: £1,800 pcm**

## **A spacious one bedroom apartment in a central location for all amenities**

Bryant Apartments, Harrow, HA1 1GY

- 
- TWELVE HOUR CONCIERGE SERVICE
  - LIFT TO ALL FLOORS - CCTV
  - LIVING ROOM OPEN PLAN TO
  - FITTED KITCHEN
  - BALCONY WITH FAR REACHING VIEWS
  - BEDROOM
  - BATHROOM
  - UNFURNISHED
- 

### **Description**

Robsons are pleased to present this spacious one-bedroom apartment in the Harrow Square development next to Harrow on the Hill station. The flat comprises a well-proportioned living space, down-lighters to the hallway, one double bedrooms, a modern bathroom and an open-plan kitchen. The property also features high end fixtures and fittings throughout. Individually designed kitchen has white matt soft-close doors and drawers, fully integrated appliances including single oven, ceramic hob, microwave, extractor fan, dishwasher, and fridge/freezer. Fitted wardrobe in the master bedroom, carpets to all bedrooms, USB points to the master bedroom, Superfast broadband (subject to subscription). The development benefits from a twelve hours concierge service, lift access, CCTV security system coverage and interior designed entrance foyer.

### **Location**

Superb transport links from Harrow-on-the-Hill Station include Underground services to Baker Street and the City (Metropolitan Line) and National Rail services to Paddington (Chiltern Railways). Also a range of shopping facilities and super markets are available locally.





**Additional Information**

- Local Authority: Harrow
- Council Tax Band: C
- Deposit Amount: £2,076.00
- Reservation Payment: One weeks rent
- Energy Efficiency Rating: Band B
- Available Date: 04/07/2026

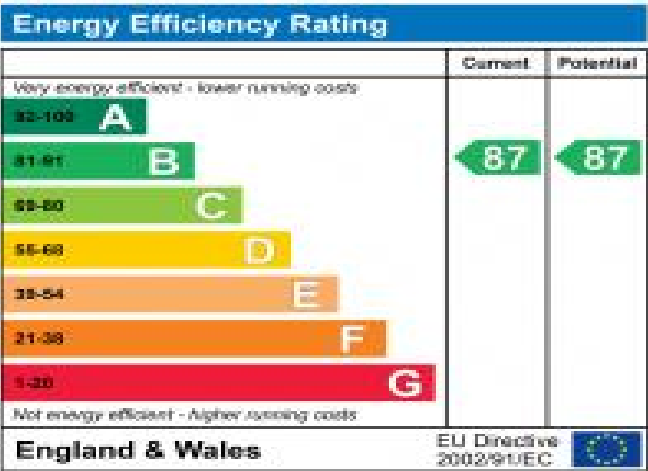

# Bryant Apartments



Approximate Gross Internal Area = 62.0 sq m / 667 sq ft

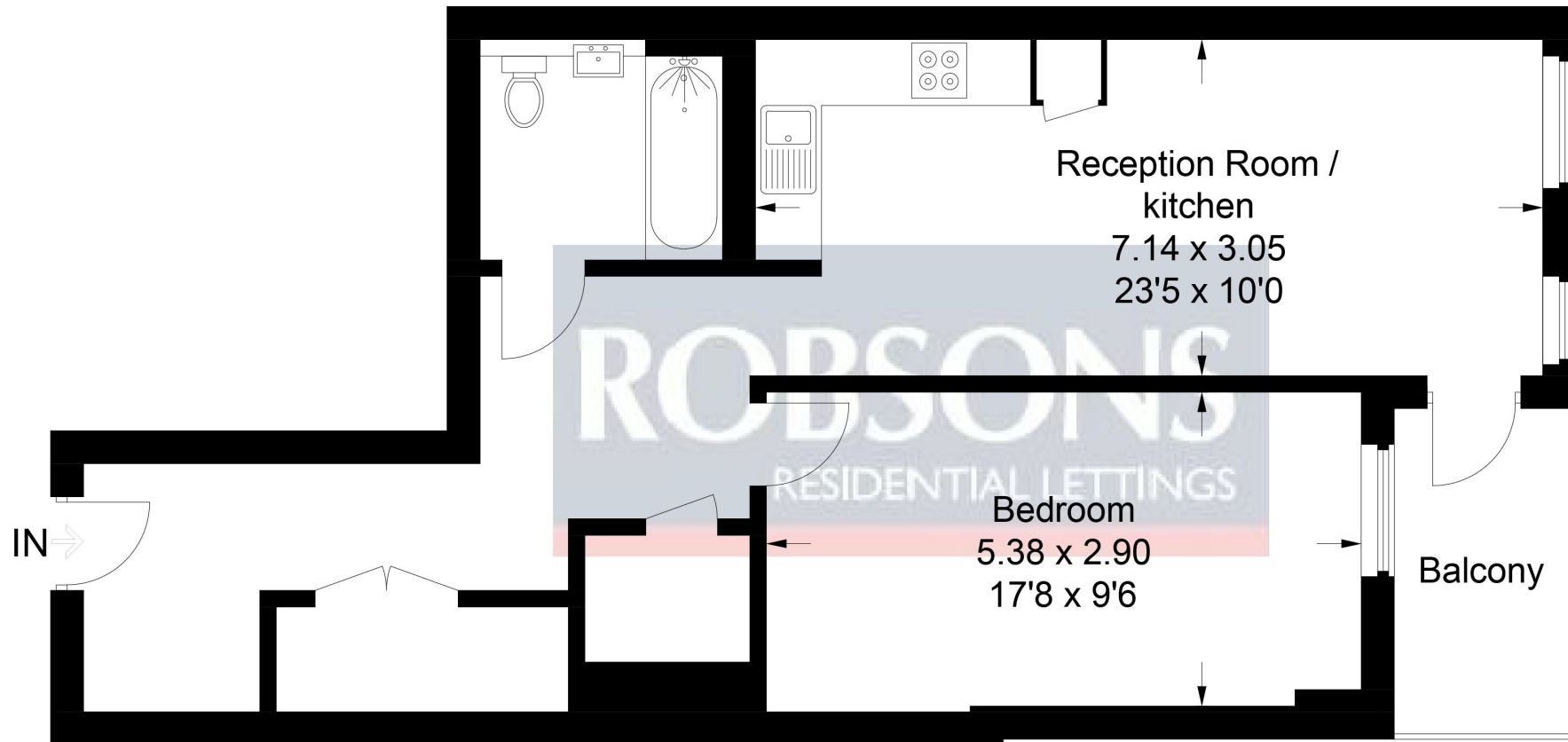

## Thirteenth Floor

This plan is for layout guidance only. Not drawn to scale unless stated. Windows and door openings are approximate. Whilst every care is taken in the preparation of this plan, please check all dimensions, shapes and compass bearings before making any decisions reliant upon them.

© CJ Property Marketing Ltd Produced for Robsons



REGISTERED OFFICE 2-4 PACKHORSE ROAD, GERRARDS CROSS, BUCKINGHAMSHIRE, ENGLAND, SL9 7QE. COMPANY NO. 07557114. VAT NO. GB211239453