



**Willowbrook Drive, Cheltenham, GL51**  
**£200,000**

**ADAM  
HALLIWELL**  
property

exp <sup>UK</sup>

**Bedrooms:** 2

**Bathrooms:** 1

**Receptions:** 1

A two-bedroom terraced house on a residential cul de sac on the edge of Cheltenham, offering off-street parking, a south-facing rear garden, practical accommodation suited to first-time buyers or investors, and convenient access to green spaces, local transport links and the town centre.

For sale: a two-bedroom terraced house situated in a residential cul de sac on the edge of Cheltenham, overlooking a green space. The property is suited to first-time buyers and investors, offering practical accommodation with parking and a south-facing garden with gated access.

The ground floor comprises a living room to the front with space for dining and a staircase leading to the first floor. The kitchen enjoys good natural light and provides direct access to the rear garden, which benefits from a southerly aspect, ideal for outdoor seating and low-maintenance planting.

Upstairs, there are two double bedrooms and a bathroom fitted with a shower over the bath. The house falls within Council Tax Band B.

The location offers a residential setting while remaining accessible to Cheltenham town centre, known for its shops, cafés and cultural venues. Nearby green spaces provide opportunities for walking and recreation.

Public transport links are available via Cheltenham Spa railway station, typically around 10–15 minutes' drive, with services to Bristol, Birmingham and London Paddington; journey times are often around 40–50 minutes to Bristol, just under an hour to Birmingham and approximately two hours to London, subject to timetable. Local bus routes provide access into central Cheltenham and surrounding areas.

This two-bedroom terraced house, for sale with no onward chain, combines off-street parking, a south-facing garden and a cul de sac position on the edge of town.





### Property Type: Terraced House

For sale: a two-bedroom terraced house situated in a residential cul de sac on the edge of Cheltenham, overlooking a green space. The property is suited to first-time buyers and investors, offering practical accommodation with parking and a south-facing garden with gated access.

The ground floor comprises a living room to the front with space for dining and a staircase leading to the first floor. The kitchen enjoys good natural light and provides direct access to the rear garden, which benefits from a southerly aspect, ideal for outdoor seating and low-maintenance planting.

Upstairs, there are two double bedrooms and a bathroom fitted with a shower over the bath. The house falls within Council Tax Band B.

The location offers a residential setting while remaining accessible to Cheltenham town centre, known for its shops, cafés and cultural venues. Nearby green spaces provide opportunities for walking and recreation.

Public transport links are available via Cheltenham Spa railway station, typically around 10–15 minutes' drive, with services to Bristol, Birmingham and London Paddington; journey times are often around 40–50 minutes to Bristol, just under an hour to Birmingham and approximately two hours to London, subject to timetable. Local bus routes provide access into central Cheltenham and surrounding areas.

This two-bedroom terraced house, for sale with no onward chain, combines off-street parking, a south-facing garden and a cul de sac position on the edge of town.

- Two double bedrooms
- Residential cul de sac
- South-facing low-maintenance garden
- Off-street parking included
- No onward chain sale
- Overlooking green open space
- Light-filled kitchen to garden
- Ideal for first-time buyers
- Potential landlord investment
- Access to Cheltenham town centre and retail parks



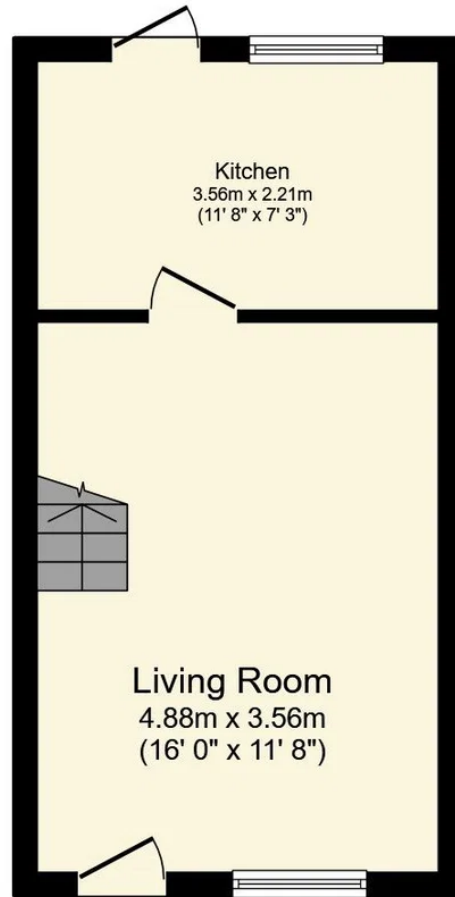

Ground Floor

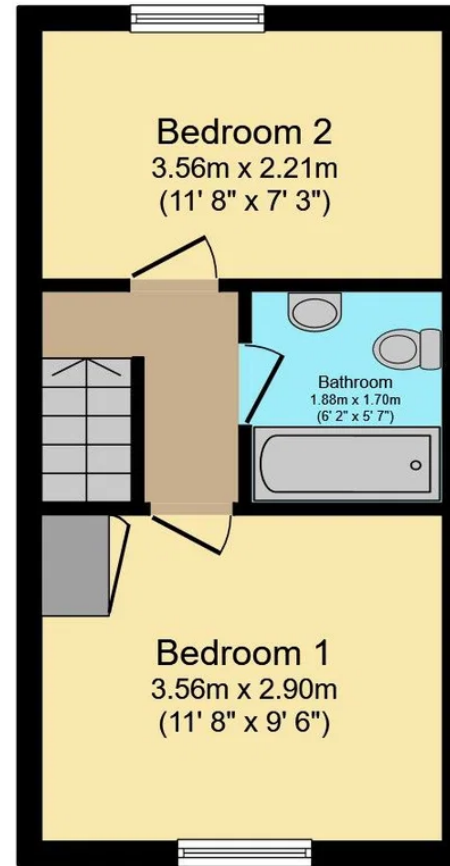

First Floor

Total floor area: 51.1 sq.m. (550 sq.ft.)

This floor plan is for illustrative purposes only. It is not drawn to scale. Any measurements, floor areas (including any total floor area), openings and orientations are approximate. No details are guaranteed, they cannot be relied upon for any purpose and do not form any part of any agreement. No liability is taken for any error, omission or misstatement. A party must rely upon its own inspection(s). Powered by [www.Propertybox.io](http://www.Propertybox.io)

**Willowbrook Drive, Cheltenham, GL51**

**£200,000**

**ADAM  
HALLIWELL**  
property

exp UK