



Foxhall Road, Ipswich, £170,000



GRACE ESTATE AGENTS are delighted to present this two-bedroom end-terrace bungalow located in the area of East Ipswich, this charming two-bedroom mid-terrace bungalow on Foxhall Road offers a perfect blend of modern living and comfort.

As you enter, you are greeted by a bright and airy open kitchen/diner, which serves as the heart of the home. This space is perfect for entertaining guests or enjoying family meals, with ample room for dining and cooking. The layout is designed to maximise both functionality and comfort, ensuring that every inch of the space is utilised effectively.

The two well-proportioned bedrooms provide a peaceful retreat, each offering the potential for personalisation to suit your style. The property benefits from off-road parking, a valuable feature in this sought-after area, allowing for convenience and ease of access.

With its modern design and practical amenities, this bungalow is not only a lovely home but also a fantastic investment opportunity. The location offers easy access to local shops, schools, and transport links, making it a perfect base for those who wish to explore all that Ipswich has to offer.

This delightful bungalow on Foxhall Road is a rare find in East Ipswich, combining contemporary living with a welcoming atmosphere. Do not miss the chance to make this property your own.

- Two Bedroom End-Terrace Bungalow
- Located In East Ipswich
- Open Plan Kitchen/Diner
- Desirable School Catchment Area
- Gated Parking With One Allocated Space

Guide price £170,000

Viewing

Please contact our Grace Estate Agents Office on 01473 747728 if you wish to arrange a viewing appointment for this property or require further information.

GROUND FLOOR
444 sq.ft. (41.3 sq.m.) approx.

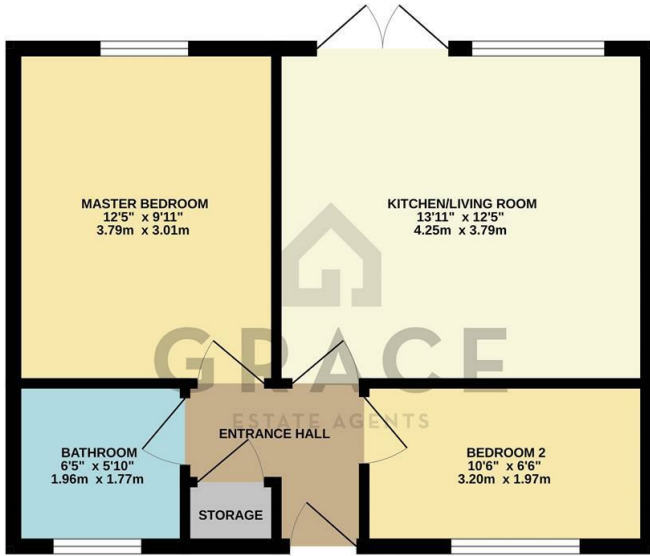

TOTAL FLOOR AREA - 444 sq.ft. (41.3 sq.m.) approx.

Whilst every attempt has been made to ensure the accuracy of the floorplan contained here, measurements of doors, windows, rooms and any other items are approximate and no responsibility is taken for any error, omission or mis-statement. This plan is for illustrative purposes only and should be used as such by any prospective purchaser. The services, systems and appliances shown have not been tested and no guarantee, as to their operability or efficiency can be given.
Made with Metropix CC0/2.0

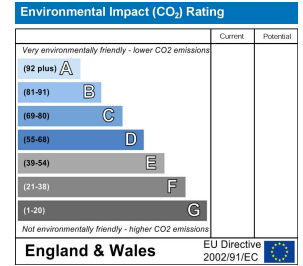
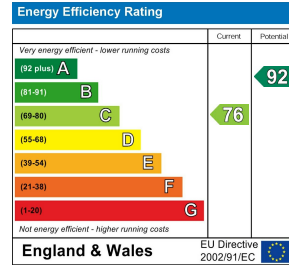

These particulars, whilst believed to be accurate are set out as a general outline only for guidance and do not constitute any part of an offer or contract. Intending purchasers should not rely on them as statements of representation of fact, but must satisfy themselves by inspection or otherwise as to their accuracy. No person in this firm's employment has the authority to make or give any representation or warranty in respect of the property.