



**Connells**

Brewery Lane  
Bridge Canterbury



### Property Description

Guide Price £250,000 to £260,000

This beautifully presented, mid terrace, cottage style home is an ideal first time buy, ready to move in to and providing very convenient transport links to Canterbury and Dover.

Set in the village of Bridge, the property is finished to a very modern standard to include fully fitted kitchen with space for a dining table under the stairs and door leading to the rear garden. There is a comfortable lounge area with bio ethanol burner and bespoke built in cupboard and shelving space.

To the first floor you will find a double bedroom with built in wardrobes, a single room with built in shelf for a raised bed. There is a modern shower room made up of matching suite including shower cubicle, WC and wash hand basin with vanity unit.

The rear garden is made up of decking and patio areas with a large wooden shed that can be left as part of the purchase if necessary.

Within easy reach of Bridge's local shops and pub, regular bus routes and straight forward road access to the A2 leading to Canterbury and Dover.



## Lounge

11' 7" x 9' 8" ( 3.53m x 2.95m )

front door, sash window, rad, bioethanol heater, laminate flooring, storage, shelves

## Kitchen

11' 8" x 9' 10" ( 3.56m x 3.00m )

window to rear, wall and base units, wall mounted oven, electric hob, sink, stairs to first floor, boiler, space for fridge freezer, laminate flooring.

## Bedroom One

11' 11" x 9' 10" ( 3.63m x 3.00m )

Laminate flooring, window to front, rad, built in cupboards

## Bedroom Two

7' 4" x 4' 2" ( 2.24m x 1.27m )

window to rear, laminate flooring cupboard and bench,

## Bathroom

shower cubical, wc, basin and vanity unit, part tiled walls, window, heated towel rail, rad

## Rear Garden

patio, decking, wooden shed







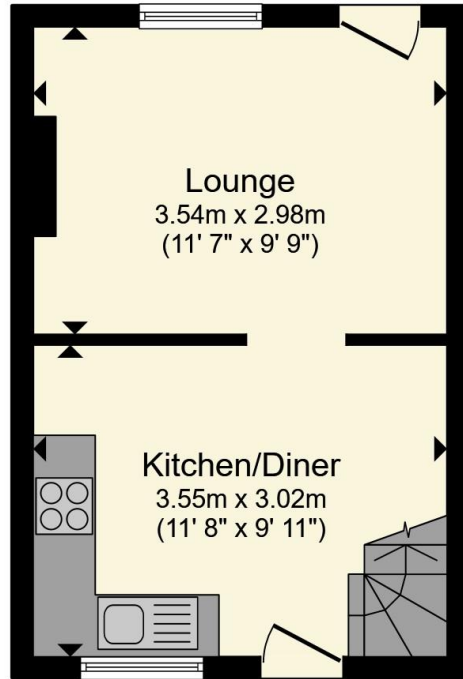

**Ground Floor**

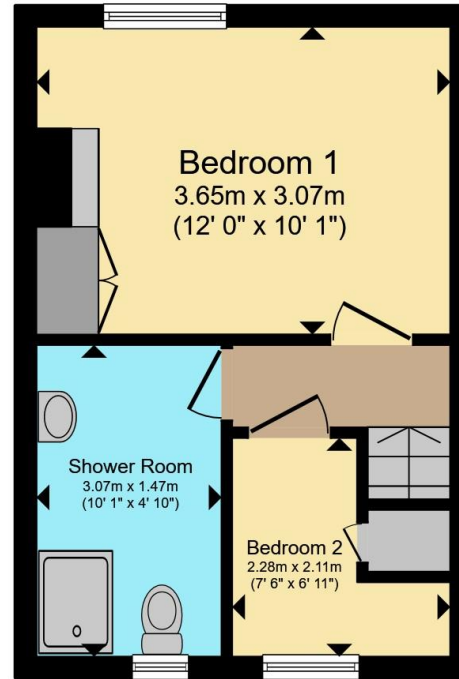

**First Floor**

Total floor area 48.8 m<sup>2</sup> (525 sq.ft.) approx

This floor plan is for illustrative purposes only. It is not drawn to scale. Any measurements, floor areas (including any total floor area), openings and orientation are approximate. No details are guaranteed, they cannot be relied upon for any purpose and they do not form part of any agreement. No liability is taken for any error, omission or misstatement. A party must rely upon its own inspection(s). Powered by [www.propertybox.io](http://www.propertybox.io)



To view this property please contact Connells on

**T 01227 764 720**

**E [canterbury@connells.co.uk](mailto:canterbury@connells.co.uk)**

29-30 Watling Street  
CANTERBURY CT1 2UD

EPC Rating: C Council Tax  
Band: B

Tenure: Freehold

**view this property online [connells.co.uk/Property/CBY406908](http://connells.co.uk/Property/CBY406908)**



1. MONEY LAUNDERING REGULATIONS Intending purchasers will be asked to produce identification documentation at a later stage and we would ask for your co-operation in order that there will be no delay in agreeing the sale. 2. These particulars do not constitute part or all of an offer or contract. 3. The measurements indicated are supplied for guidance only and as such must be considered incorrect. Potential buyers are advised to recheck measurements before committing to any expense. 4. We have not tested any apparatus, equipment, fixtures, fittings or services and it is in the buyers interest to check the working condition of any appliances.

Connells Residential is registered in England and Wales under company number 1489613, Registered Office is Cumbria House, 16-20 Hockliffe Street, Leighton Buzzard, Bedfordshire, LU7 1GN. VAT Registration Number is 500 2481 05.

**See all our properties at [www.connells.co.uk](http://www.connells.co.uk) | [www.rightmove.co.uk](http://www.rightmove.co.uk) | [www.zoopla.co.uk](http://www.zoopla.co.uk)**

Property Ref: CBY406908 - 0003