



Ivor Court, NW1

£800,000



- Two double bedrooms
- South facing views
- Lift
- Porter
- Long lease
- Energy rating: e

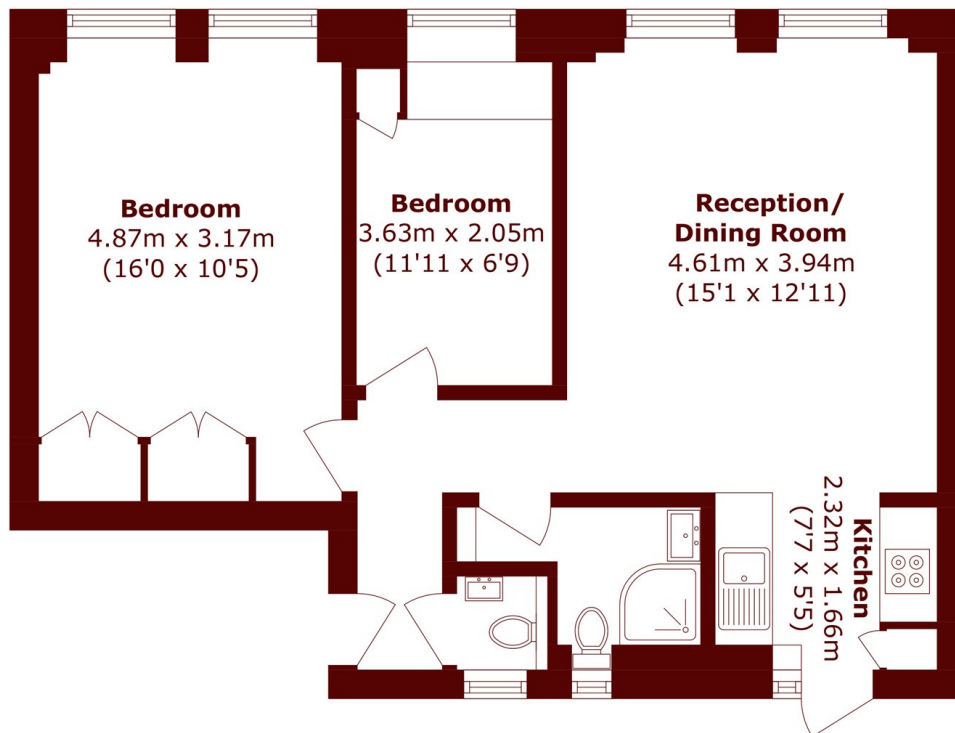

Seventh Floor

Total area (approx.): 56.1 sq. m (603.9 sq. ft)

Marsh & Parsons Marylebone & Mayfair

94 Baker Street, London,
W1U 6FZ
020 7935 1775