



# Plough Way

London, SE16

Offers in excess of £900,000

A beautifully refurbished four-bedroom home, spanning over 1,500 sq ft and finished to an exceptional standard, offered chain free.

**CHESTERTONS**



# Plough Way

## London, SE16

- Fully refurbished to exceptional standard
- Four spacious double bedrooms
- Three contemporary bathrooms
- Open-plan kitchen and dining space
- 32 ft private garden
- Garage and off-street parking
- Chain free sale
- Excellent transport links



This outstanding family home has been comprehensively redesigned and refurbished to create a stylish and elegant living environment, perfectly suited to modern lifestyles. The ground floor is centred around a stunning open-plan kitchen and dining space, finished with high-quality fittings and integrated appliances, seamlessly extending out to a private 32 ft garden. This sun-filled outdoor space provides the perfect setting for entertaining, al fresco dining, and relaxed family living, while a private garage and driveway offer excellent practicality. Arranged over the upper floors are four well-proportioned bedrooms, including a superb principal suite with a contemporary en-suite, complemented by two further beautifully appointed bathrooms. A separate reception room offers a calm and inviting retreat, overlooking the garden and ideal for both relaxing and hosting guests.

Situated on the ever-popular Plough Way, the property is ideally positioned for the amenities of Surrey Quays and Canada Water, including a wide selection of shops, cafés, and restaurants. Excellent transport links are close by, with Canada Water Underground (Jubilee Line) and Overground services providing swift access to Canary Wharf, the City, and beyond. This exceptional home is offered to the market with no onward chain.

---

**Tenure:** Freehold

**Service Charge:** £0

**Ground Rent:** £0

**Local Authority:** London Borough of Southwark

**Council Tax Band:** F

---

### *Chestertons Surrey Quays Sales*

2 Plough Way

London

SE16 2EU

+44 (0)20 7378 0644

[chestertons.co.uk](https://www.chestertons.co.uk)

Plough Way, SE16



○ - Ceiling Height

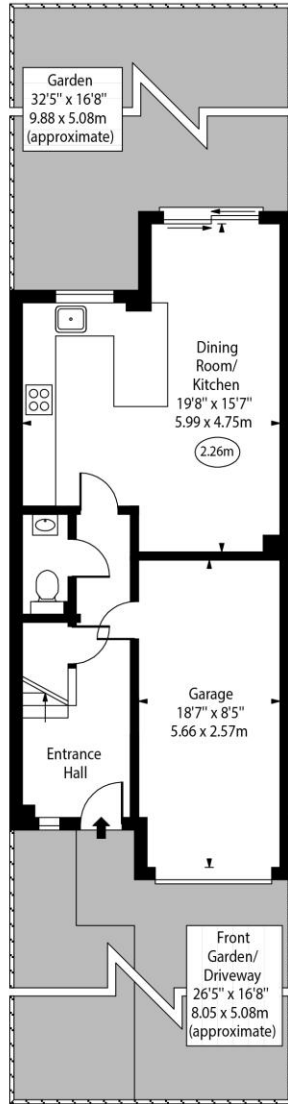

Ground Floor

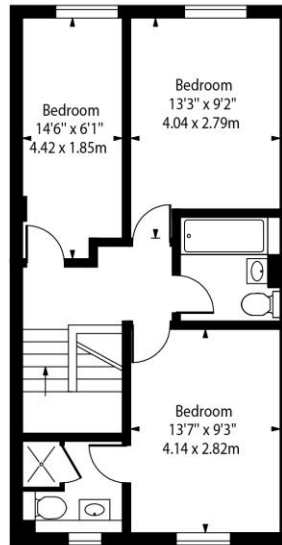

Second Floor

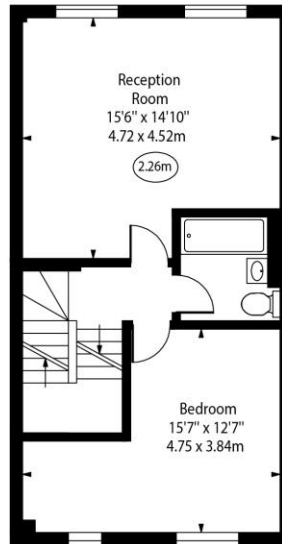

First Floor

Approx Gross Internal Area 1512 Sq Ft - 140.46 Sq M  
(Including Garage)

Every attempt has been made to ensure the accuracy of the floor plan shown. However, all measurements, fixtures, fittings, and data shown are approximate interpretations and for illustrative purposes only. Measured according to the RICS. Not To Scale.

www.goldlens.co.uk  
Ref. No. 032110K

