



Mistover Road, Wareham BH20 4BY

£350,000

MOLLARO
DORSET & NEW FOREST ESTATE AGENTS





A well-proportioned two double bedroom semi-detached home, offering excellent scope for improvement and extension (subject to the necessary planning permissions), situated on a generous plot with a good-sized rear garden.

The property is accessed via a side entrance, leading into a welcoming hallway with stairs rising to the first floor and having a useful understairs storage cupboard. A door leads through to the kitchen, which is fitted with a range of base and eye level units, stainless steel sink and drainer as well as space for a cooker, fridge/freezer and washing machine. There is also a useful pantry cupboard housing the gas boiler.

From the kitchen, there is access to the spacious dual aspect living room, a bright, airy and well-proportioned room featuring a fireplace. Also leading from the kitchen is a useful utility room, offering additional storage, power points and access to the front garden.

To the first floor, the landing provides access to two well-proportioned double bedrooms and a shower room. The principal bedroom is a generous double aspect room with a feature fireplace, built-in storage cupboard and space for wardrobes. The second bedroom is overlooks the front garden and also benefits from a built-in storage cupboard. The shower room comprises a low-level WC, wash hand basin, spacious shower enclosure and an airing cupboard.

Externally, the rear garden extends to approximately 80 ft and offers a variety of areas, including ample space for a shed, summer house and two greenhouses. To the side of the property, there is potential to create off road parking or a driveway (subject to any necessary consents).

This property is offered to the market with no forward chain and represents an excellent opportunity for buyers looking to modernise.



KEY FEATURES

- Semi-Detached House
- Two Double Bedrooms
- Excellent Potential to Modernise & Extend (STPP)
- Spacious Dual Aspect Living Room
- Kitchen & Separate Utility Room
- First Floor Shower Room
- Generously Sized Rear Garden
- Gas Central Heating
- Potential to Create Driveway / Off Road Parking (STPP)
- No Forward Chain





ADDITIONAL INFORMATION

Tenure
Freehold

Council Tax
Band C - Dorset Council











FLOORPLAN

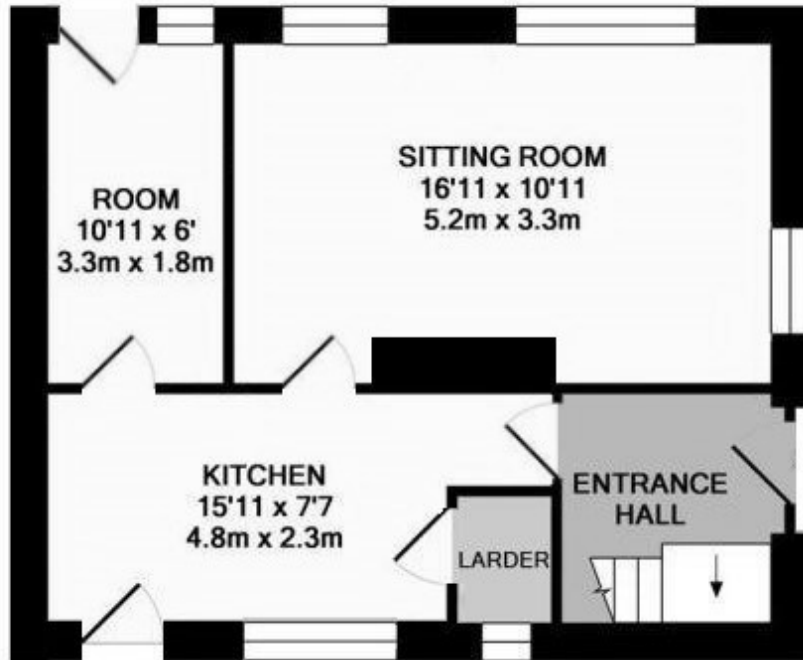

GROUND FLOOR

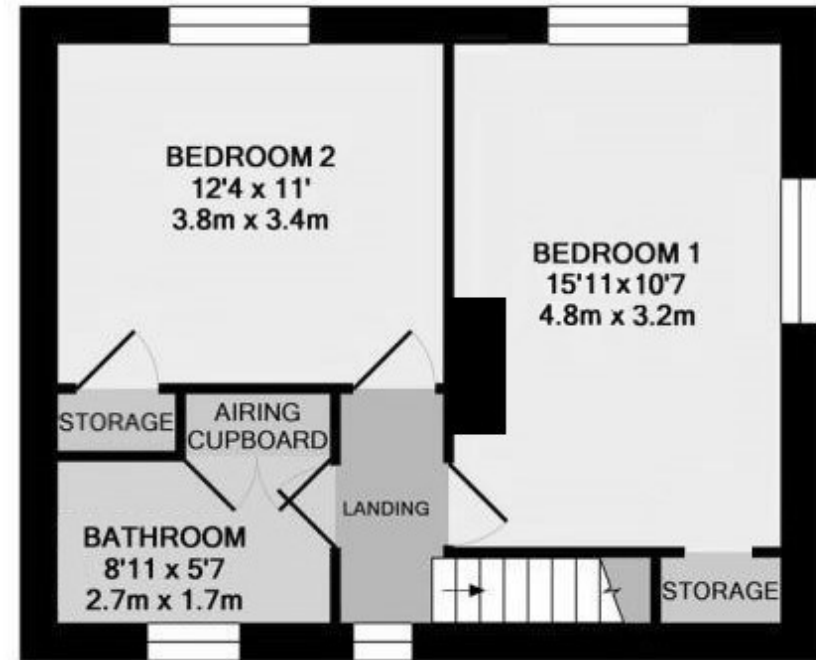

1ST FLOOR

This Floor Plan is for guidance only and is NOT to SCALE





Viewing by Appointment Through the Vendor's Sole Agent

01929 66 00 25 ■ hello@mollaro.com

Energy Efficiency Rating		Current	Potential
Very energy efficient - lower running costs			
(92-100) A			
(81-91) B			
(69-80) C			
(55-68) D			
(39-54) E			
(21-38) F			
(1-20) G			
Not energy efficient - higher running costs			
England, Scotland & Wales		EU Directive 2002/91/EC	

Mollaro Ltd, Registered in England & Wales Company No. 14891790. Registered Address: Briggs House, 26 Commercial Road, Ashley Cross, Poole BH14 0JR. PLEASE NOTE: Measurements quoted are approximate and for guidance only. Fixtures and fittings, services and appliances have not been tested and therefore no guarantee can be given that they are in working order. Images have been produced for information and it cannot be inferred that any items shown is included with the property. These particulars are believed to be correct but their accuracy is not guaranteed and they do not constitute an offer or form part of a contract. Solicitors are specifically requested to verify the sales particulars details in the pre contract enquiries in particular price, local and other services.