



Stowe Place, Rotten Row, Lichfield, WS13 6JE

£350,000

🛏️ 2 🚿 1 🚗 1



NO UPWARD CHAIN - Situated within a popular retirement development, Stowe Place presents a bright and south-facing two-bedroom apartment on the third floor, complete with convenient lift access.

Ideally positioned just moments from Lichfield's historic city centre, this development enjoys a highly convenient location with easy access to an excellent range of local amenities. The development sits opposite the beautiful Stowe Pool, offering scenic walks and peaceful green surroundings. A short stroll brings you to the city's shops, cafés, restaurants, and essential services, including doctor's surgeries and pharmacies. Lichfield City and Lichfield Trent Valley train stations are both within easy reach, providing direct links to Birmingham and London. With its central yet tranquil setting, this location offers the perfect blend of convenience, community, and natural beauty.

The accommodation is set across one floor and comprises a welcoming entrance hall, a spacious living room with space for a dining table and a south-facing Juliette balcony, and a modern fitted kitchen. There are two generous bedrooms, one featuring a walk-in wardrobe, along with a shower room and a separate guest WC. The development also boasts an on-site bistro and an owners' lounge where regular social activities take place, creating a warm and supportive community environment.

To fully appreciate the comfort, setting and lifestyle benefits of this superb apartment, we invite you to arrange a viewing.





- Two Bedroom South-Facing Apartment
- No Upward Chain
- Attractive South-Facing Living Room With Juliette Balcony
- On Site Bistro & Owners Lounge
- Set On The Third Floor With Lift Access
- Wet Room & Guest WC
- Manager On Site 24/7 With Tailored Support & Personal Care
- Pet Friendly
- EPC Rating: B
- Council Tax Band: C

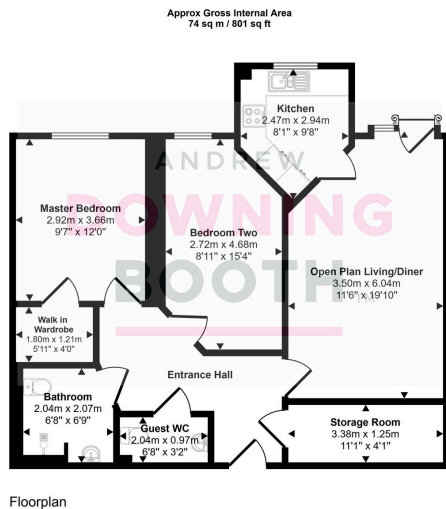

This floorplan is only for illustrative purposes and is not to scale. Measurements of rooms, doors, windows, and any items are approximate and no responsibility is taken for any error, omission or mis-statement. Icons of items such as bathroom suites are representations only and may not look like the real items. Made with Made Stuppy 360.

