



**HENDERSON  
CONNELLAN**

ESTATE AGENTS

## "Room To Grow"

Situated on an established road within walking distance to the town centre, this impressive semi-detached property offers room to grow with its exceptional garden size, three bedrooms, generous proportions throughout, a single garage and off-road parking!



Fairway  
Market Harborough  
LE16 7AF





Conveniently located within walking distance to the canal basin and the town centre offering a variety of independent local shops and restaurants.

Entrance through sliding uPVC front door leading into the porch with a door into the entrance hall. The entrance hall features access to the guest WC with stairs flowing up to the first-floor landing.

Spacious living room of a great size with a feature gas fireplace, a window overlooking the sizeable rear garden, and an opening through to the dining room.

Dining room comprising space for a four-seater table and chairs, and a door out to the rear garden.

Updated kitchen comprising laminate flooring, eye and base level shaker style fitted units, square edged work surfaces, a stainless-steel sink with drainage board, an integrated fridge/freezer, two Neff ovens, a two-ring gas hob, space for a washing machine and tumble dryer, two useful storage cupboards and a door out to the side elevation.

Guest WC with a white two-piece suite.

First floor landing with access to the attic via a hatch.

Three bedrooms, two of which benefit from being double in size with the third a spacious single. The main bedroom also benefits from fitted wardrobes and a view over the rear garden.

Shower room comprising vinyl flooring, a low-level WC, a pedestal wash hand basin and a double width shower enclosure with a fitted shower over.

The neat frontage is enclosed by a low-level brick wall with a well-maintained hedgerow, a lawn area and a block paved driveway providing off road parking for two to three cars. The southeast facing rear garden is a real sun trap and much longer than you might expect. A blocked paved patio leads from the rear doors offering the ideal space to sit out and entertain with friends and family. The lawn area flows through the garden, with a variety of planted borders, mature trees and evergreen plantings.



Ground Floor

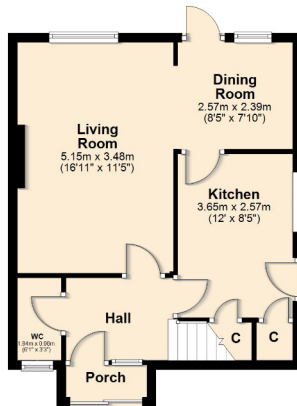
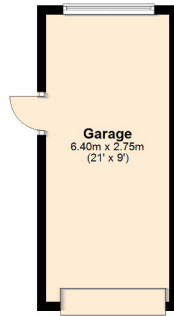

First Floor

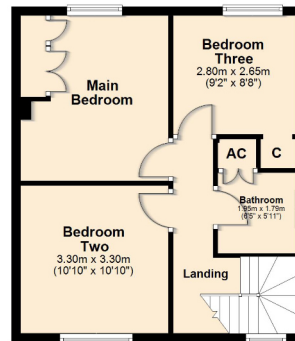

\*Although great care has been taken to create an accurate floorplan, it is for visual representation only and does not represent exact proportions.



Henderson Connellan, 63 High Street,  
Market Harborough, LE16 7AF

01858 410400  
marketharboroughsales@hendersonconnellan.  
co.uk



hendersonconnellanmh