



**Allan Morris**  
estate agents

 **MAYFAIR**  
OFFICE GROUP

18 Willowslea Road, Bevere, Worcester. WR3 7QP

£340,000

3 1 1



A well presented extended three bedroom semi detached family home, situated in the highly sought after Bevere area of Worcester.

Accommodation briefly comprises: Porch, Entrance Hall, Kitchen, Lounge and Dining Room. On the first floor: Three Bedrooms and Bathroom.

Outside: To the front is a private driveway and integral single Garage. To the rear is a fully enclosed private garden.

#### LOCATION:

The property is located in the popular Bevere area of Worcester, ideally placed for access back to Worcester City, as well as the close by countryside and motorway links. The area is particularly popular for the local schooling, which offers excellent Primary and Secondary options. The property is also located within a short walk of a bus stop, Fruit & Vegetable Shop, Convenience Store and and Public House.

**Kitchen** - 2.63m x 2.76m (8'7" x 9'0")

**Living Room** - 3.59m x 5.31m (11'9" x 17'5")

**Dining Room** - 2.72m x 2.25m (8'11" x 7'4")

**Bedroom 1** - 3.58m x 2.96m (11'8" x 9'8")

**Bedroom 2** - 3.59m x 3.18m (11'9" x 10'5")

**Bedroom 3** - 2.57m x 2.03m (8'5" x 6'7")

**Bathroom** - 1.63m x 2.25m (5'4" x 7'4")



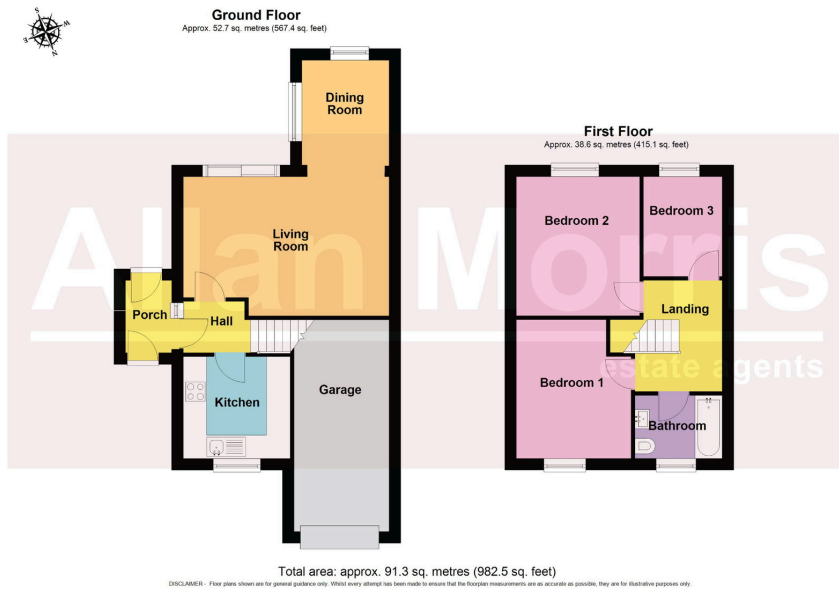

- Extended family home
- 2 Reception Rooms
- 3 Bedrooms
- Driveway & Garage
- Fully enclosed garden
- Popular school catchment
- Easy access to motorway links
- Council Tax Band: C

