



WAKEHAM STREET, LONDON, N1

1 BED APARTMENT

£415,000
LEASEHOLD

A well-presented and spaciouly arranged one-bedroom apartment extending to approximately 454 sq ft, ideally positioned on the second floor of a well-maintained building on Wakeham Street, N1.

The property is offered in good condition throughout and provides a bright and practical living environment, ideal for first-time buyers or investors. The accommodation comprises a light-filled reception room and fitted kitchen, a well-proportioned double bedroom, and a modern bathroom. Large windows allow for excellent natural light, enhancing the overall sense of space.

A key advantage of this property is the combination of a long lease and low service charge, making it a highly attractive and cost-efficient purchase in a prime central London location.

Hemmingfords

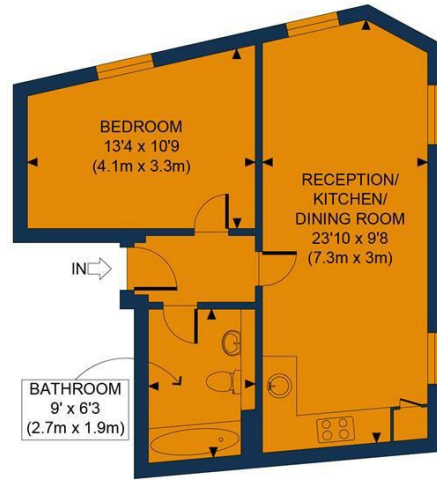

SECOND FLOOR
GROSS INTERNAL
FLOOR AREA 454 SQ FT

APPROX. GROSS INTERNAL FLOOR AREA 454 SQ FT / 42 SQM	Wakeham St
Disclaimer: Floor plan measurements are approximate and are for illustrative purposes only. While we do not doubt the floor plan accuracy and completeness, you or your advisors should conduct a careful, independent investigation of the property in respect of monetary valuation	date 27/03/26
	photoplan

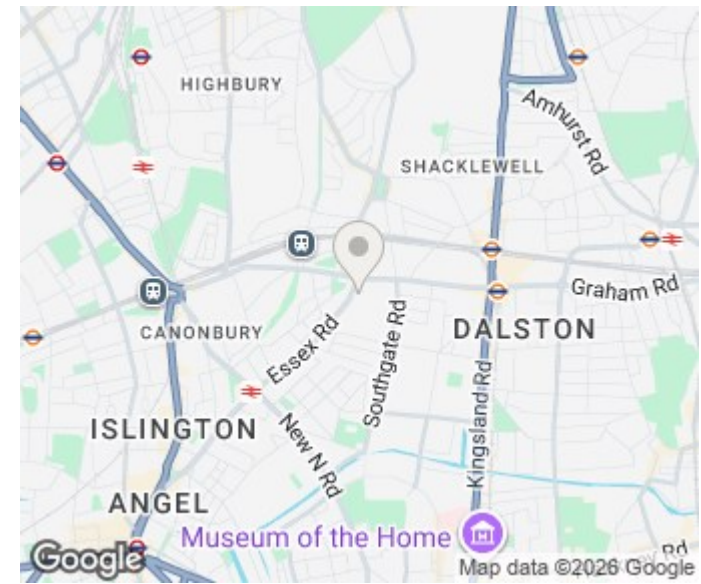

Energy Efficiency Rating		
	Current	Potential
Very energy efficient - lower running costs		
(92 plus) A		
(81-91) B		
(69-80) C		
(55-68) D		
(39-54) E		
(21-38) F		
(1-20) G		
Not energy efficient - higher running costs		
England & Wales	EU Directive 2002/91/EC	

Agents Note: Whilst every care has been taken to prepare these particulars, they are for guidance purposes only. All measurements are approximate and are for general guidance purposes only and whilst every care has been taken to ensure their accuracy, they should not be relied upon and potential buyers/tenants are advised to recheck the measurements

Hemmingfords Sales
34 Upper Street
London
N1 0PN

02038907470
info@hemmingfords.co.uk
www.hemmingfords.co.uk

Hemmingfords