



Connells

Pettingrew Close
Walnut Tree Milton Keynes

Pettingrew Close Walnut Tree Milton Keynes MK7 7LL

for sale fixed price
£265,000



Property Description

NO UPPER CHAIN

Inside, the home typically offers a comfortable living space, a well-proportioned kitchen and living area, two bright bedrooms, and a modern family bathroom—perfectly suited to practical day-to-day living. This property benefits from allocated parking and well-maintained gardens, adding further convenience.

Open Plan Living Area

Entrance door, stairs rising to first floor, laminate flooring, energy efficient High Heat Retention electric storage heaters, French doors to rear garden.

Kitchen

Wall and base units, electric hob with cooker hood over, space for fridge/freezer, plumbing for washing machine, tiled splashback, double glazed window to front aspect, laminate flooring.



Landing

Carpeted flooring, loft access.

Bedroom One

Carpeted flooring, wall mounted advanced eco design electric panel heater, two double glazed windows to the front aspect, built in cupboards.

Bedroom Two

Carpeted flooring, built in cupboards, wall mounted advanced eco design electric panel heater, double glazed window to rear aspect.

Family Bathroom

Three piece suite comprising of bath with electric shower over, low level WC, pedestal wash hand basin, tiled water sensitive areas and tiled flooring.

Outside Space

Front Garden

Rolled lawn area with paved path to front door.

Rear Garden

Mainly laid to rolled lawn, paved patio area, enclosed by timber fencing.

Parking

Allocated parking



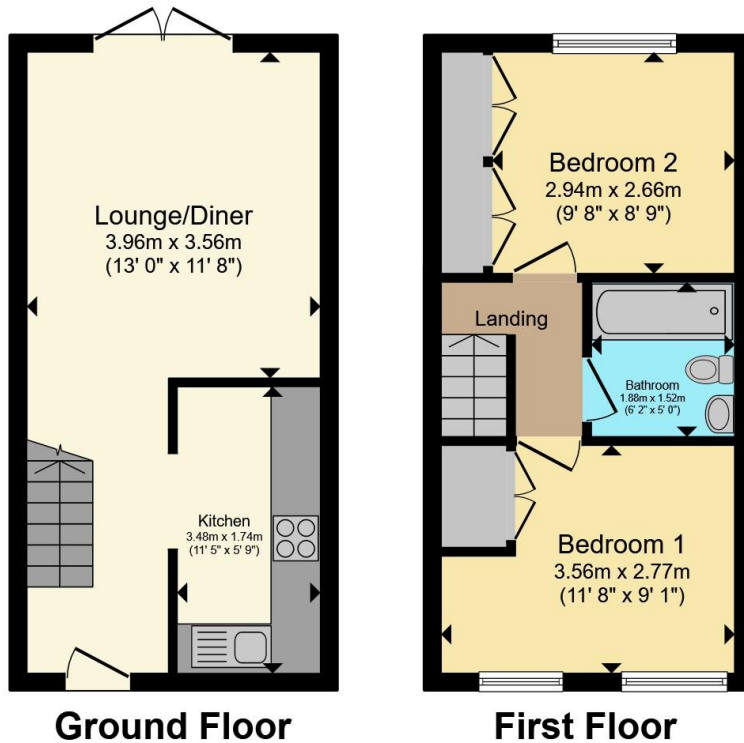

Total floor area 53.7 m² (578 sq.ft.) approx

This floor plan is for illustrative purposes only. It is not drawn to scale. Any measurements, floor areas (including any total floor area), openings and orientation are approximate. No details are guaranteed, they cannot be relied upon for any purpose and they do not form part of any agreement. No liability is taken for any error, omission or misstatement. A party must rely upon its own inspection(s). Powered by www.propertybox.io

Connells



To view this property please contact Connells on

T 01908 691606

E walnuttree@connells.co.uk

26A Fyfield Barrow The Walnut Tree Local Centre Walnut Tree

EPC Rating: D Council Tax Band: B

view this property online connells.co.uk/Property/WNT308125

Tenure: Freehold



1. MONEY LAUNDERING REGULATIONS Intending purchasers will be asked to produce identification documentation at a later stage and we would ask for your co-operation in order that there will be no delay in agreeing the sale. 2. These particulars do not constitute part or all of an offer or contract. 3. The measurements indicated are supplied for guidance only and as such must be considered incorrect. Potential buyers are advised to recheck measurements before committing to any expense. 4. We have not tested any apparatus, equipment, fixtures, fittings or services and it is in the buyers interest to check the working condition of any appliances.

Connells Residential is registered in England and Wales under company number 1489613, Registered Office is Cumbria House, 16-20 Hockliffe Street, Leighton Buzzard, Bedfordshire, LU7 1GN. VAT Registration Number is 500 2481 05.

See all our properties at www.connells.co.uk | www.rightmove.co.uk | www.zoopla.co.uk

Property Ref: WNT308125 - 0007