



Manchester Road

Guide Price £850,000

🛏 5 🍽 2 🛋 2

- DETACHED PROPERTY
- OFF ROAD PARKING
- DEVELOPMENT POTENTIAL
- SOUGHT AFTER LOCATION
- CLOSE TO LOCAL AMENITIES
- FIVE BEDROOMS
- STUNNING VIEWS
- GOOD SCHOOLS CATCHMENT AREA
- LARGE REAR GARDEN
- GOOD COMMUTER LINKS



Den Bank House is a substantial and characterful five double bedroom detached family home, positioned on the edge of Sheffield's rural boundary while remaining conveniently close to local amenities.



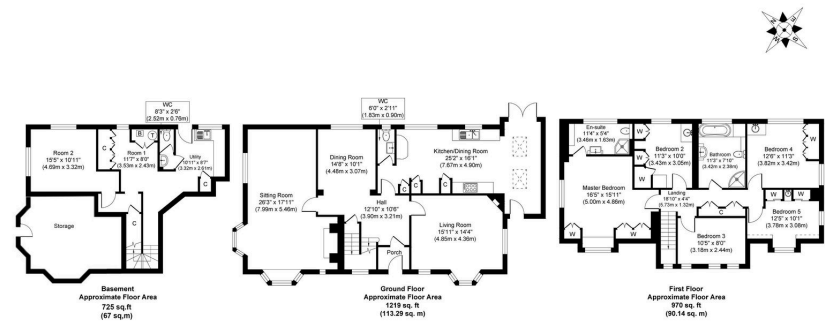

Approx. Gross Internal Floor Area 2914 sq. ft / 270.43 sq. m

Whilst every attempt has been made to ensure the accuracy of the floor plan contained here, measurements of doors, windows, rooms and any other items are approximate and no responsibility is taken for any error, omission, or mis-statement. The measurements should not be relied upon for valuation, transaction and/or funding purposes. This plan is for illustrative purposes only and should be used as such by any prospective purchaser or tenant. The services, systems and appliances shown have not been tested and no guarantee as to their operability or efficiency can be given.

Copyright Photoneg

