



Eyre Court

3-21 Finchley Road, NW8

Asking Price £880,000

Sole Agent. A bright and spacious two-bedroom apartment extending to approximately 900 sq. ft, situated on the first floor of this prestigious mansion block, ideally located in the heart of St John's Wood.

The property comprises two well-proportioned bedrooms, including a principal bedroom with fully fitted wardrobes, a modern bathroom, and a large welcoming entrance hall. Stylish wood flooring runs throughout, leading to a generous reception/dining room ideal for entertaining, alongside a fully fitted contemporary kitchen.

Residents benefit from 24-hour portering, lift access, beautifully maintained communal gardens and parking on a first come first served basis.

Eyre Court is superbly positioned directly opposite St John's Wood Underground Station (Jubilee Line), within easy reach of St John's Wood High Street and its array of boutique shops and cafés. The apartment is also conveniently located close to Lord's Cricket Ground, the London School of Economics, and a variety of bus routes providing excellent transport links across London.

CHESTERTONS



Eyre Court

3-21 Finchley Road, NW8

- 2 Bedroom Apartment
- 971 Year Leasehold
- 900 sq. ft.
- Double Reception Room
- Porter
- Lift
- Opposite Tube & Bus Routes



Tenure: Leasehold
Service Charge: £10,755pa Includes CH & HW.
Ground Rent: £0
Local Authority: Westminster
Council Tax Band: G

Score	Energy rating	Current	Potential
92+	A		
81-91	B		
69-80	C	73 C	81 B
55-68	D		
39-54	E		
21-38	F		
1-20	G		

Chestertons St John's Wood Sales

105 St. John's Wood Terrace
London
NW8 6PL
stjohnswood@chestertons.co.uk
020 3040 8611
chestertons.co.uk

Eyre Court,
Finchley Road,
St John's Wood, NW8



○ - Ceiling Height

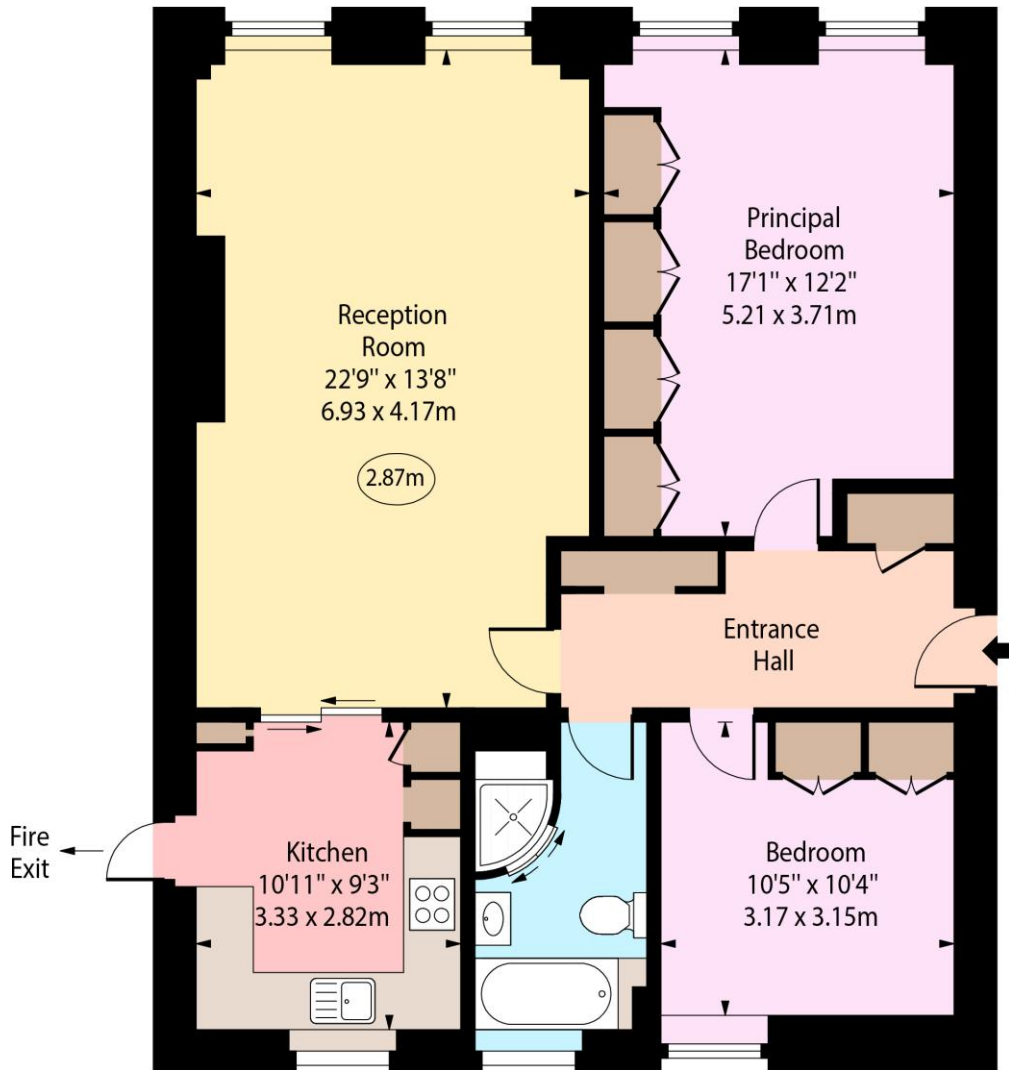

First Floor

Approx Gross Internal Area 900 Sq Ft - 83.61 Sq M

Every attempt has been made to ensure the accuracy of the floor plan shown. However, all measurements, fixtures, fittings, and data shown are approximate interpretations and for illustrative purposes only. Measured according to the RICS. Not To Scale.

www.goldlens.co.uk
Produced for Chestertons
Ref. No. 030734K