



6 Earls Close

, Liverpool, L23 3BU

Offers in excess of £350,000



Set within a quiet and sought-after cul-de-sac in the heart of Crosby, this beautifully presented home offers the perfect blend of modern living and family-friendly convenience. Ideally positioned close to the village amenities, highly regarded schools, and excellent transport links, it is perfectly suited to a range of buyers, particularly families.

The property is bright, stylish, and thoughtfully updated throughout. A newly landscaped driveway provides an attractive approach, leading into a welcoming entrance hallway. To the front, a charming bay-fronted lounge flows seamlessly into a spacious through dining room, creating an ideal setting for both everyday living and entertaining.

At the rear, a sleek and contemporary breakfast kitchen has been recently fitted, boasting integrated appliances and a clean, modern finish. This space enjoys direct access to the south-facing rear garden, allowing natural light to flood in.

To the first floor, there are three well-proportioned bedrooms and a modern family bathroom, complete with a freestanding bath, offering a touch of luxury.



Area Map

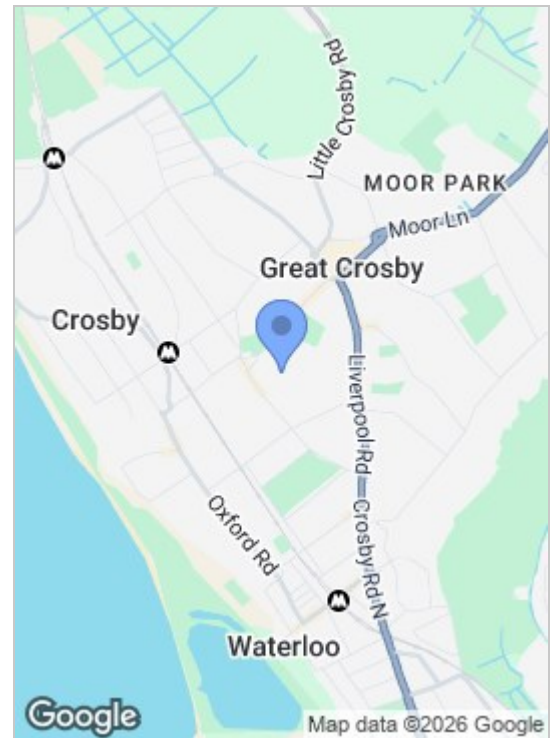

Floor Plans

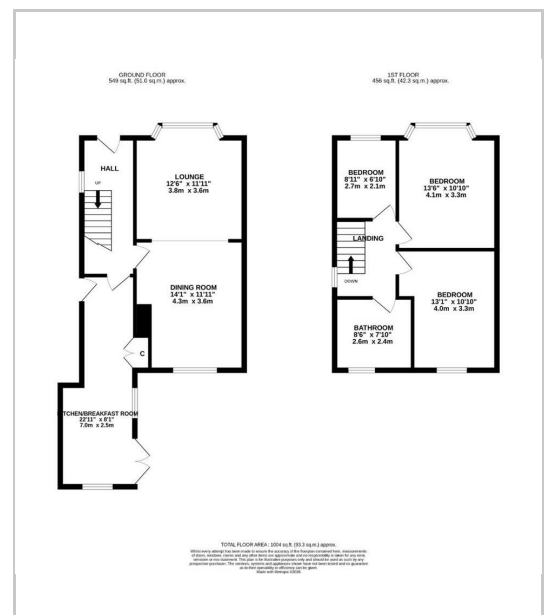

Energy Efficiency Graph

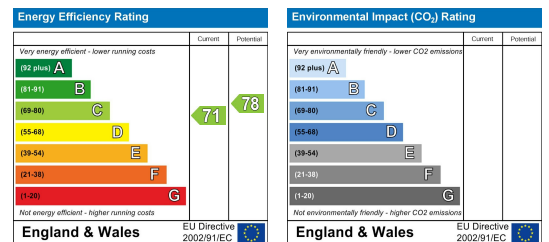

These particulars, whilst believed to be accurate are set out as a general outline only for guidance and do not constitute any part of an offer or contract. Intending purchasers should not rely on them as statements of representation of fact, but must satisfy themselves by inspection or otherwise as to their accuracy. No person in this firm's employment has the authority to make or give any representation or warranty in respect of the property.

82 Coronation Road, Crosby, Liverpool L23 5RH

6 Allerton Road, Mossley Hill, Liverpool, L18 1LN

2 Chapel Lane, Formby, Liverpool, L37 4DU

Tel: 0151 909 3003

Email: crosby@abode.group.co.uk

Web: www.abode-group.co.uk

Tel: 0151 601 3003

Email: allerton@abode-group.co.uk

Web: www.abode-group.co.uk

Tel: 01704 827 402

Email: formby@abode-group.co.uk

Web: www.abode-group.co.uk