



Flat 15, Church View, Church Walk

Offers Over £60,000

 **NEWTON FALLOWELL**

## Flat 15

Church View, Bourne

\*\*\* NO ONWARD CHAIN \*\*\*

This ground-floor studio apartment is ideally positioned in the heart of Bourne, placing a wide range of local amenities right on your doorstep. Offering convenient, single-level living, the property features a bright open-plan living/bedroom area, a fitted kitchen, and a three-piece bathroom.

A communal entrance leads to the front of the building where the apartment is located. Inside, a central hallway provides access to the bathroom and main living space. The bathroom is partly tiled in white and includes a bath with overhead shower. The spacious living/bedroom area benefits from generous natural light, and the adjoining kitchen offers a good selection of units for storage and preparation.

Externally, the property includes dedicated off-road parking to the front.

Council Tax band: A

Tenure: Leasehold

EPC Energy Efficiency Rating: D

EPC Environmental Impact Rating: D

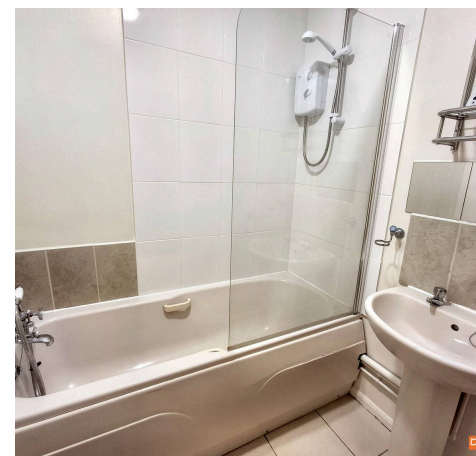



Entrance Hall

Studio

14' 2" x 9' 4" (4.33m x 2.85m)

Kitchen

8' 6" x 5' 3" (2.59m x 1.59m)

Bathroom

6' 3" x 5' 4" (1.91m x 1.63m)



Approx Gross Internal Area  
24 sq m / 262 sq ft

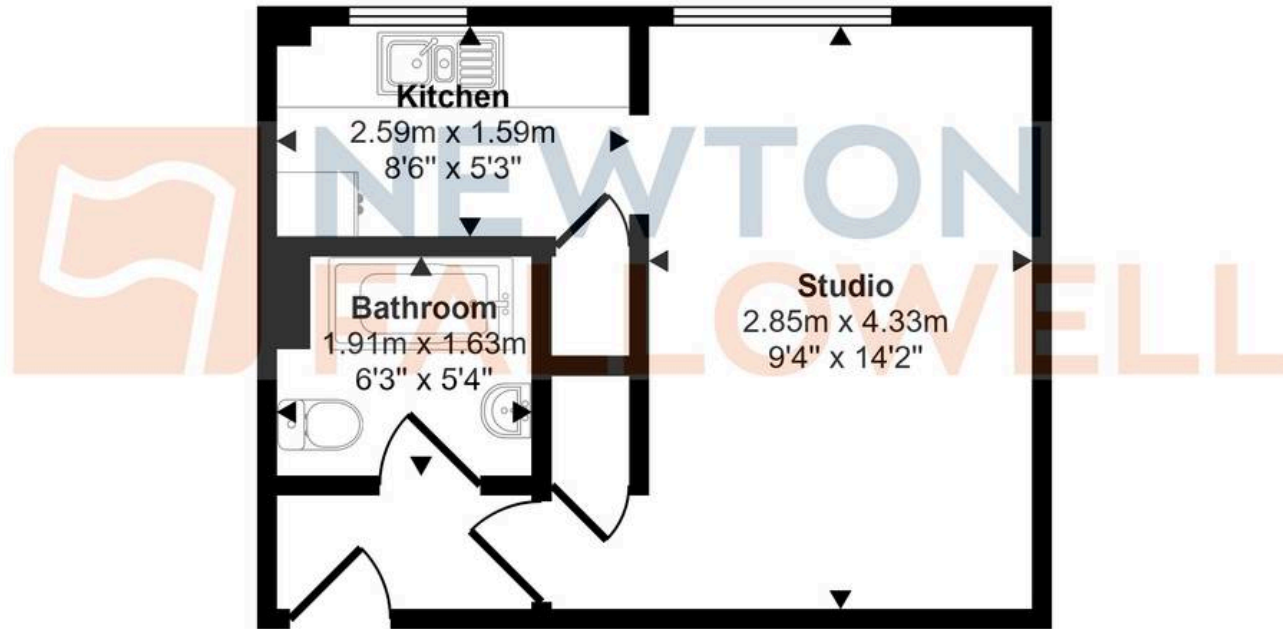

Studio

This floorplan is only for illustrative purposes and is not to scale. Measurements of rooms, doors, windows, and any items are approximate and no responsibility is taken for any error, omission or mis-statement. Icons of items such as bathroom suites are representations only and may not look like the real items. Made with Made Snappy 360.

Newton Fallowell - Bourne

Newton Fallowell, 2 North Street - PE10 9EA

01778 422567 · [bourne@newtonfallowell.co.uk](mailto:bourne@newtonfallowell.co.uk) · [newtonfallowell.co.uk/bourne](http://newtonfallowell.co.uk/bourne)