



Shelton Court, Covent Garden, WC2H
£650 pw

> 2 Bedrooms > 2 Bathroom > Unfurnished

TAVISTOCKBOW
RESIDENTIAL



- › Two bedrooms
- › Two shower rooms
- › Fourth floor (with lift)
- › Wooden floors
- › Open plan
- › Unfurnished
- › Professionally managed
- › Quiet location
- › Short walk to Leicester Square and Covent Garden tube
- › Available early August

A well presented two bedroom one bathroom apartment to rent in Covent Garden. The apartment has a modern finish throughout, featuring two double bedrooms, two shower rooms (one en-suite) and a well proportioned open plan living space. Situated on the fourth floor the apartment is very quiet and located in the heart of

Covent Garden. The property is available early August on an unfurnished basis 3 year contract with a 6 months mutual break clause.

Council tax band E.





WHAT WE LOVE

- Wooden floors throughout
- Modern finish throughout
- Quiet location
- Plenty of built in storage
- Short walk to Seven dials market.

WHAT YOU NEED TO KNOW

- Fourth floor (with lift)
- Professionally managed
- Open plan living space
- Secondary glazing
- Available early August.



Floorplan

Wellington Court, WC2

Approximate Gross Internal Area 58 sq m / 624 sq ft

Fourth Floor

- 1 Kitchen / Reception Room
5.29 x 4.20M
17'4" x 13'9"
- 2 Bedroom
3.84 x 3.57M
12'7" x 11'9"
- 3 Bedroom
3.79 x 3.15M
12'5" x 10'4"

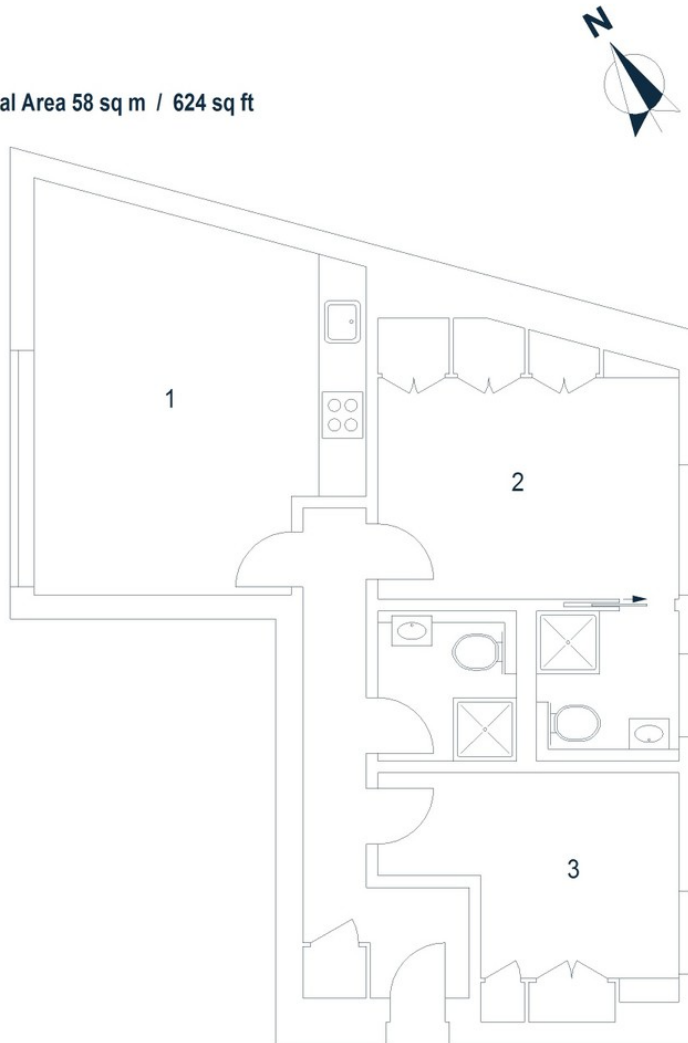

Floor Plan produced for Tavistock Bow by Mays Floorplans © . Tel 020 3397 4594
Illustration for identification purposes only, not to scale.

EPC

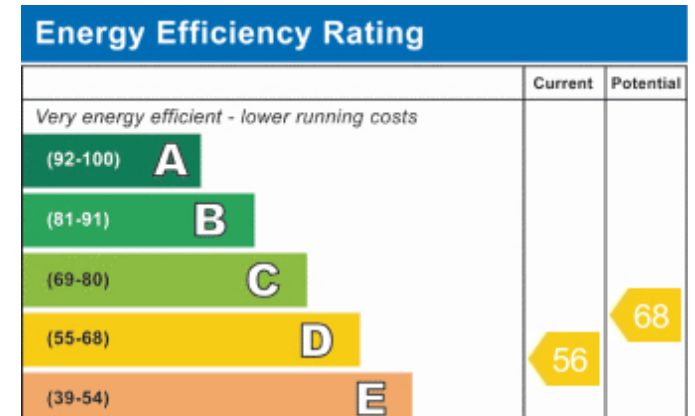

About Us

Tavistock Bow is an independent residential agency based in Covent Garden. We are niche, boutique, creative, knowledgeable, professional and approachable. We love what we do and that's why we do it.

Contact Us

- a. 21 New Row, Covent Garden, WC2N 4LE
- t. 020 7477 2177
- w. hello@tavistockbow.com
tavistockbow.com

- f /tavistockbow
- ig /tavistockbow
- tw @tavistockbow

