



Holland Road, W14

£600,000

This well-presented two-bedroom property features a spacious open-plan reception and kitchen area leading onto a private garden, along with two double bedrooms and two bathrooms.

Holland Road is well positioned within the Royal Borough and close to the transport and shopping facilities of Holland Park, Westfield and High Street Kensington.

Features

Offers In Excess Of
Two Bedrooms
Two Bathrooms
Private Garden
Private Entrance
Approx 908sqft

Holland Road, London, W14

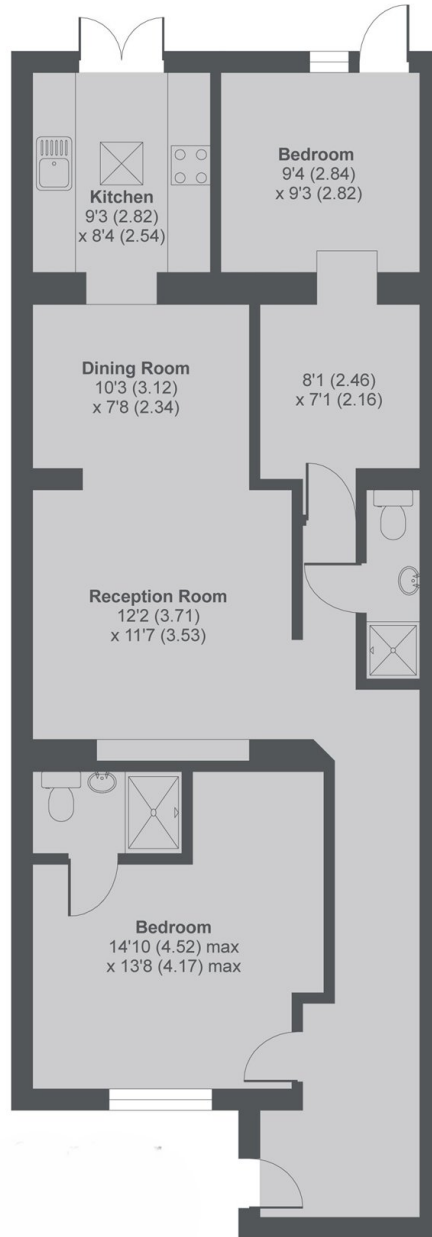

Holland Road, W14

MAIN HOUSE APPROX FLOOR AREA 908 SQ.FT 84.3 SQ.M

Copyright nichecom.co.uk 2017 Produced for Dexters REF : 193619

Dexters

Shepherds Bush and Brook Green
53 Shepherds Bush Green
London
W12 8PS
Sales
020 8740 2900

Energy Rating: C. We aim to make our particulars both accurate and reliable. However they are not guaranteed; nor do they form part of an offer or contract. If you require clarification on any points then please contact us, especially if you're traveling some distance to view. Please note that appliances and heating systems have not been tested and therefore no warranties can be given as to their good working order.

 **RICS** | Regulated
Estate Agent
and Letting Agent

dexters.co.uk