



Mid-Terrace Home

CHECK OUT this FAMILY HOME. Mid-terrace in popular location, close to new Town Centre, Shops, Supermarket, Pub, Schools, transport, Country Park & M5/A30. Spacious home with Living Room, Kitchen Dining Room, lovely Garden, 3 Bedrooms, Bathroom & Ensuite, Off Road Parking. Well worth a look!

33 Yarlinton Mill | Exeter | EX5 7FJ



thoroughly good property agents



PROPERTY TYPE

Mid Terraced House



SIZE

741 sq ft



LOCATION

Town



AGE

Modern



BEDROOMS

3



RECEPTION ROOMS

1



BATHROOMS

2



WARMTH

District Heating System



PARKING

Off Road Parking



OUTSIDE SPACE

Garden



EPC RATING

72C



COUNCIL TAX BAND

C



in a nutshell...

- Popular central location
- Close to new Town Centre & Shops
- 3 Bedrooms
- Living Room & Kitchen Diner
- Bathroom & Ensuite
- Off Road Parking
- Easy access to M5 and A30
- Great Transport Links
- IDEAL FIRST HOME





the details...

This three-bedroom home, new to the market, offers comfortable and practical living in a desirable residential area close to the country park and nearby town centre. With allocated parking, a generous south facing garden, and well proportioned living spaces, the property is ideal for families, professionals, or anyone looking for a modern and low maintenance home.

Upon entering through the front door, you are welcomed by a bright entrance hall, with a convenient downstairs WC located on the left hand side. Moving through the hallway leads into a well sized living room, providing a comfortable space to relax. An under stairs cupboard offers useful additional storage.

From the living room, you enter the kitchen diner, a practical and sociable space with room for a dining table. The kitchen provides space for a washing machine, dishwasher, and fridge freezer, and is already fitted with an oven, hob, and cooker hood. The ground floor benefits from low maintenance hard flooring throughout, making it both practical and easy to care for.

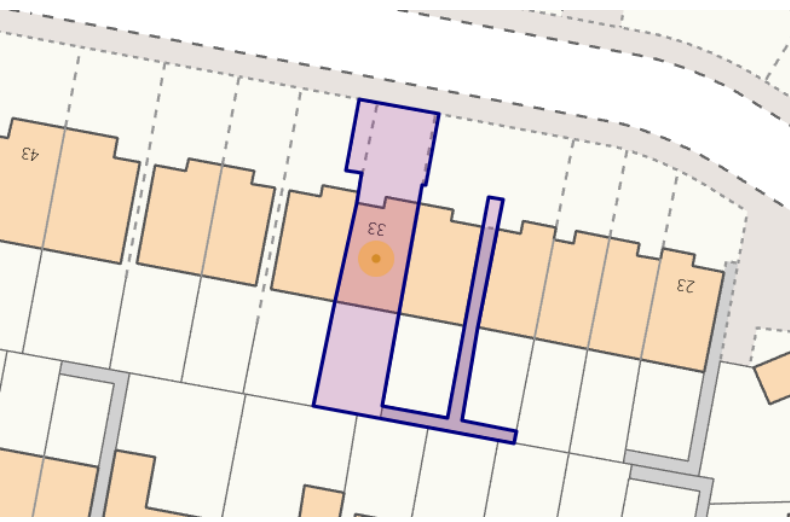

the floorplan...

Approximate Gross Internal Area 741 sq ft - 69 sq m

Ground Floor Area 379 sq ft – 35 sq m

First Floor Area 362 sq ft – 34 sq m

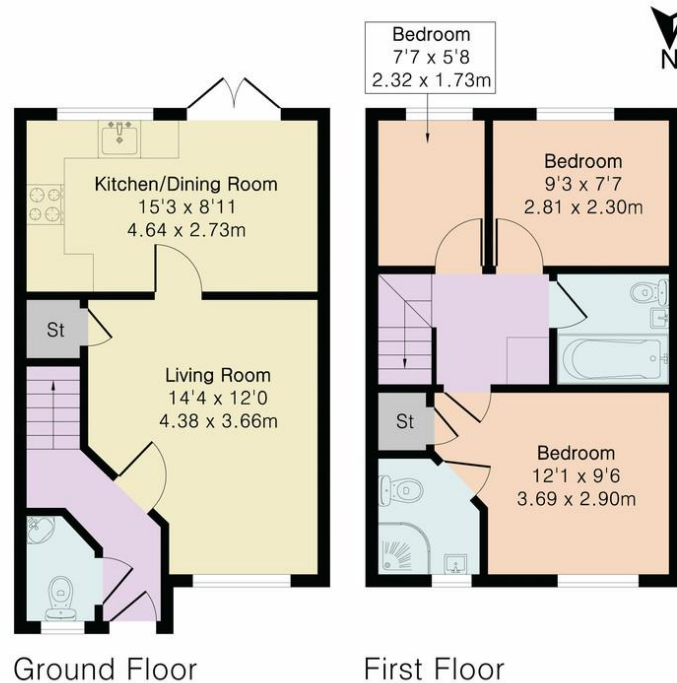

Floor plan produced in accordance with RICS Property Measurement 2nd Edition. Although Pink Plan Ltd ensures the highest level of accuracy, measurements of doors, windows and rooms are approximate and no responsibility is taken for error, omission or misstatement. These plans are for representation purposes only and no guarantee is given on the total square footage of the property within this plan. The figure icon is for initial guidance only and should not be relied on as a basis of valuation.



Our note. For clarification we have prepared these sales particulars as a general guide and have not carried out a detailed survey nor tested the services, appliances or fittings. Room sizes should not be relied upon for carpets or furnishings. If there are any important matters which are likely to affect your decision to buy, please contact us before viewing this property. These particulars, whilst believed to be accurate, are set out as a general outline only for guidance and do not constitute any part of an offer or contract. Intending purchasers should not rely on them as statements of representation of fact, but must satisfy themselves by inspection or otherwise as to their accuracy. No person in the employment of Complete Property Services has the authority to make or give any representation or warranty in respect of the property.

SKETCH PLAN FOR ILLUSTRATIVE PURPOSES ONLY. All measurements and sizes and locations of walls, doors, window fittings and appliances are shown conventionally and are approximate only and cannot be regarded as being a representation either by the Seller or his Agent. We hope that these plans will assist you by providing you with a general impression of the layout of the accommodation. The plans are not to scale nor accurate in detail. © Unauthorised reproduction prohibited.

As part of the service we offer we may recommend ancillary services to you which we believe will help with your property transaction. We wish to make you aware that should you decide to proceed we will receive a referral fee. This could be a fee, commission, payment or other reward. We will not refer your details unless you have provided consent for us to do so. You are not under any obligation to provide us with your consent or to use any of these services, but where you do you should be aware of the following referral fee information. You are also free to choose an alternative provider. To find out more about this, please speak to a member of the team.



the details...

Upstairs, the stairs and bedrooms are fully carpeted, creating a warm and comfortable feel. Bedrooms one and two are spacious doubles, while bedroom three is a single room that could also work perfectly as a home office or walk-in wardrobe. The main bedroom also benefits from its own en-suite shower room. A family bathroom with a shower facility serves the remaining bedrooms, and additional storage can be found on the landing.

Outside, the property boasts a great sized south-facing garden designed for low maintenance, featuring a near 50/50 split of decking and artificial grass ideal for relaxing, entertaining, or enjoying sunny days with minimal upkeep.

This attractive home combines practical living space with a desirable outdoor area and convenient parking, making it a fantastic opportunity for buyers seeking a well balanced property.

Tenure: Freehold
Council Tax Band C





Need a more complete picture? Get in touch with your local branch...

Tel [01392 422500](tel:01392422500)
Email exeter@completeproperty.co.uk
Web completeproperty.co.uk

Complete
141 Younghayes Rd
Cranbrook
EX5 7DR

Are you selling a property too? Call us to get a set of property details like these...

selling

letting

land &
new homes

signature
homes

complete.