



**Connells**

Mildenhall Road  
Birmingham



## Property Description

Situated on the sought-after Mildenhall Road in the B42 area of Birmingham, this beautifully presented three-bedroom semi-detached home offers modern living throughout and is ideal for families or first-time buyers.

The ground floor features a welcoming entrance porch leading into a central hallway, giving access to a spacious lounge with a bay window, perfect for relaxing or entertaining. To the rear, you'll find a stunning, recently fitted modern kitchen/diner complete with integrated appliances, offering a stylish and functional space with direct access to the garden. A convenient downstairs WC adds to the practicality of the home.

Upstairs, the property boasts three well-proportioned bedrooms and a contemporary family bathroom, all arranged off a central landing.

Externally, the property benefits from a driveway to the front providing off-road parking, along with a private rear garden. To the rear, there is also gated access offering additional secure parking - a rare and valuable feature.

Finished to a high standard throughout, this modern and well-maintained home is ready to move into and enjoy.

## Lounge

12' 8" x 10' 8" ( 3.86m x 3.25m )

## Kitchen/Diner

16' 9" x 13' ( 5.11m x 3.96m )

## Bedroom 1

13' 2" x 10' 4" ( 4.01m x 3.15m )

## Bedroom 2

12' 8" x 10' 7" ( 3.86m x 3.23m )

## Bedroom 3

7' 3" x 6' 3" ( 2.21m x 1.91m )

## Bathroom

7' 3" x 6' 8" ( 2.21m x 2.03m )







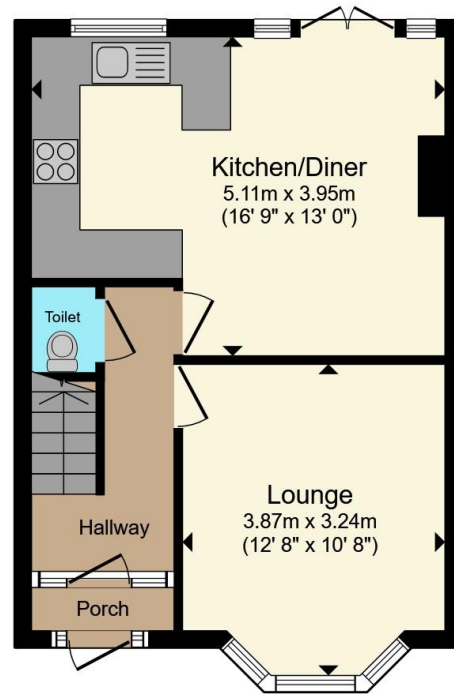

**Ground Floor**

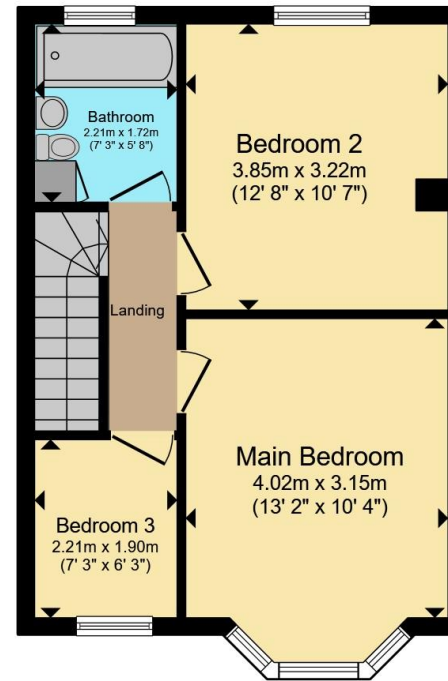

**First Floor**

Total floor area 77.0 m<sup>2</sup> (828 sq.ft.) approx

This floor plan is for illustrative purposes only. It is not drawn to scale. Any measurements, floor areas (including any total floor area), openings and orientation are approximate. No details are guaranteed, they cannot be relied upon for any purpose and they do not form part of any agreement. No liability is taken for any error, omission or misstatement. A party must rely upon its own inspection(s). Powered by [www.propertybox.io](http://www.propertybox.io)



To view this property please contact Connells on

**T 0121 357 6877**  
**E [greatbarr@connells.co.uk](mailto:greatbarr@connells.co.uk)**

907 Walsall Road Great Barr  
BIRMINGHAM B42 1TN

EPC Rating: Council Tax  
Awaited Band: B

**view this property online [connells.co.uk/Property/GBR312770](http://connells.co.uk/Property/GBR312770)**

Tenure: Freehold



1. MONEY LAUNDERING REGULATIONS Intending purchasers will be asked to produce identification documentation at a later stage and we would ask for your co-operation in order that there will be no delay in agreeing the sale. 2. These particulars do not constitute part or all of an offer or contract. 3. The measurements indicated are supplied for guidance only and as such must be considered incorrect. Potential buyers are advised to recheck measurements before committing to any expense. 4. We have not tested any apparatus, equipment, fixtures, fittings or services and it is in the buyers interest to check the working condition of any appliances.

Connells Residential is registered in England and Wales under company number 1489613, Registered Office is Cumbria House, 16-20 Hockliffe Street, Leighton Buzzard, Bedfordshire, LU7 1GN. VAT Registration Number is 500 2481 05.

**See all our properties at [www.connells.co.uk](http://www.connells.co.uk) | [www.rightmove.co.uk](http://www.rightmove.co.uk) | [www.zoopla.co.uk](http://www.zoopla.co.uk)**

Property Ref: GBR312770 - 0006