



Blackgate House Scotland Road
Dry Drayton, CB23 8BX

Guide price £975,000



Blackgate House Scotland Road

Dry Drayton, CB23 8BX

- Catchment for Comberton Village College
- 4 bedrooms and 4 receptions
- 2 studies/home offices
- Gardens approaching 1/3rd of an acre
- No chain
- EPC rating C
- Solar panels and feed-in tariff generating £2800 p.a

A wonderful family home of almost 2400 sq. ft, offering spacious, versatile accommodation, a double garage, and grounds of almost 1/3rd of an acre. All situated in a fabulous elevated location with fantastic views, just 4 miles from Cambridge

This four-bedroom family house has been extended to provide flexible, stylish spaces that comprise, on the ground floor, a large, vaulted entrance hall, double doors lead to the family room, which has a useful boot room. The sitting room and dining room overlook the rear garden. The sitting room has a lovely open fireplace and a door to the terrace. The kitchen/breakfast room has been refitted and has extensive cupboards, solid worktops and various built-in appliances. Unusually, there are two studies/home offices, making the house perfect for those who work from home or need separate spaces for children. A morning room adjoins the kitchen and hallway. There is a good-sized utility room and a cloakroom with a WC. Access from the utility room via





an enclosed passageway leads to the gardens and double garage.

Upstairs, the accommodation is particularly well-fitted throughout, with four double bedrooms, two of which have newly fitted en-suite shower rooms, and the family bathroom is also new.

In addition to the new kitchen and bathrooms, the house also has a burglar alarm, new high-quality double glazing, gas central heating, solar panels, and an EV charger.

Outside, the house is set well back from the road in an elevated position, but beautifully screened to provide privacy. There is extensive parking at the front and access to the large double garage, which has power, water, heating, and a permanent staircase to the loft storage room. The gardens extend to the side and rear and are somewhat larger than they perhaps appear. They are wonderfully mature, with well-stocked borders and beds, a large paved terrace and a pond. Beyond the main lawn is a further "secret" garden where there is a shallow wildlife pond under the trees.

There is a summerhouse and two sheds, and the whole enjoys a westerly orientation.

Agents note: There are solar panels with a feed-in tariff of 0.70p per unit. Currently, the owners receive approximately £2800.00 p.a. The tariff runs for about another 10 years. The plan showing the outline of the boundary is approximate and for identification only.



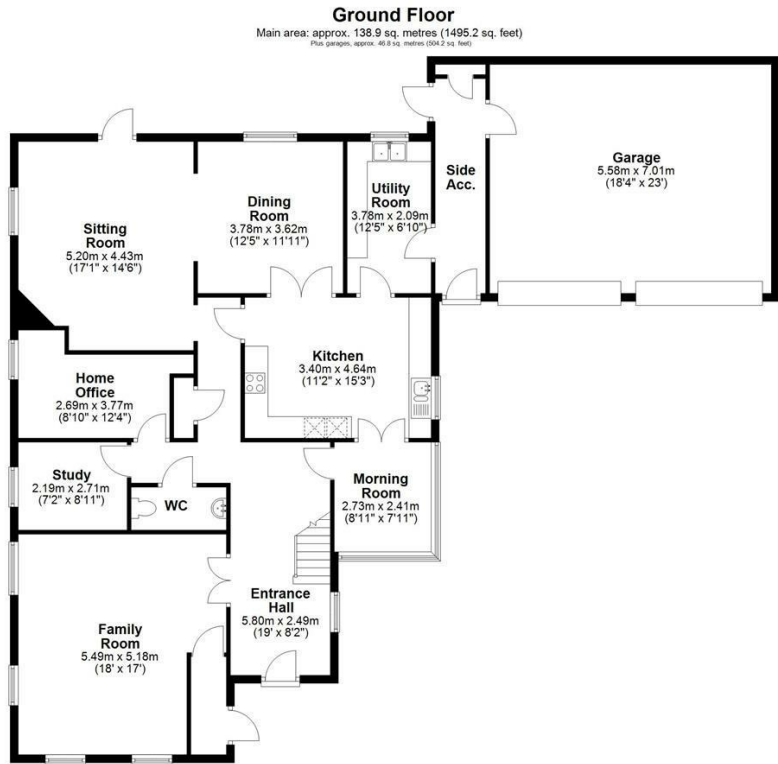

Main area: Approx. 221.1 sq. metres (2380.3 sq. feet)
Plus garages, approx. 46.8 sq. metres (504.2 sq. feet)

Drawings are for guidance only
Plan produced using PlanUp.



Energy Efficiency Graph

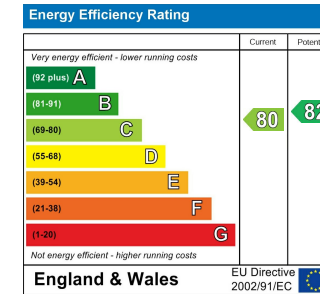

Tenure: Freehold
Council tax band: E

These particulars, whilst believed to be accurate, are set out as a general outline only for guidance and do not constitute any part of an offer or contract. Intending purchasers should not rely on them as statements of representation of fact, but must satisfy themselves by inspection or otherwise as to their accuracy. No person in this firm's employment has the authority to make or give any representation or warranty in respect of the property.

Cambridge Victoria
154-156 Victoria Road, Cambridge CB4 3DZ
01223 439 888 theteam@grayandtoynbee.com

Cambridge South
Adkins Corner, Perne Road, Cambridge CB1 3RU
01223 439 555 theteam@grayandtoynbee.com

Waterbeach
17 High Street, Waterbeach, CB25 9JU
01223 949 444 waterbeach@grayandtoynbee.com