



29 Harvey Road Willesborough, TN24 0AG

Price £435,000

A fantastic detached bungalow in a much favoured residential location within easy reach of local schools, shops and transport links.

Occupying a corner plot, the very well presented accommodation comprises an entrance hall, sitting room, conservatory, modern fitted kitchen and shower room, three bedrooms.

The property is offered for sale with no onward chain and includes gas central heating, double glazing and a detached garage & driveway.

- VERY WELL PRESENTED DETACHED BUNGALOW
- THREE BEDROOMS
- MODERN FITTED KITCHEN
- RECENTLY INSTALLED SHOWER ROOM
- CONSERVATORY
- DETACHED GARAGE & DRIVEWAY
- CORNER PLOT POSITION
- GAS CENTRAL HEATING & DOUBLE GLAZING
- CLOSE TO AMENITIES
- NO ONWARD CHAIN

Viewing

Please contact our Ashford Office on 01233 646411 if you wish to arrange a viewing appointment for this property or require further information.



Floor Plan

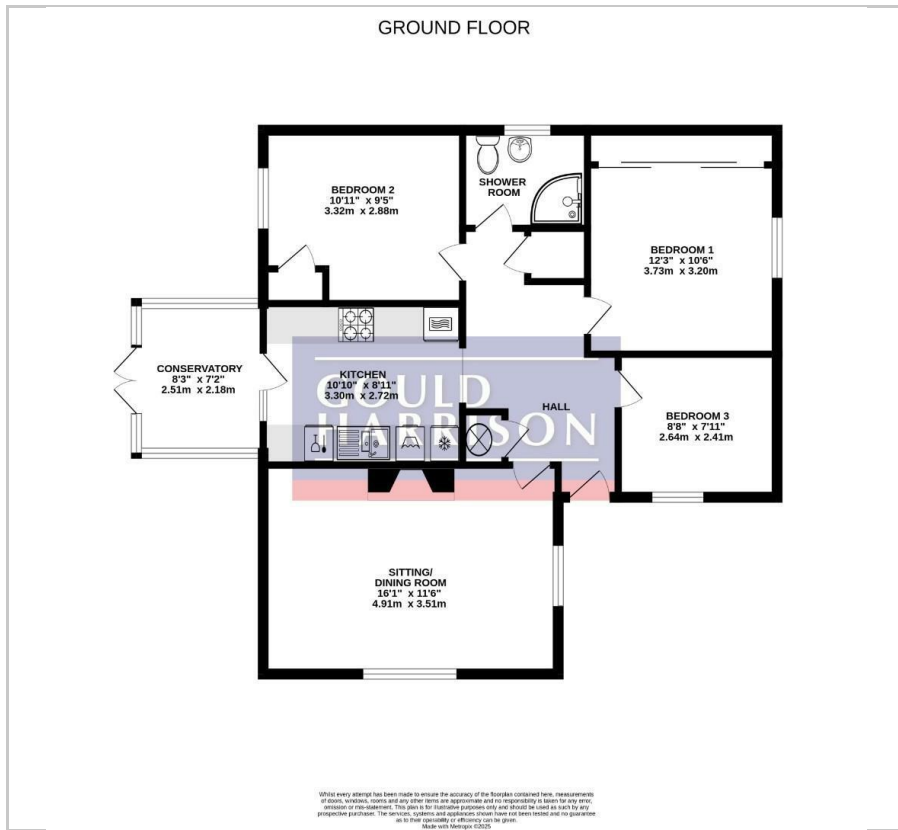

Area Map



Energy Efficiency Graph

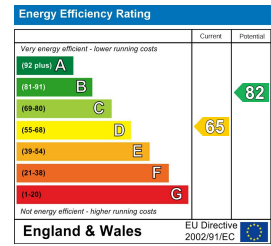

These particulars, whilst believed to be accurate are set out as a general outline only for guidance and do not constitute any part of an offer or contract. Intending purchasers should not rely on them as statements of representation of fact, but must satisfy themselves by inspection or otherwise as to their accuracy. No person in this firm's employment has the authority to make or give any representation or warranty in respect of the property.