



## 3 Durban Avenue, Liverpool

In Excess of £170,000

# 3 Durban Avenue

Liverpool, Liverpool

Well-presented 2-bed terrace for cash buyers. No chain. Modern kitchen, conservatory, parking, garden, shed. Cash buyers only Structural report available. Close to amenities and transport. Council Tax band: B

Tenure: Freehold

EPC Energy Efficiency Rating: D

EPC Environmental Impact Rating: D

- Off-road parking
- Integrated appliances
- Garden access via sliding doors
- Private fenced garden
- Paved patio for entertaining
- Conservatory with garden access
- Modern kitchen units and countertops
- Ample natural light throughout
- Garden shed for storage
- Cash Buyers only
- Structural report available upon request
- No chain sale
- Highly Sought after location
- Open Plan Kitchen Diner
- Two Bedrooms & Family Bathroom
- Conservatory
- Close To Local Amenities & Transport Networks





**Ground Floor**

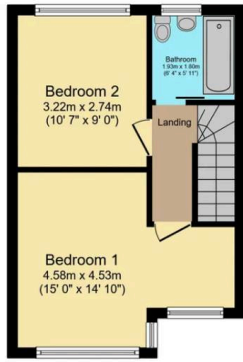

**First Floor**

Total floor area 71.0 sq.m. (765 sq.ft.) approx



## Aspire Estates

Aspire Properties, Wira Business Park Ring Road - LS16 6EB

0113 8875079

[estatesales@aspirepropertygroup.co.uk](mailto:estatesales@aspirepropertygroup.co.uk)

[www.aspirepropertygroup.co.uk/](http://www.aspirepropertygroup.co.uk/)