

## Upper Tooting Road, SW17

£2,000 Per calendar month

Large two bedroom flat located in a purpose built building in Tooting Bec. The property benefits from two good sized double bedrooms, a spacious living room and separate kitchen, ideal for two professional sharers.

Holmbury Court is located in the heart of Tooting with the vast amenities, shops, bars & restaurants on the doorstep, with Tooting Market a stone throws away. The excellent transport links Tooting Bec Underground station and green open spaces of Tooting Bec Common are also within walking distance.

### Features

- Third Floor Flat
- Two Bedroom
- Spacious Reception
- Separate Kitchen
- Wandsworth Council
- Tooting Bec Station

# Upper Tooting Road, London, SW17

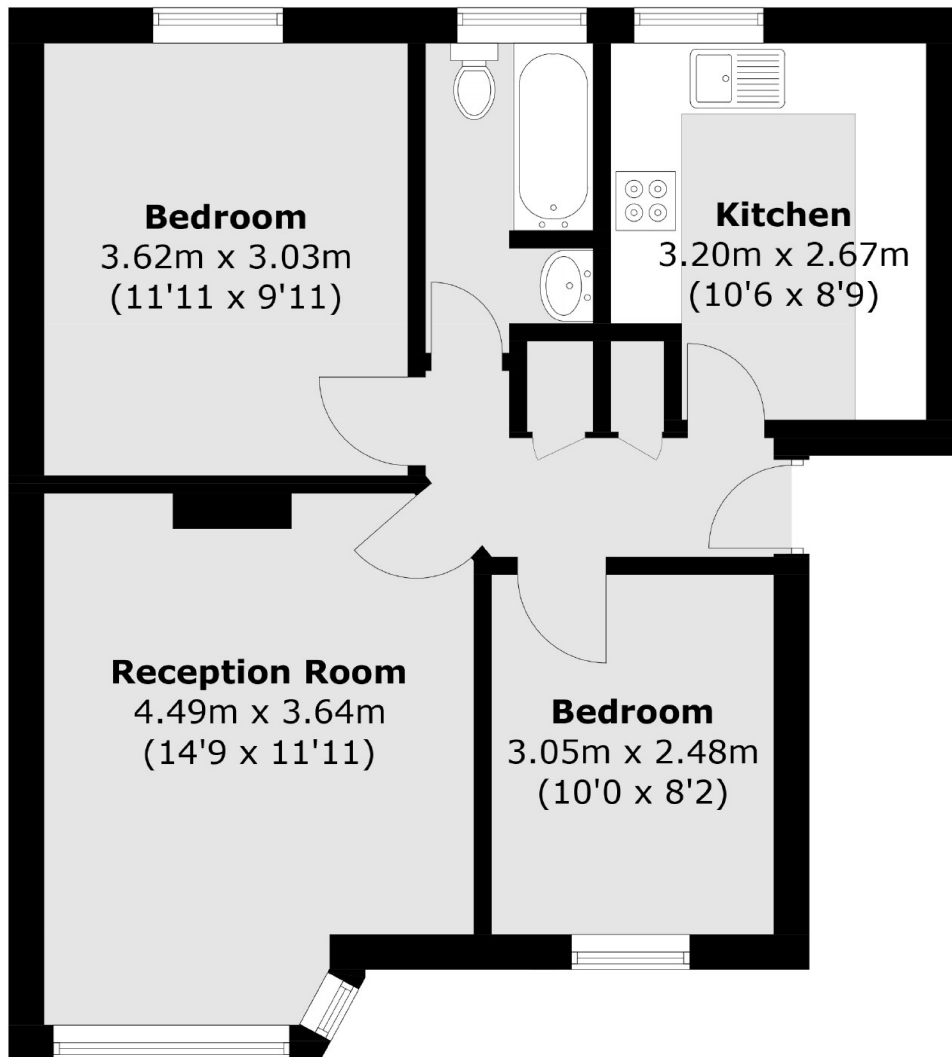

Total area (approx.): 52.8 sq. m (568.3 sq. ft)