



Eden Lilly
4 Mill Road

making it all add up...
HackettGriffey
chartered certified accountants
Telephone: 01464 702024
Email: info@hackettgriffey.com
www.hackettgriffey.com

well Pharmacy
Haverhill
Providing NHS services

MILL ROAD

Mill Road, Haverhill, CB9 8BD

CHEFFINS

Mill Road

Haverhill,
CB9 8BD

A modern and well presented one bedroom flat located in the centre of Haverhill. The property benefits from an open plan kitchen & living room area and modern presentation throughout. Available 8th May 2026.



£850 PCM



- One Bedroom Flat
- Living Room/Kitchen Area
- Bathroom
- Town Centre Location
- EPC Rating D
- Council Tax Band A



FIRST FLOOR

Kitchen/Living Room

Two windows to rear. Stainless steel mixer tap unit, electric hob with fan assisted oven. door to:

Bedroom

Window to front, door to:

Bathroom

Shower unit, toilet and hand basin with mirror unit over top.

Material Information

For more information on this property please refer to the Material Information brochure on our Website

Holding Deposit

£196.00



Ground Floor

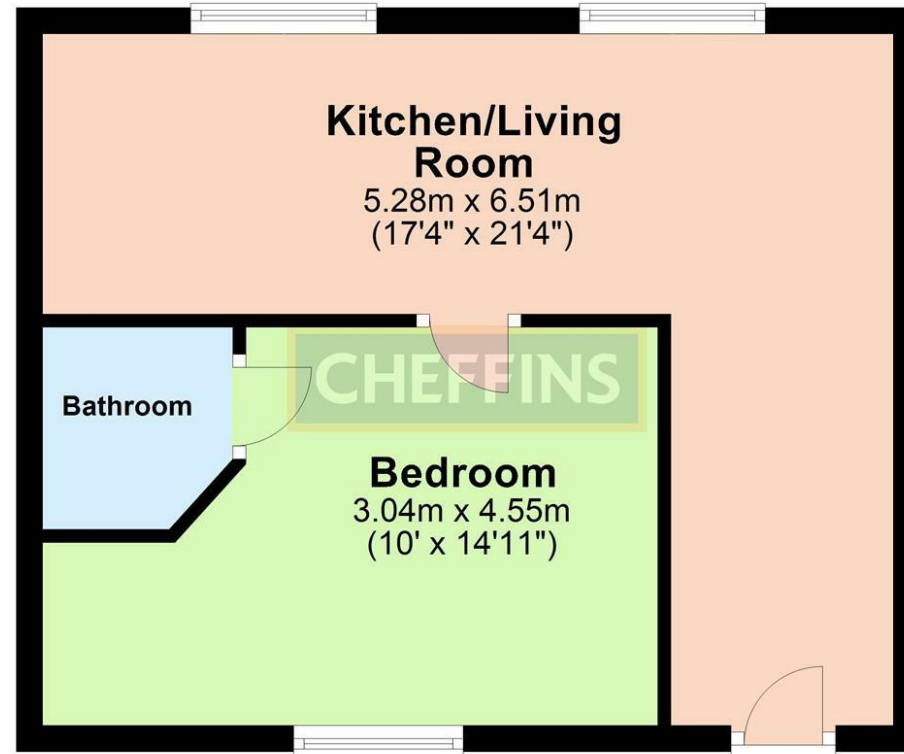

Note: Not to scale - For guidance purposes only
Plan produced using PlanUp.

Energy Efficiency Rating

	Current	Potential
Very energy efficient - lower running costs		
(92 plus) A		
(81-91) B		
(69-80) C		
(55-68) D	55	55
(39-54) E		
(21-38) F		
(1-20) G		
Not energy efficient - higher running costs		
England & Wales	EU Directive 2002/91/EC	

Agents note:

For more information on this property please refer to the Material Information Brochure on our website.

Cavendish House, 27a High Street, Haverhill, Suffolk, CB9 8AD | 01440 707076 | cheffins.co.uk

IMPORTANT: we would like to inform prospective purchasers that these sales particulars have been prepared as a general guide only. A detailed survey has not been carried out, nor the services, appliances and fittings tested. Room sizes should not be relied upon for furnishing purposes and are approximate. If floor plans are included, they are for guidance only and illustration purposes only and may not be to scale. If there are any important matters likely to affect your decision to buy, please contact us before viewing the property.

