



Tortoiseshell Drive, Attleborough NR17 1GW

welcome to

Tortoiseshell Drive, Attleborough

The property is the Appleford design and was built by Taylor Wimpey. It is conveniently located for access to Schools and public transport links too. Ideal first-time buyer property this two bed semi- detached with open plan living area has a large rear garden and comes with two parking spaces.



Description

Welcome to this well presented two-bedroom home, ideally suited for first time buyers looking to take their first steps onto the property ladder, or savvy investors seeking a strong addition to their profile.

Situated in a convenient location, this charming property offers comfortable and versatile living accommodation throughout. The home features a bright and spacious reception room, perfect for relaxing or entertaining guests, well-appointed bathroom and two generously sized bedrooms that provide ample space for both rest and storage.

The property benefits from natural decor, allowing the new owner to move straight in or add their own personal touches. With excellent transport links, local amenities, and schools nearby, the home enjoys a location that balances lifestyle and convenience.

Whether you're looking for your first home or a reliable buy-to-let opportunity, this property ticks all the boxes.

Entrance Hall

Door to the front aspect and utility cupboard housing boiler with plumbing for washing machine.

Cloak Room

A large suite comprising of WC, wash hand basin and a radiator. Front aspect window.

Kitchen Open Plan Living Room

Open plan Kitchen, living and dining room, French doors with glazed units to the side plus a radiator. Kitchen selection of matching base level and wall mounted storage units with work surface over and a 1.5 bowl stainless steel sink/drain unit. Electric oven and gas hob with a cooker hood plus space for a fridge/freezer. Stairs to first floor.

Bedroom One

Fitted carpet, radiator, Window to rear aspect window complete with floor to ceiling fitted wardrobes giving plenty of storage space.

Bedroom Two

Front aspect window and radiator fitted carpet.

Bathroom

A partially tiled suite comprising of WC, wash hand basin with mixer taps and over bath shower. Extractor fan and radiator.

Front Garden

With an area of lawn to the front with pathway to the entrance door and two allocated parking spaces

Rear Garden

With a decked seating area and paved patio area and pathway. The garden is mainly laid to lawn and enclosed by panel fencing with gated access to the front. The garden extends to the side of the house where there is a large shed.

Agency Notes

Site fees £90 every six months (£180 per ann)

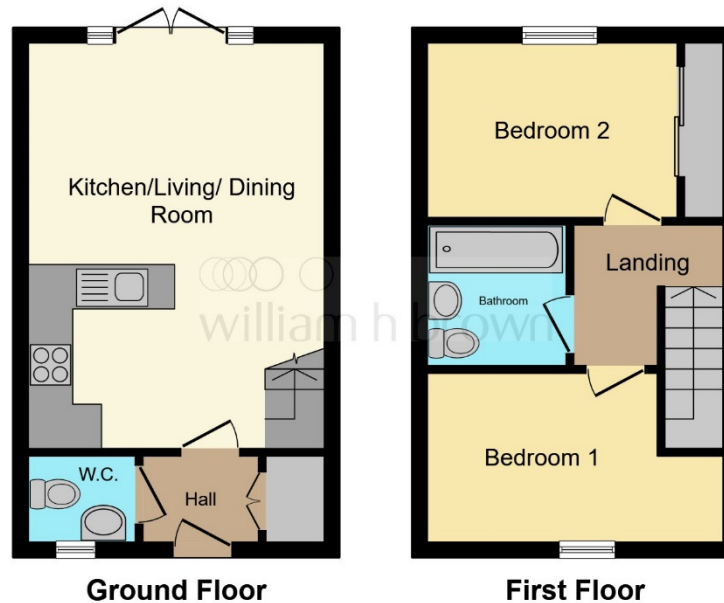

This floor plan is for illustrative purposes only. It is not drawn to scale. Any measurements, floor areas (including any total floor area), openings and orientation are approximate. No details are guaranteed, they cannot be relied upon for any purpose and they do not form part of any agreement. No liability is taken for any error, omission or misstatement. A party must rely upon its own inspection(s). Powered by www.focalagent.com



view this property online williamhbrown.co.uk/Property/ATB110124



welcome to

Tortoiseshell Drive, Attleborough

- Stylish open plan living
- Ideal for first time buyers
- Generous size garden
- Off road parking for two vehicles
- Corner plot
- Viewing recommended

Tenure: Freehold EPC Rating: B Council Tax Band: B

£215,000



Please note the marker reflects the postcode not the actual property

view this property online williamhbrown.co.uk/Property/ATB110124



Property Ref:
ATB110124 - 0005

1. MONEY LAUNDERING REGULATIONS Intending purchasers will be asked to produce identification documentation at a later stage and we would ask for your co-operation in order that there is no delay in agreeing the sale. 2. These particulars do not constitute part or all of an offer or contract. 3. The measurements indicated are supplied for guidance only and as such must be considered incorrect. Potential buyers are advised to recheck measurements before committing to any expense. 4. We have not tested any apparatus, equipment, fixtures or services and it is in the buyers interest to check the working condition of any appliances. 5. Where an EPC, or a Home Report (Scotland only) is held for this property, it is available for inspection at the branch by appointment. If you require a printed version of a Home Report, you will need to pay a reasonable production charge reflecting printing and other costs. 6. We are not able to offer an opinion either written or verbal on the content of these reports and this must be obtained from your legal representative. 7. Whilst we take care in preparing these reports, a buyer should ensure that his/her legal representative confirms as soon as possible all matters relating to title including the extent and boundaries of the property and other important matters before exchange of contracts.

William H Brown is a trading name of Sequence (UK) Limited which is registered in England and Wales under company number 4268443, Registered Office is Cumbria House, 16-20 Hockliffe Street, Leighton Buzzard, Bedfordshire, LU7 1GN. VAT Registration Number is 500 2481 05.



william h brown



01953 452990



Attleborough@williamhbrown.co.uk



Exchange Street, ATTLEBOROUGH, Norfolk,
NR17 2AB



williamhbrown.co.uk