



13 BUDE ROAD,
, BS34 7HN

**GOODMAN
& LILLEY**



OFFERED TO THE MARKET WITH NO ONWARD CHAIN, THIS THREE-BEDROOM SEMI-DETACHED HOME PRESENTS AN EXCELLENT OPPORTUNITY FOR BUYERS LOOKING TO MODERNISE AND ADD VALUE.

AN EARLY VIEWING IS STRONGLY ADVISED TO FULLY APPRECIATE WHAT IS ON OFFER HERE.

Requiring updating throughout, the property offers well-proportioned accommodation and plenty of potential to create a fantastic family home tailored to individual tastes and requirements. No onward chain.

Location

Situated in a popular residential location, the home is conveniently positioned for local schools, shops, transport links, and amenities. Ideal for first-time buyers, investors, or anyone seeking a refurbishment project in a well-established area.

Accommodation

Please see the floorplan for the room measurements and property layout.

Ground Floor

The ground floor comprises a spacious front facing living room opening to a large dining area, and kitchen which leads out to the rear garden.

First Floor

Stairs lead up to the first floor landing offering three bedrooms and a family bathroom with white suite.

Outside

Gardens and Parking

Externally, the property benefits from front and rear gardens along with driveway parking.

-
- Bude Road, Filton
 - Three bedrooms
 - Off street parking
 - Ideally positioned for schools and amenities
 - Semi-detached house
 - Large rear garden
 - Requiring updating throughout
 - No onward chain



GUIDE PRICE £350,000



Ground Floor

Approx. 52.6 sq. metres (566.4 sq. feet)

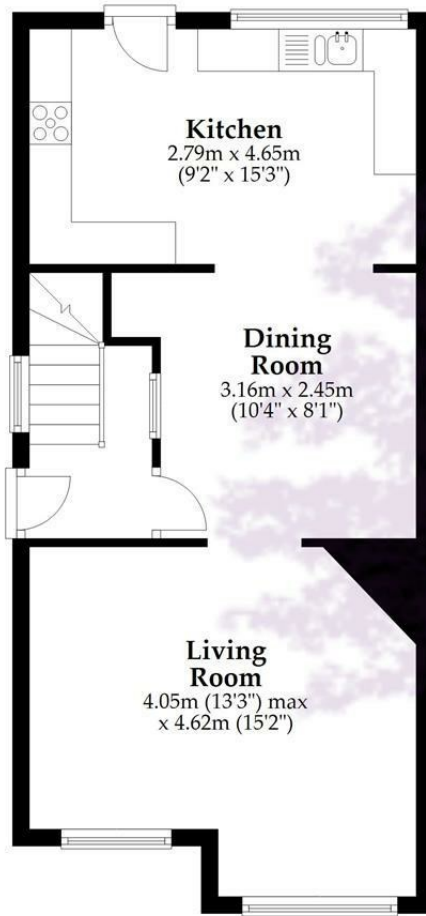

First Floor

Approx. 32.2 sq. metres (346.2 sq. feet)

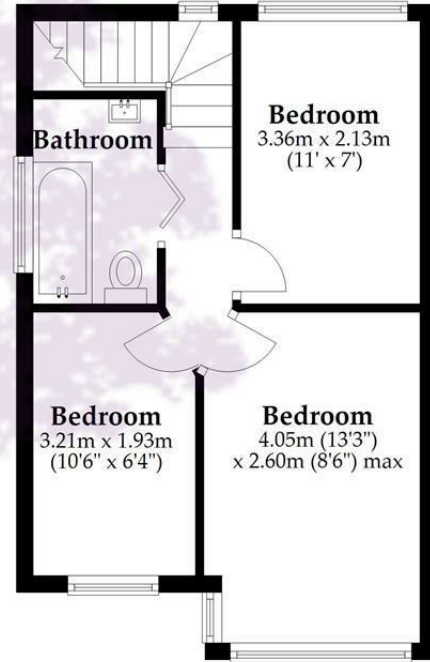

Total area: approx. 84.8 sq. metres (912.7 sq. feet)

Whilst every attempt has been made to ensure accuracy of the floor plan all measurements are approximate and no responsibility is taken for any error, omission or measurement.

Plan produced using PlanUp.

HENLEAZE - 0117 2130777
henleaze@goodmanlilley.co.uk

PORTISHEAD - 01275 430440
sales@goodmanlilley.co.uk

SHIREHAMPTON - 0117 2130333
shire@goodmanlilley.co.uk

Zoopla.co.uk

rightmove



WWW.GOODMANLILLEY.CO.UK

These particulars are for general guidance only. They do not form or constitute any part of an offer or contract. Goodman & Lilley has not carried out structural surveys of the property. The services, appliances or specific fittings mentioned in these details have not been tested. Every attempt is made to ensure accuracy, however all photographs, measurements, floor plans and distances are for illustrative purposes only. They must not be relied upon when purchasing carpets and or other fixtures & fittings. Lease details, service charges and ground rents are given as a guide only. They should be checked and confirmed by a licensed solicitor prior to exchange of contracts. The copyright of all details, photographs and floor plans remain exclusive to Goodman & Lilley.