



The Huntingdon

4 bedroom semi-detached
and detached home



Computer Generated Image - The Huntingdon

The Huntingdon

4 bedroom semi-detached and detached home

Plots 14, 15, 165, 175, 189 & 194 – as shown

Plots 160, 179 & 188 – handed

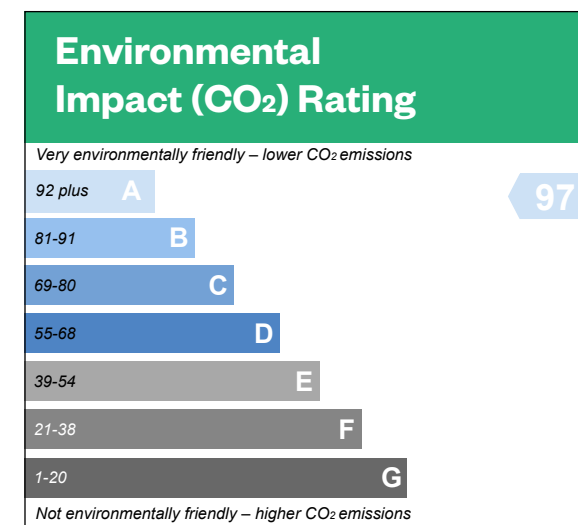
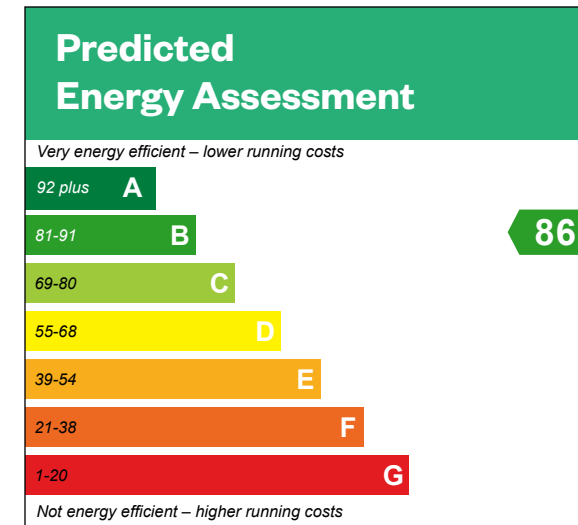

This is a Predicted Energy Assessment for properties that are incomplete. Once the property is completed, this rating will be updated and an official Energy Performance certificate will be created for the property.

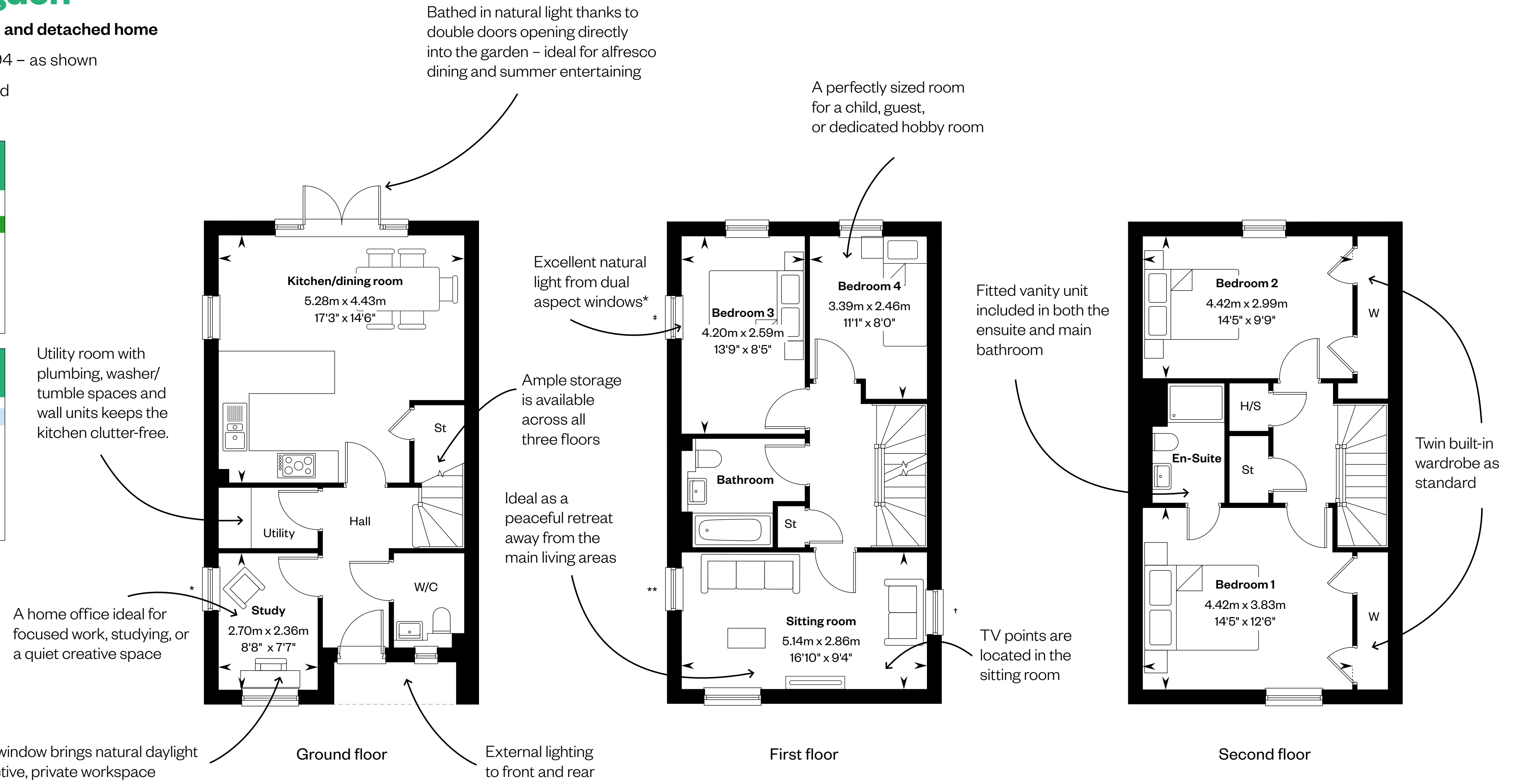

*Window omitted to plot 189. *Window omitted to plots 189 & 14. **Window omitted to plots 14, 160, 165, 175, 179, 189 & 194. †Window to plots 160, 165, 175, 179 & 194 only. Please ask your Sales Consultant for further details.

H/S: Heating system cupboard. St: Store cupboard. W: Wardrobe.

IMPORTANT NOTICE TO CUSTOMERS: The Consumer Protection from Unfair Trading Regulations 2008. Cala Homes (North Home Counties) Limited operates a policy of continual product development and the specifications outlined in this brochure are indicative only. The computer generated images and photographs do not necessarily represent the actual finishings/ elevation or treatments, landscaping, furnishings and fittings at this development. Information contained is accurate at date of publication on 10.02.26. See the main brochure for the full Consumer Protection statement.