



Artichoke Hill, E1W

£299,999

We are pleased to present this one bedroom apartment, ideally situated in the heart of West Wapping. The property is conveniently located within walking distance of Tobacco Dock and benefits from excellent local amenities and transport links. Stacker parking is also available to purchase under separate negotiation for £25,000.

Artichoke Hill is conveniently located close to Tower Hill Station and Shadwell DLR, with Aldgate and Aldgate East Underground stations also within easy walking distance, providing excellent connectivity across London.

Features

- One Bedroom
- South Facing
- Open Plan Kitchen
- Long Lease
- Chain Free
- West Wapping

Artichoke Hill, London, E1W

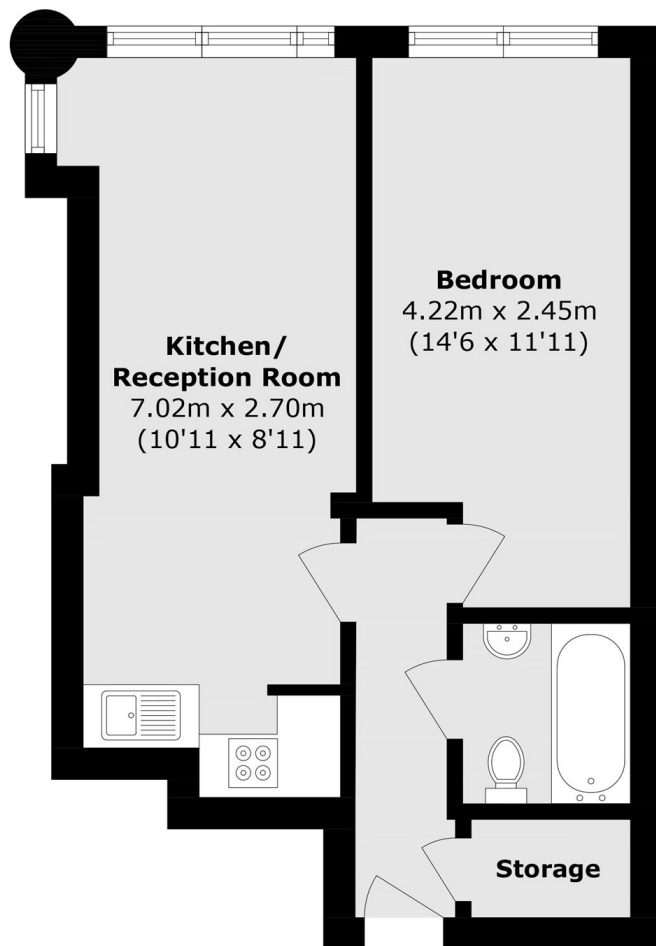

Total area (approx.): 38.6 sq. m (415.4 sq. ft)