



32 Young Crescent

Bathgate EH48 2SL

Offers Over £97,000

Caesar & Howie

Solicitors & Estate Agents



32 Young Crescent

Bathgate EH48 2SL

This is a popular style lower flat, situated in a sought after area and well placed for amenities and the town centre. It will provide an ideal first buy, retirement flat or investment perhaps. It has a good size lounge/dining, kitchen with appliances and double bedroom with large built-in wardrobe. The bathroom is tiled and has electric shower over bath. To the rear, there is a fully enclosed garden with sunny position. Excellent storage facilities. Early/flexible entry available. Chain free.

- **Entrance/storage**
- **Lounge**
- **Kitchen**
- **Inner hall/storage**
- **Bedroom**
- **Bathroom**
- **GCH & DG**
- **Gardens**
- **Allocated parking space adjacent**
- **Council Tax Band B**
- **Floor area 42m2 approx.**



Viewings: Strictly by appointment through Caesar & Howie on 01506 435306 or email mam@caesar-howie.co.uk



32 Young Crescent

32 Young Crescent

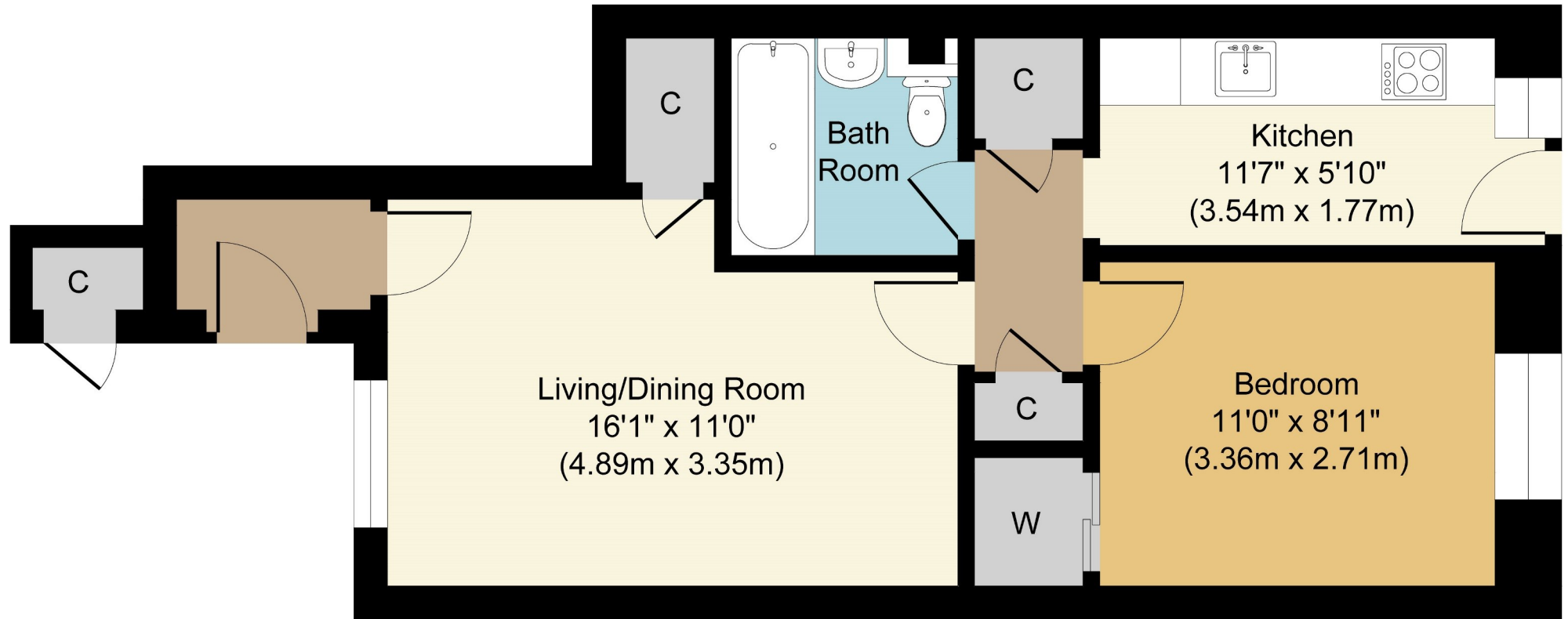

Whilst every attempt has been made to ensure the accuracy of the floor plan contained here, measurements of doors, windows, rooms and any other items are approximate and no responsibility is taken for any error, omission