



For Sale

111 Spring Pool, Warwick

Offers Over £175,000

1

1

1

420 sq ft

**\*\*\* WELL PRESENTED DOUBLE BEDROOM MEWS HOUSE OFFERED FOR SALE WITH NO OWARD CHAIN \*\*\***

... WELL PRESENTED DOUBLE BEDROOM MEWS HOUSE OFFERED FOR SALE WITH NO OWARD CHAIN ...

The property offers excellent local amenities including local shops and schools, while also offering easy access into Warwick town centre. For commuters there are frequent trains from Warwick Train Station and access to the Warwick Bypass and M40 motorway network.

The property has a very good record as a buy to let property or would also be ideal for first time buyers, downsizers and investors either looking to rent it out long term or Air B and B it.

In brief the ground floor comprises of; open plan lounge / kitchen / dini0ng area with open stairs leading up to the first floor.

Upstairs there is a fantastic sized double bedroom with built in storage cupboard over the stairs and enough space for a desk and chair, ideal for those working from home and there is a white bathroom suite with built in storage cupboard.



**Nathaniel Cleaver**

07793 363210

nathaniel@thepropertyexperts.co.uk



The Property Experts UK

01926436105



- End Terrace Mews House
- One Double Bedroom
- Open Plan Living / Kitchen / Dining Area
- White Bathroom Suite
- Freehold
- Communal Parking
- Close To All Local amenities
- No Onward Chain
- EPC Rating - C

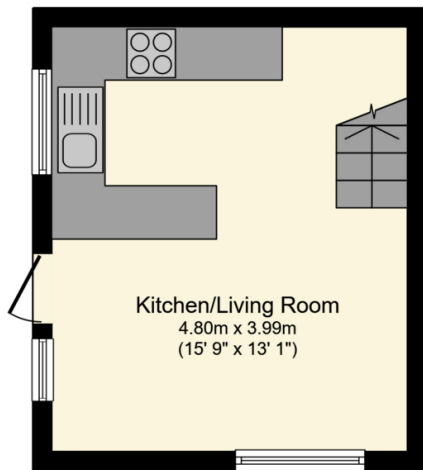

**Ground Floor**  
Floor area 19.1 sq.m. (206 sq.ft.)

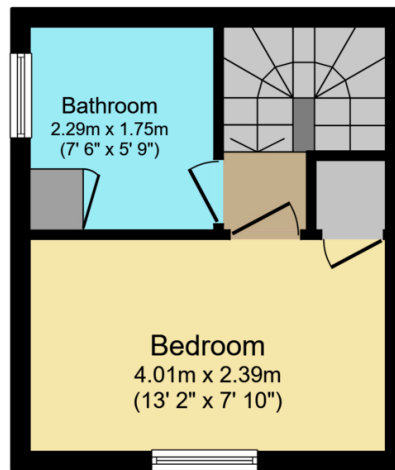

**First Floor**  
Floor area 19.1 sq.m. (206 sq.ft.)

Total floor area: 38.2 sq.m. (411 sq.ft.)

This floor plan is for illustrative purposes only. It is not drawn to scale. Any measurements, floor areas (including any total floor area), openings and orientations are approximate. No details are guaranteed, they cannot be relied upon for any purpose and do not form any part of any agreement. No liability is taken for any error, omission or misstatement. A party must rely upon its own inspection(s). Powered by www.Propertybox.io

