



St. Peters Way, W5

£519 pw (£2,250 pcm)

This purpose built two bedroom apartment features a spacious living room with dining area, separate kitchen and a modern bathroom.

St. Peters Way is a small cul-de-sac opposite Montpelier Primary School, north of Ealing Broadway (Elizabeth, District and Central lines and overground) station.

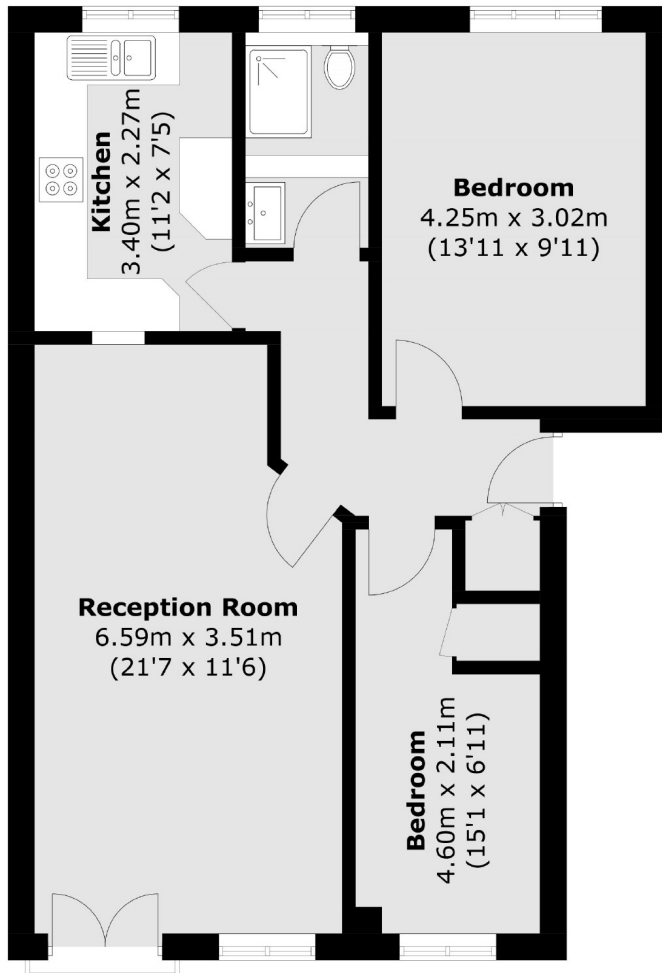

Second Floor

Total area (approx.): 64.4 sq. m (693.2 sq. ft)

Robertson Smith & Kempson Ealing Lettings
1 The Broadway,
London, W5 2NT
020 8840 7885
ealinglettings@robertsonsmithandkempson.co.uk

Energy Rating: D. We aim to make our particulars both accurate and reliable. However they are not guaranteed; nor do they form part of an offer or contract. If you require clarification on any points then please contact us, especially if you're traveling some distance to view. Please note that appliances and heating systems have not been tested and therefore no warranties can be given as to their good working order.