

## 33 Highertown Park, Landrake

Guide Price £220,000

3 1 1

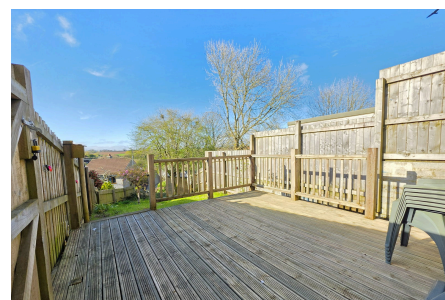

The property is thoughtfully arranged, beginning with a handy porch entrance that leads into a spacious and inviting living room. To the rear, a generous kitchen/diner forms the heart of the home, featuring patio doors that open onto a raised decked area. Outside, the property boasts a large garden plot with a combination of decking and lawn, offering fantastic potential for keen gardeners or those wishing to create a bespoke outdoor space. Side access adds to the practicality of the garden, enhancing its overall appeal. Upstairs, there are three well-proportioned bedrooms, two of which enjoy wonderful far-reaching views across the surrounding countryside. A modern family bathroom completes the first-floor accommodation. Further benefits include driveway parking, adding convenience to this already impressive home.

## Key Features

- Freehold - Council Tax B - EPC C
- Three Well-Proportioned Bedrooms
- Bright & Airy Kitchen/Diner
- Large Rear Garden
- Quiet Village Location
- Delightful Terraced Home
- Spacious Living Room
- Modern Family Bathroom
- Driveway Parking
- Quote BH0675 To Book Your Viewing

### Ground Floor

Approx. 31.0 sq. metres (333.4 sq. feet)

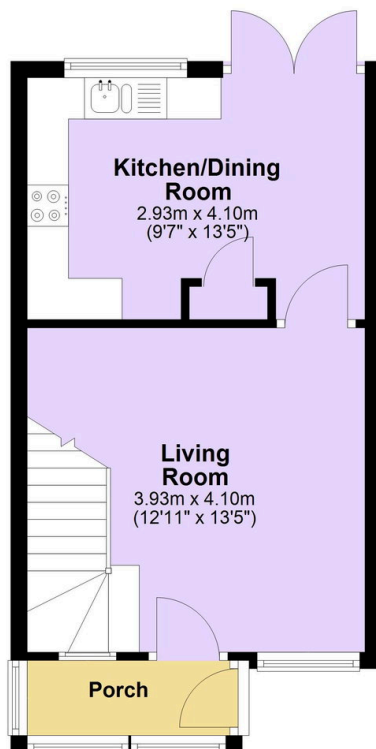

### First Floor

Approx. 36.6 sq. metres (394.3 sq. feet)

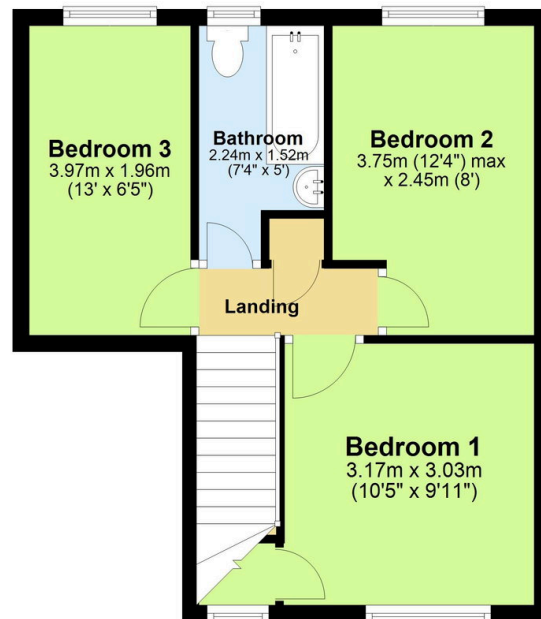

Total area: approx. 67.6 sq. metres (727.7 sq. feet)