



Apartment (EPC Rating: D)

**8 RESERVOIR COURT UPPER CARR LANE,  
CALVERLEY, LS28 5GP**  
Per month

**£1,000 Per**



# 2 Bedroom Apartment located in Calverley

This spacious and pet-friendly duplex apartment is set within a beautifully restored Victorian reservoir, combining period character with modern comfort.

With two double bedrooms, two bathrooms, and secure garage parking, it's perfectly suited to professional couples, pet owners, or a family looking for high-quality accommodation.

The apartment offers a sleek fitted kitchen with integrated appliances including a fridge/freezer, oven, hob and washing machine.

Key features include:

- Telephone entry intercom system
- Allocated parking in a secure garage



HEAD OFFICE | N14 ST. JOHN'S SQUARE, WAKEFIELD, WEST YORKSHIRE, WF1 2RA

GROUND FLOOR  
406 sq.ft. (37.7 sq.m.) approx.

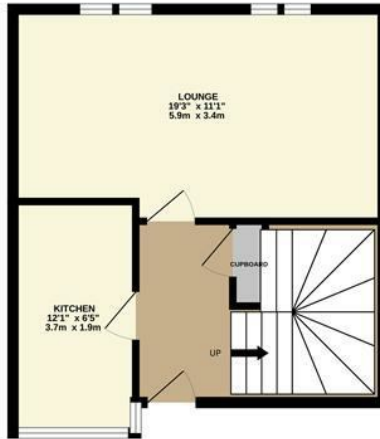

FIRST FLOOR  
396 sq.ft. (36.8 sq.m.) approx.

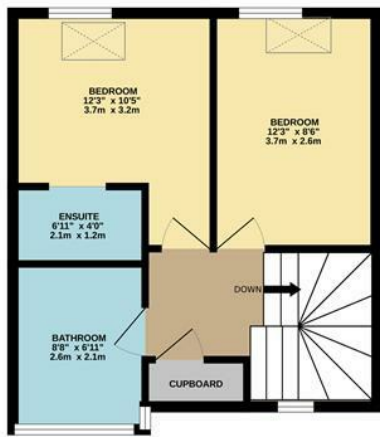

TOTAL FLOOR AREA : 812sq.ft. (75.4 sq.m.) approx.

Whilst every attempt has been made to ensure the accuracy of the floorplan contained here, measurements of doors, windows, rooms and any other items are approximate and no responsibility is taken for any error, omission or mis-statement. This plan is for illustrative purposes only and should be used as such by any prospective purchaser. The services, systems and appliances shown have not been tested and no guarantee as to their operability or efficiency can be given.  
Made with Metropix ©2024

Council Tax Band

C

Energy Performance Graph

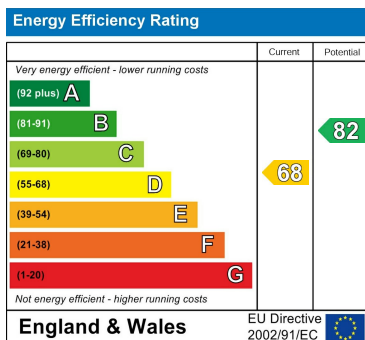

Call us on

0800 7720 789

hello@littleboyestates.co.uk

littleboyestates.co.uk

Agents Note: Whilst every care has been taken to prepare these particulars, they are for guidance purposes only. All measurements are approximate and are for general guidance purposes only and whilst every care has been taken to ensure their accuracy, they should not be relied upon and potential buyers are advised to recheck the measurements.

