

23 Redwood Manor,  
Tanners Lane, Haslemere,  
Surrey GU27 2PZ



Peter Leete  
and Partners  
ESTATE + AGENTS



A 1 Bedroom first floor apartment in this sought after development close to the town centre and main line railways station.  
Offered with vacant possession.

**PRICE £80,000 LEASEHOLD**



### SITUATION

Haslemere offers a wide range of shopping facilities both in the High Street with nationally known retailers and restaurants and at Wey Hill which also affords a Tesco's supermarket and Marks and Spencers food hall. The local area is renowned for its open countryside and miles of National Trust Commons with numerous beauty spots within easy reach, The Devil's Punchbowl, Marley Common, The Golden Valley to name but a few. Golf is readily available at Hindhead and Chiddingfold with sailing at Frensham Ponds. There is a main line railway station within the Town which offers a train service to Waterloo in approximately 50 minutes by way of South West Trains. The A3 London to Portsmouth Road is about 3 miles distant. The main airports of Gatwick and Heathrow are 50 miles and 42 miles respectively with access to the M25 at Junction 10 (23 miles).

### DESCRIPTION:

Communal entrance hall with stairs and lift to first floor:-

### ACCOMMODATION:

Private entrance hall with storage cupboard.

**KITCHEN:** fitted with a range of wall and base units the latter with w worksurface and inset stainless steel sink unit and drainer. Cooker, base fridge and freezer. Rear aspect

**LIVING ROOM:** with rear aspect and archway to kitchen.

**BEDROOM:** with rear aspect and fitted wardrobes.

**SHOWER ROOM:** Walk in style shower enclosure wash basin and low level wc.

**OUTSIDE:** private car parks and communal grounds..

**VIEWINGS:** Strictly by appointment with the sole Agents: SCR Lettings 01428 607768 or Peter Leete and Partners 01428 604480.

**EPC:** B

**COUNCIL TAX BAND:** B

**LEASE:** 125 years from 1<sup>st</sup> June 1988

**MAINTENANCE:** £5698.40 last financial year 2025/2026

**GROUND RENT:** £609.04 per annum

**NOTES:** Site manager \* 24hour monitored emergency system \* Over 60's only\* residents lounge\* Residents parking\* Communal Laundry\* Mains water, drainage and electric\*

**AML (Anti Money Laundering)** - Estate agents operating in the UK are required to conduct Anti-Money Laundering (AML) checks in compliance with the regulations set forth by HM Revenue and Customs (HMRC) for all property transactions. It is mandatory for both buyers and sellers to successfully complete these checks before any property transaction can proceed. We use a company Coadjute to facilitate these checks. A non returnable fee will be charged for each individual AML check conducted.

**SPECIAL NOTES:** Peter Leete and Partners/SCR Sales and Lettings and its Clients give notice that: they have no authority to make or give any representations or warranties in relation to the property. These particulars do not form part of any offer or contract and must not be relied upon as statements or representations of fact. Any areas, measurements or distances are approximate. The text, photographs and plans are for guidance only and are not necessarily comprehensive. It should not be assumed that the property has all necessary Planning, Building Regulation or other consents, and Peter Leete and Partners/SCR Sales and Lettings has not tested any services, appliances, or facilities. Purchasers must satisfy themselves by inspection or survey. Both agencies are a member of The Property Ombudsman scheme and both act in accordance with their code of practice.

## 23 Redwood Manor Haslemere

Approximate Gross Internal Area  
495 sq ft - 46 sq m

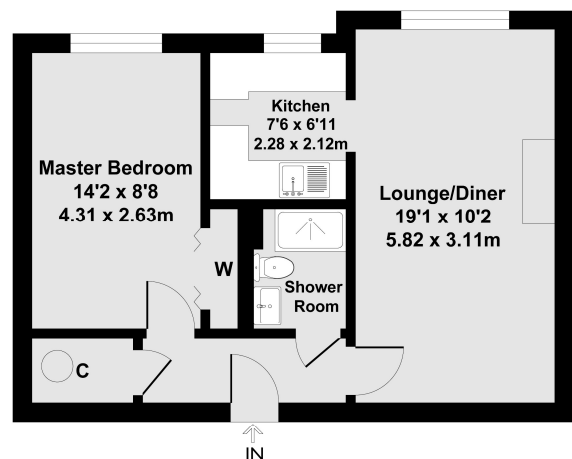

Not to Scale. Produced by The Plan Portal 2026  
For Illustrative Purposes Only.

