



Wanless Road | London | SE24

Freehold

£775,000

- Three story Victorian Terrace House
- Three double bedrooms
- Through lounge with wood floor
- Period fireplaces
- Roof terrace and patio garden
- Walking distance to Brixton tube
- Ruskin & Brockwell Parks
- Herne Hill farmers market
- Great schools
- Chain free!



SE24 - A three story flat fronted Victorian Terrace House located within a 15-minute walk of Brixton tube. The house has been well looked after and features a large through lounge with a wood floor and a pretty patio garden. Three double bedrooms plus family bathroom. An excellent location in a bustling vibrant part of London, very close to Ruskin Park, with its summer bandstand concerts, paddling pool and fete. Herne Hill weekend farmers market, cafes, Brockwell park and Lido. Loughborough junction with swift access in to London, new shops, cafes and bars, horse riding and local redevelopment and funding. A lovely house, full of character in a great up and coming area, within walking distance of pretty much everything, including St. Saviours & Jessops Schools.

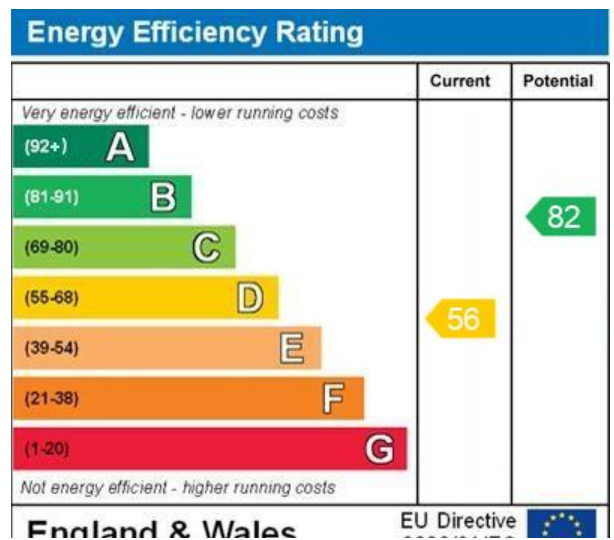

GROUND FLOOR
371 sq.ft. (34.5 sq.m.) approx.

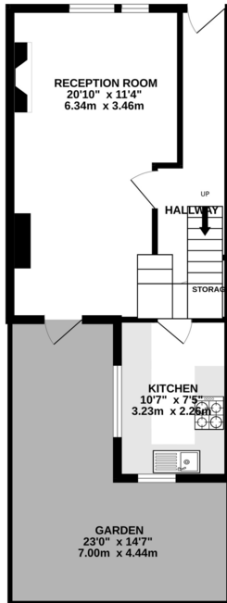

1ST FLOOR
303 sq.ft. (28.1 sq.m.) approx.



2ND FLOOR
303 sq.ft. (28.1 sq.m.) approx.

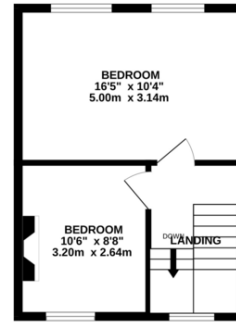

TOTAL FLOOR AREA: 976 sq.ft. (90.7 sq.m.) approx.

Whilst every attempt has been made to ensure the accuracy of the floorplan contained herein, measurements of doors, windows, rooms and any other items are approximate and no responsibility is taken for any error, omission or mis-statement. This plan is for illustrative purposes only and should be used as such by any prospective purchaser. The services, systems and appliances shown have not been tested and no guarantee as to their operability or efficiency can be given.
Made with Metropix 10/2025

Viewing Arrangements

Strictly by appointment

Contact Details

121 Denmark Hill

London

SE5 8EN

www.urbanvillagehomes.co.uk

sales@urbanvillagehomes.com

020 3519 9121

Agents Note: Whilst every care has been taken to prepare these sales particulars, they are for guidance purposes only. All measurements are approximate and for general guidance purposes only and whilst every care has been taken to ensure their accuracy, they should not be relied upon and potential buyers are advised to recheck the measurements