



- \* STUNNING FOUR BEDROOM FAMILY HOME \* LARGE PLOT \*
- \* SPACIOUS FITTED KITCHEN/DINER \* THROUGH LOUNGE \*
- \* DOUBLE GARAGE \* OFF ROAD PARKING TO FRONT \* TWO BATHROOMS \*
- \* UTILITY ROOM AND GROUND FLOOR W/C \*
- \* CLOSE TO LOCAL SCHOOLS AND SHOPS \* MUST SEE PROPERTY \*



24 Woodside Drive  
Dartford, DA2 7NG

Guide Price £780,000 -  
£810,000

Set on the peaceful and sought-after Woodside Drive in Joydens Wood, this superbly presented, large extended family home offers an exceptional lifestyle for growing families. Boasting approximately 2,000 sq ft of well-designed living space, the property combines spacious interiors with a generous outdoor plot totalling 0.16 acre, making it an ideal retreat for those seeking both comfort and versatility.



**EPC RATING C**  
**COUNCIL TAX BAND E**

**Woodside Drive, DA2**

Approximate Gross Internal Area 161.8 sq m / 1742 sq ft  
Garage = 27.9 sq m / 301 sq ft  
Total = 189.7 sq m / 2043 sq ft

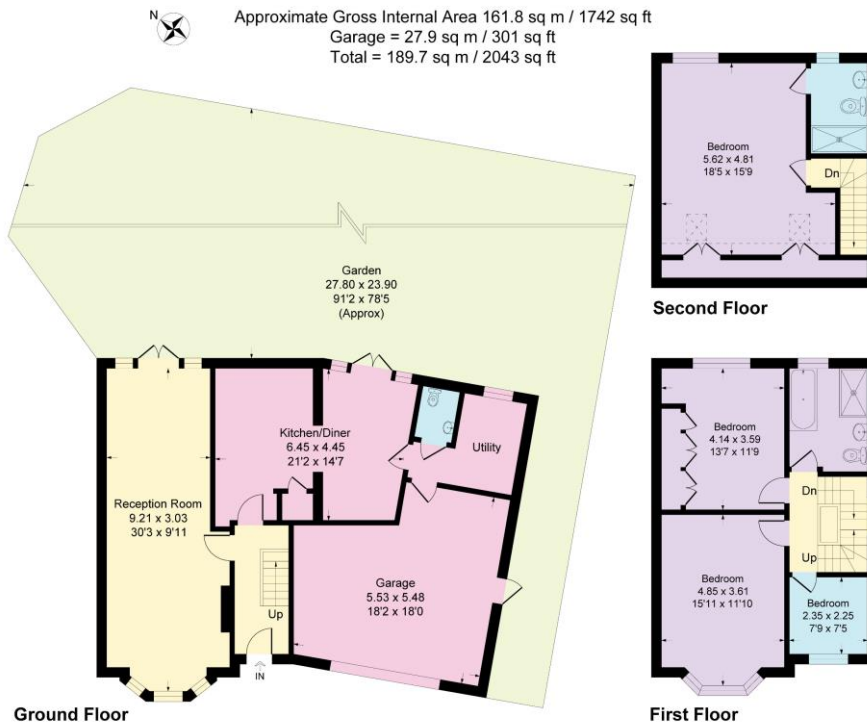

This plan is for layout guidance only. Not drawn to scale unless stated. Windows and door openings are approximate. Whilst every care is taken in the preparation of this plan, please check all dimensions, shapes and compass bearings before making any decisions reliant upon them.  
Produced By Planpix

We understand this property is Freehold.

**VIEWING:**

Via **Village Estates** on 01322 522111  
Monday to Friday 9am-6pm, Saturday 9am-5pm

**SELLING YOUR HOME?**

If you are thinking of selling your own property, **VILLAGE ESTATES** will be pleased to provide you with a free market appraisal for sale purposes and professional marketing advice **FREE OF CHARGE, WITHOUT OBLIGATION**. Call one of our experienced sales staff on 01322 522111.

Whilst we endeavour to make our sales details reliable and accurate they should not be relied on as representations or statements of fact, and do not form any part of an offer or contract. The Seller does not make or give nor do we or our employees have authority to make or give any representation or warranty in relation to the property. We would strongly recommend that all the information which we provide about the property is verified by yourself on inspection and also by your conveyancer, especially where statements have been made by us to the effect that the information provided has not been verified. If there are any other points which are of particular importance to you, we would be only too happy to check the information and indeed confirm the availability of the property. Please contact the above office to arrange a convenient viewing appointment.