



See More Online

KFB: Key Facts For Buyers

A Guide to This Property & the Local Area

Thursday 14th May 2026

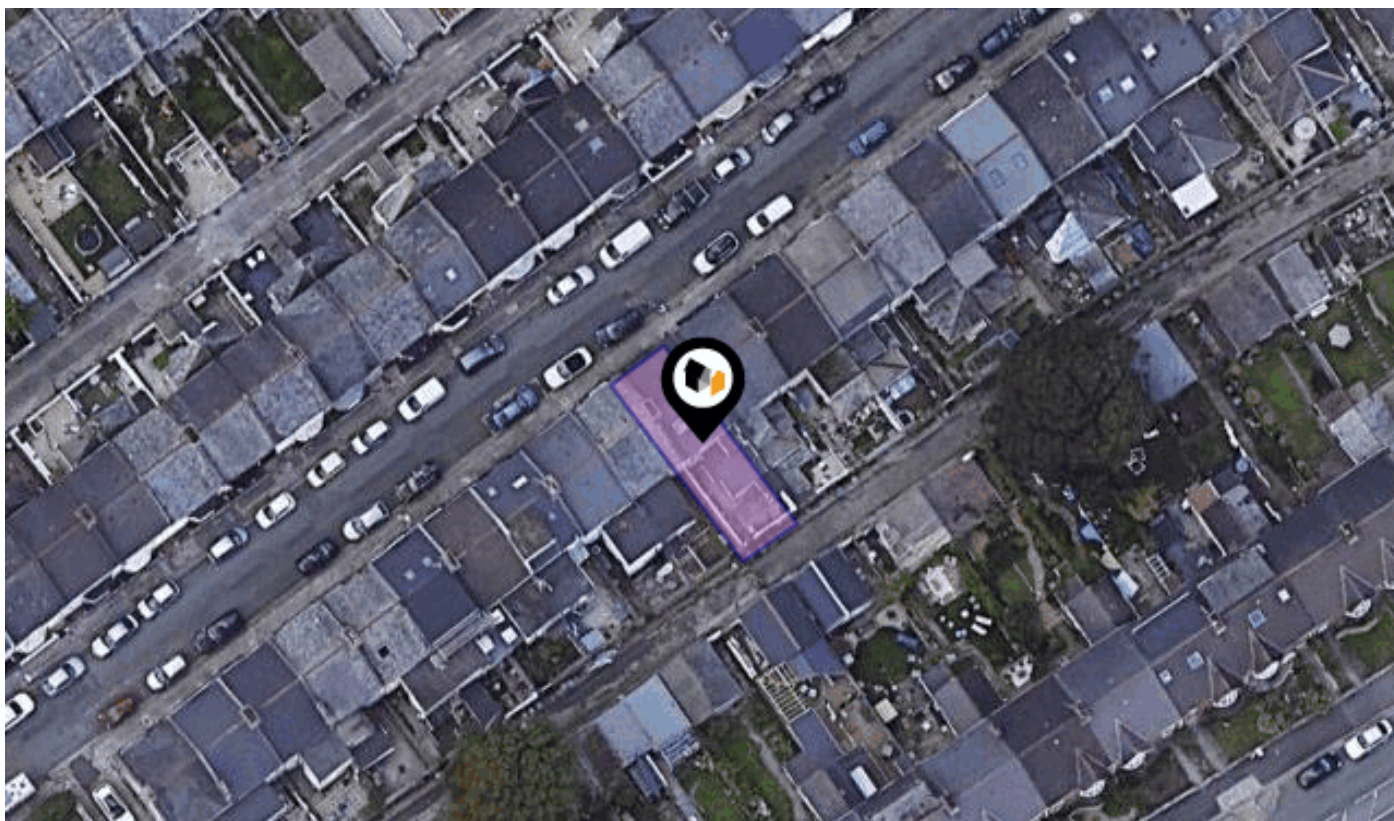

91, BEAUMONT STREET, PLYMOUTH, PL2 3AQ

Lang Town & Country

6 Mannamead Road, Plymouth, PL4 7AA

01752 456000

carrie@langtownandcountry.com

www.langtownandcountry.com



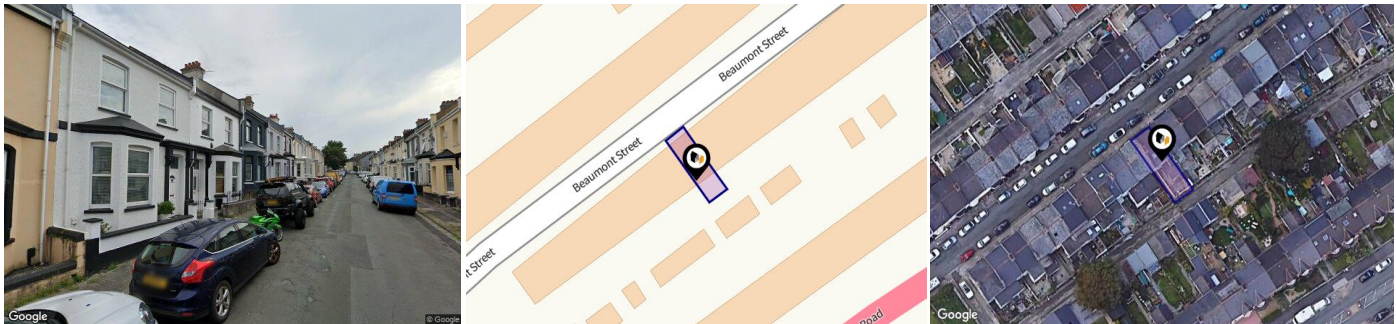

Property

Type:	Terraced	Last Sold Date:	21/03/2025
Bedrooms:	3	Last Sold Price:	£157,500
Floor Area:	1,743 ft ² / 162 m ²	Last Sold £/ft²:	£90
Plot Area:	0.03 acres	Tenure:	Freehold
Year Built :	1900-1929		
Council Tax :	Band B		
Annual Estimate:	£1,899		
Title Number:	DN31135		
UPRN:	100040412613		
Restrictive Covenants:	Yes		

Local Area

Local Authority:	City of plymouth
Conservation Area:	No
Flood Risk:	
• Rivers & Seas	Very low
• Surface Water	Very low

Estimated Broadband Speeds (Standard - Superfast - Ultrafast)

21 mb/s **1800** mb/s



Mobile Coverage: (based on calls indoors)



Satellite/Fibre TV Availability:



91, BEAUMONT STREET, PLYMOUTH, PL2 3AQ

GROUND FLOOR 58.59 sq. m.
(630.66 sq. ft.)

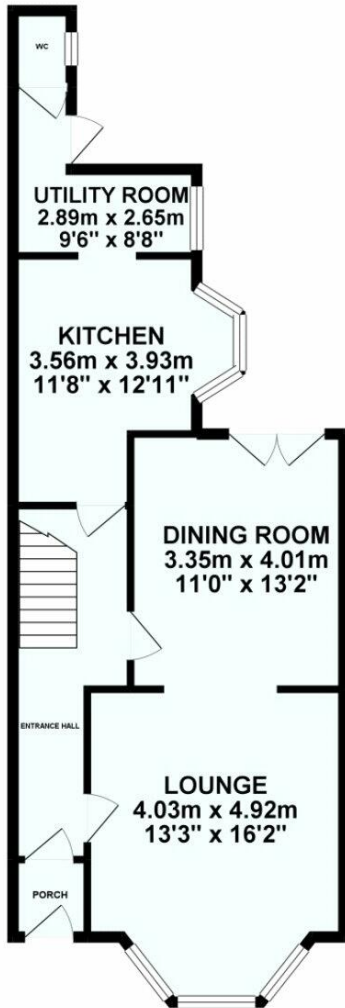

1ST FLOOR 44.91 sq. m.
(483.40 sq. ft.)

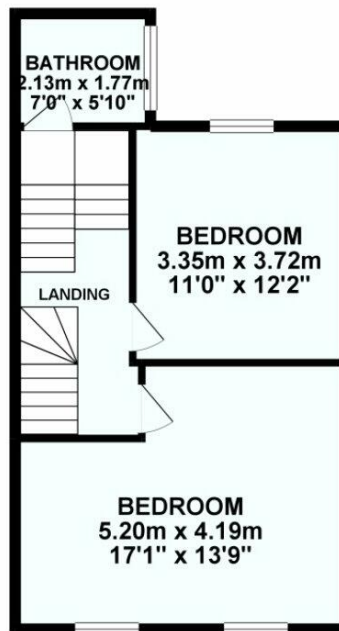

2ND FLOOR 29.55 sq. m.
(318.05 sq. ft.)

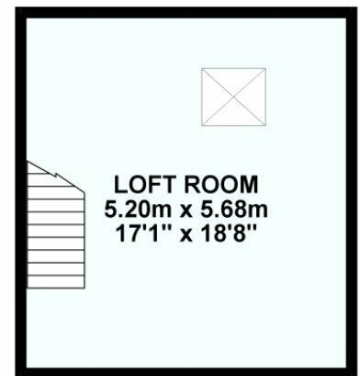

TOTAL FLOOR AREA : 133.05 sq. m. (1432.11 sq. ft.) approx.

Whilst every attempt has been made to ensure the accuracy of the floorplan contained here, measurements of doors, windows, rooms and any other items are approximate and no responsibility is taken for any error, omission or mis-statement. This plan is for illustrative purposes only and should be used as such by any prospective purchaser. The services, systems and appliances shown have not been tested and no guarantee as to their operability or efficiency can be given.

Made with Metropix ©2024

91, Beaumont Street, PL2 3AQ

Energy rating

E

Valid until 02.06.2029

Score	Energy rating	Current	Potential
92+	A		
81-91	B		
69-80	C		76 C
55-68	D		
39-54	E	40 E	
21-38	F		
1-20	G		

Additional EPC Data

Property Type:	House
Build Form:	Mid-Terrace
Transaction Type:	Rental (private)
Energy Tariff:	Single
Main Fuel:	Mains gas (not community)
Main Gas:	Yes
Glazing Type:	Double glazing, unknown install date
Previous Extension:	3
Open Fireplace:	1
Ventilation:	Natural
Walls:	Solid brick, as built, no insulation (assumed)
Walls Energy:	Very Poor
Roof:	Roof room(s), no insulation (assumed)
Roof Energy:	Very Poor
Main Heating:	Boiler and radiators, mains gas
Main Heating Controls:	Programmer, TRVs and bypass
Hot Water System:	From main system
Hot Water Energy Efficiency:	Good
Lighting:	Low energy lighting in 27% of fixed outlets
Floors:	Suspended, no insulation (assumed)
Total Floor Area:	162 m ²

This map displays nearby coal mine entrances and their classifications.



Mine Entry

- ✕ Adit
- ✕ Gutter Pit
- ✕ Shaft

The Coal Authority has records of over 175,000 mine entries within the UK captured in the National Coal Mining database, derived from sources including abandonment plans, geological and topographical plans.

Coal mining activity is recorded as far back as the 13th century, but prior to 1872 there was no requirement to deposit abandonment plans. It is therefore believed there may be many unrecorded mine entries of which the Authority has no information or knowledge. These entries do not, therefore, appear within the Authority's national dataset as shown on this map.

Maps

Conservation Areas

This map displays nearby official conservation areas. Every local authority in England has at least one conservation area. Most are designated by the Council as the local planning authority, though Historic England and the Secretary of State also have the power to create them.

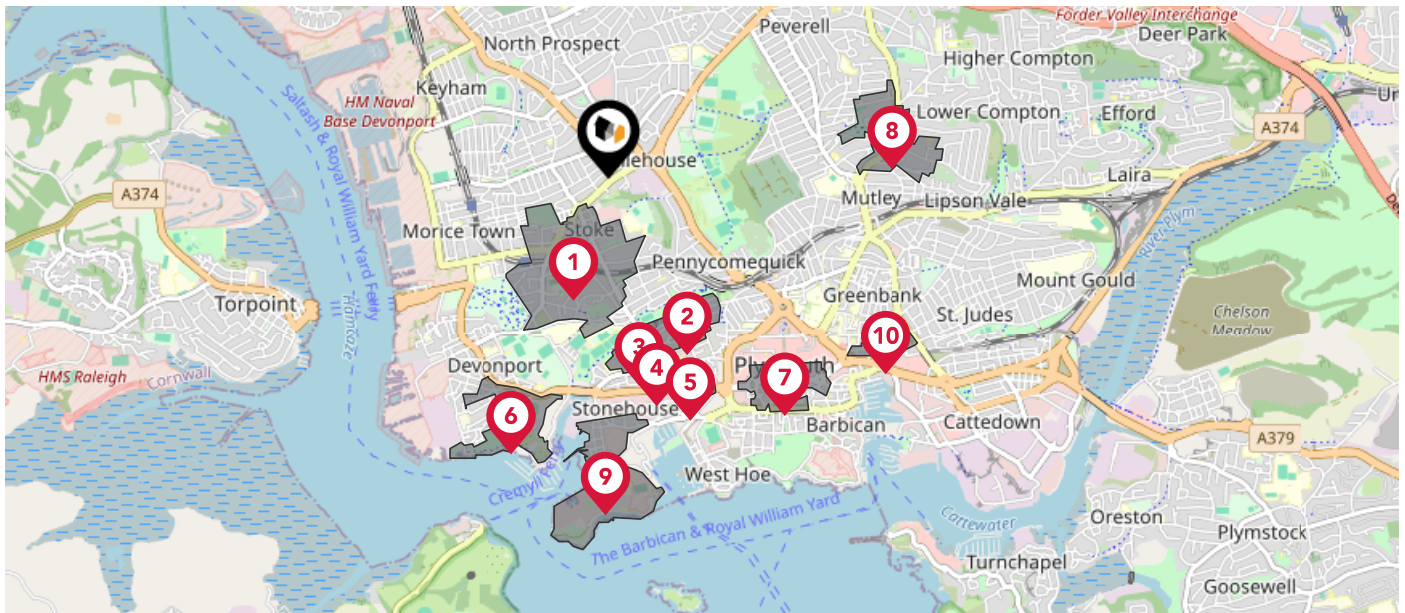







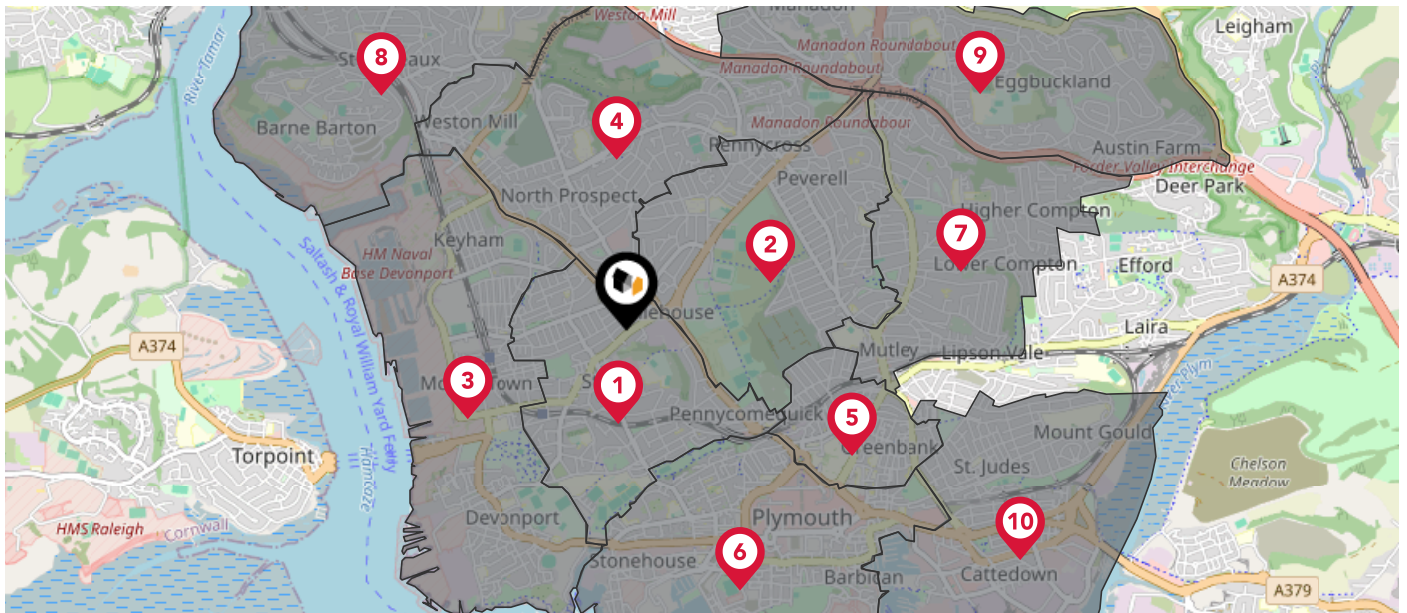



Nearby Conservation Areas

- 1 Stoke
- 2 North Stonehouse
- 3 Royal Naval Hospital
- 4 Adelaide Street/Clarence Place
- 5 Union Street
- 6 Devonport
- 7 City Centre
- 8 Mannamead
- 9 Stonehouse Peninsula
- 10 Ebrington Street

The UK is divided into wards that are used for local elections to elect local government councillors. Sometimes these are known as 'electoral divisions'. Population counts can vary substantially between wards, but the national average is about 5,500



Nearby Council Wards

-  Stoke Ward
-  Peverell Ward
-  Devonport Ward
-  Ham Ward
-  Drake Ward
-  St. Peter and the Waterfront Ward
-  Compton Ward
-  St. Budeaux Ward
-  Egguckland Ward
-  Sutton and Mount Gould Ward

This map displays the noise levels from nearby network rail and HS1 railway routes that affect this property...

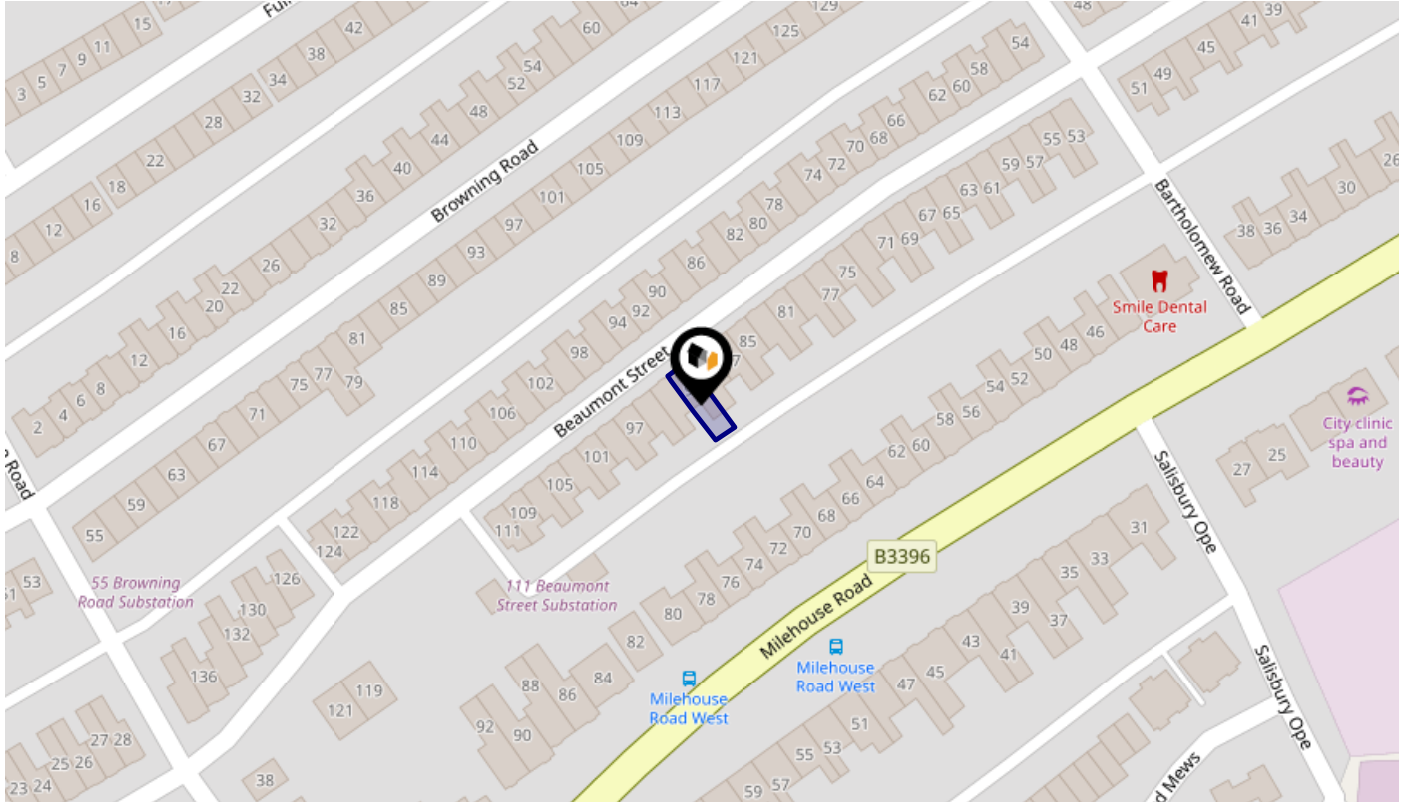

Rail Noise Data

This data indicates the level of noise according to the strategic noise mapping of rail sources within areas with a population of at least 100,000 people (agglomerations) and along Network Rail and HS1 traffic routes.

The data indicates the annual average noise levels for the 16-hour period between 0700 - 2300.

Noise levels are modelled on a 10m grid at a receptor height of 4m above ground, polygons are then produced by merging neighbouring cells within the following noise classes:

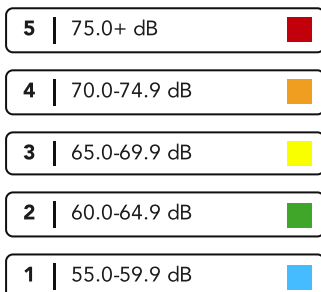

Flood Risk

Rivers & Seas - Flood Risk



This map shows the chance of flooding from rivers and / or the sea, taking into account flood defences and their condition.

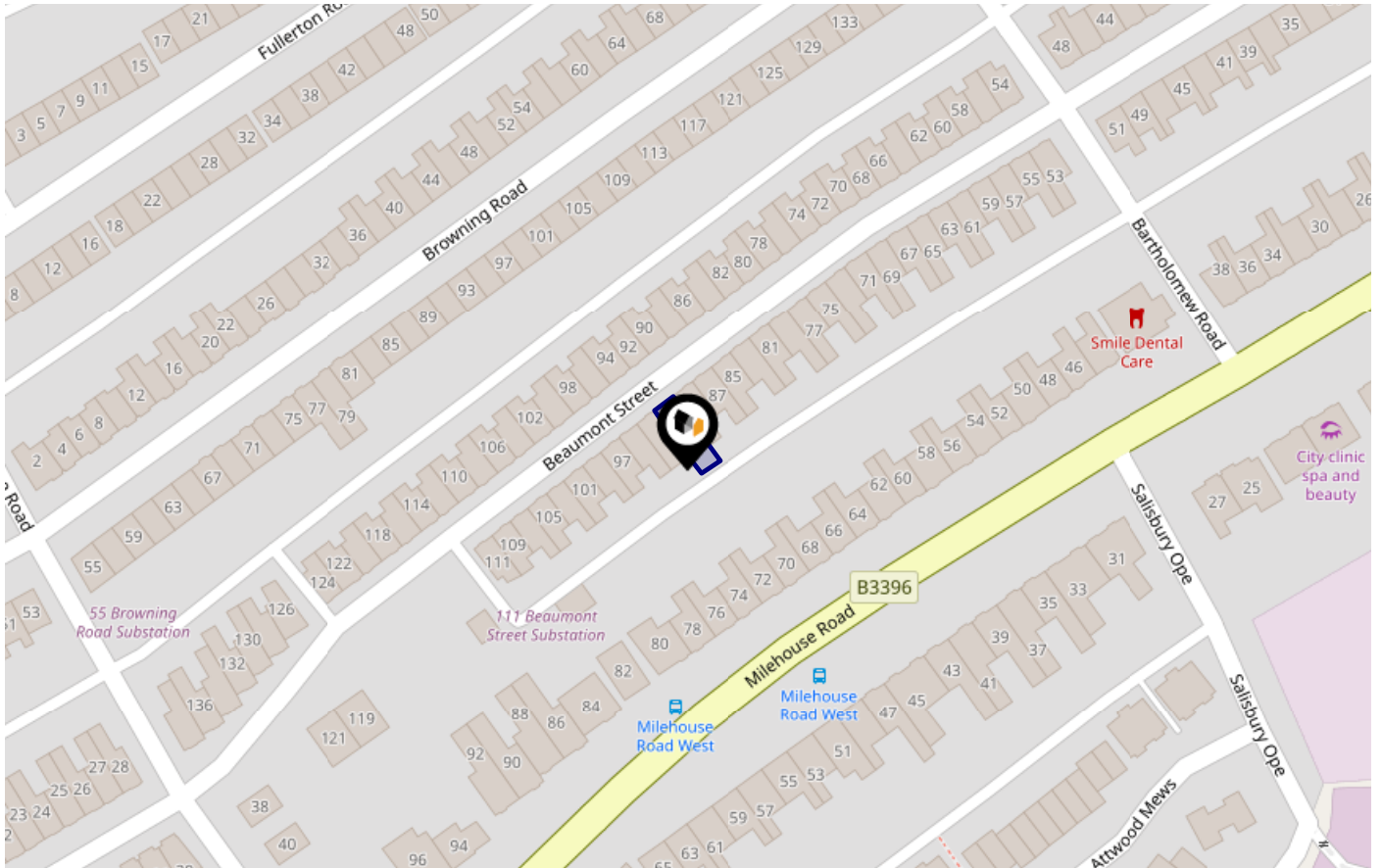

Risk Rating: Very low

The map does not contain sufficient information for it to be used to determine flood risk to individual properties, but it does give you an indication of whether your area may be affected by surface water flooding at this risk level.

- High Risk** - an area which has a chance of flooding of greater than 1 in 30 (3.3%) in any one year.
- Medium Risk** - an area which has a chance of flooding of greater than 1 in 100 (1.0%) in any one year.
- Low Risk** - an area which has a chance of flooding of greater than 1 in 1000 (0.1%) in any one year.
- Very Low Risk** - an area in which the risk is below 1 in 1000 (0.1%) in any one year.

Chance of flooding to the following depths at this property:



Flood Risk

Rivers & Seas - Climate Change



This map shows the future chance of flooding from rivers and / or the sea **between 2036 and 2069**, taking into account flood defences and their condition. The government climate change models cannot predict exactly when the chance of flooding will go up. It could happen at any time during the time period.

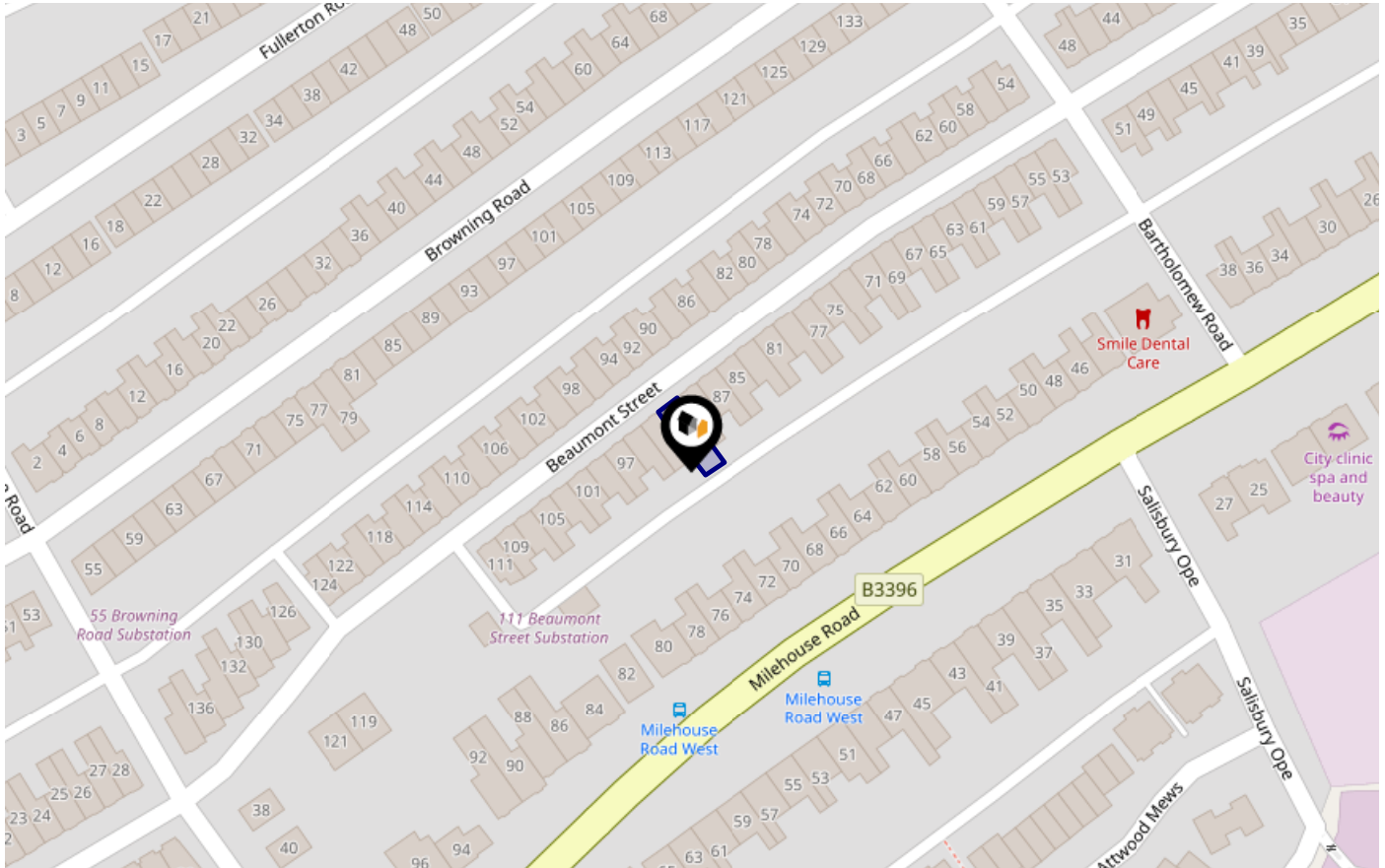

Risk Rating: Very low

The map does not contain sufficient information for it to be used to determine flood risk to individual properties, but it does give you an indication of whether your area may be affected by surface water flooding at this risk level.

- High Risk** - an area which has a chance of flooding of greater than 1 in 30 (3.3%) in any one year.
- Medium Risk** - an area which has a chance of flooding of greater than 1 in 100 (1.0%) in any one year.
- Low Risk** - an area which has a chance of flooding of greater than 1 in 1000 (0.1%) in any one year.
- Very Low Risk** - an area in which the risk is below 1 in 1000 (0.1%) in any one year.

Chance of flooding to the following depths at this property:



Flood Risk

Surface Water - Flood Risk



This map shows the chance of flooding where rainwater has nowhere to drain. This kind of flooding can occur far from rivers or seas.

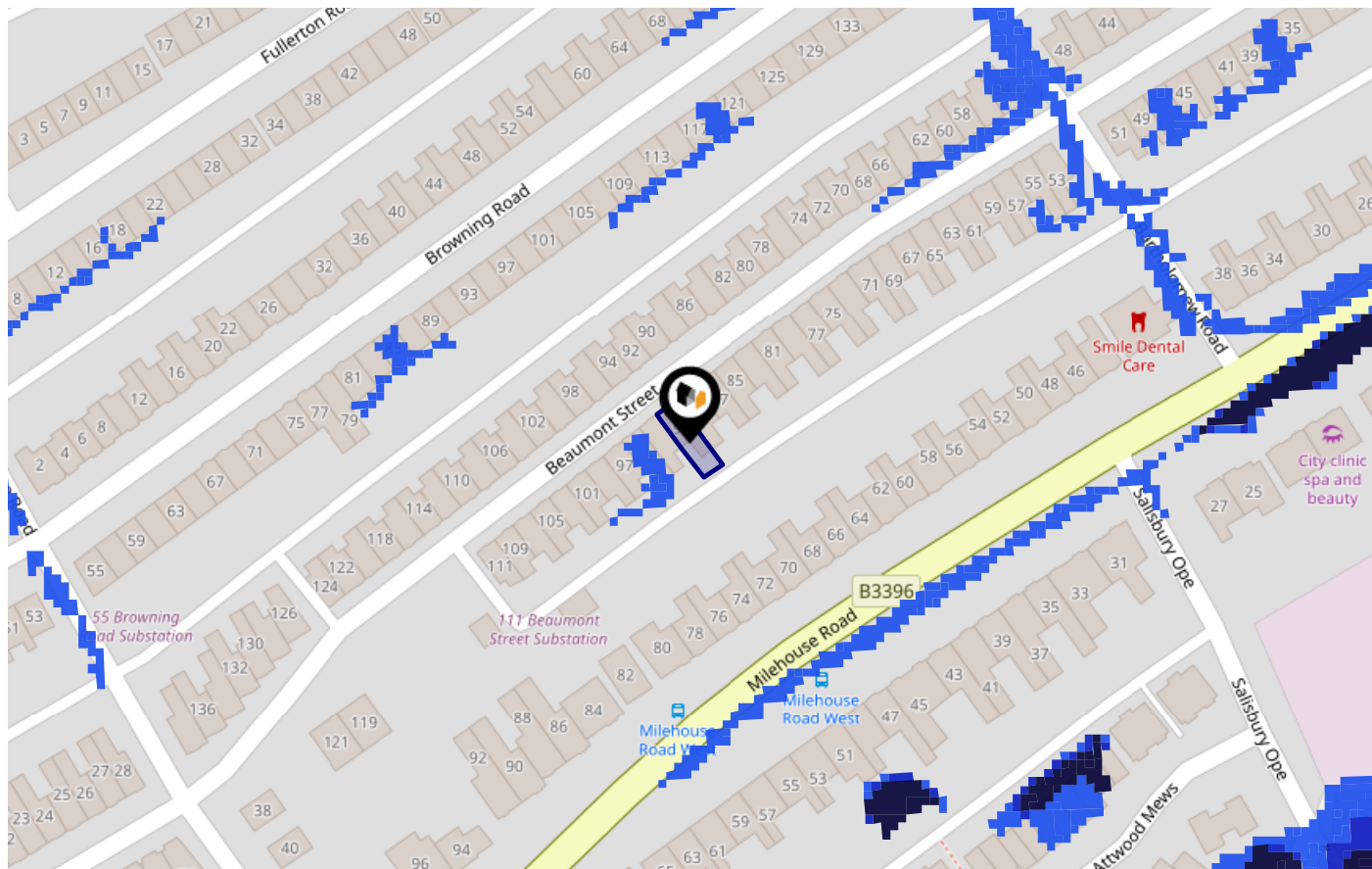

Risk Rating: Very low

The map does not contain sufficient information for it to be used to determine flood risk to individual properties, but it does give you an indication of whether your area may be affected by surface water flooding at this risk level.

- High Risk** - an area which has a chance of flooding of greater than 1 in 30 (3.3%) in any one year.
- Medium Risk** - an area which has a chance of flooding of greater than 1 in 100 (1.0%) in any one year.
- Low Risk** - an area which has a chance of flooding of greater than 1 in 1000 (0.1%) in any one year.
- Very Low Risk** - an area in which the risk is below 1 in 1000 (0.1%) in any one year.

Chance of flooding to the following depths at this property:

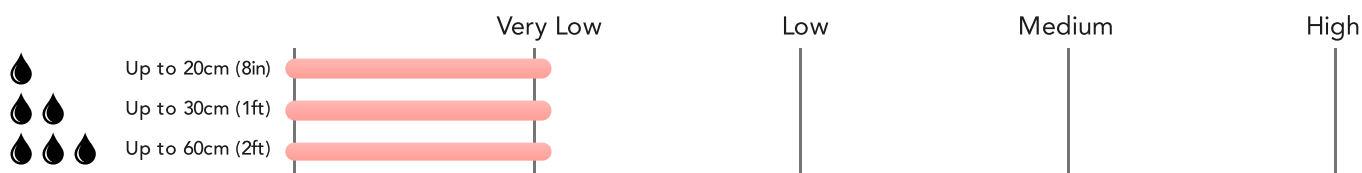

Flood Risk

Surface Water - Climate Change



This map shows the future chance of flooding **between 2040 and 2060** where rainwater has nowhere to drain. This kind of flooding can occur far from rivers or seas. The government climate change models cannot predict exactly when the chance of flooding will go up. It could happen at any time during the time period.

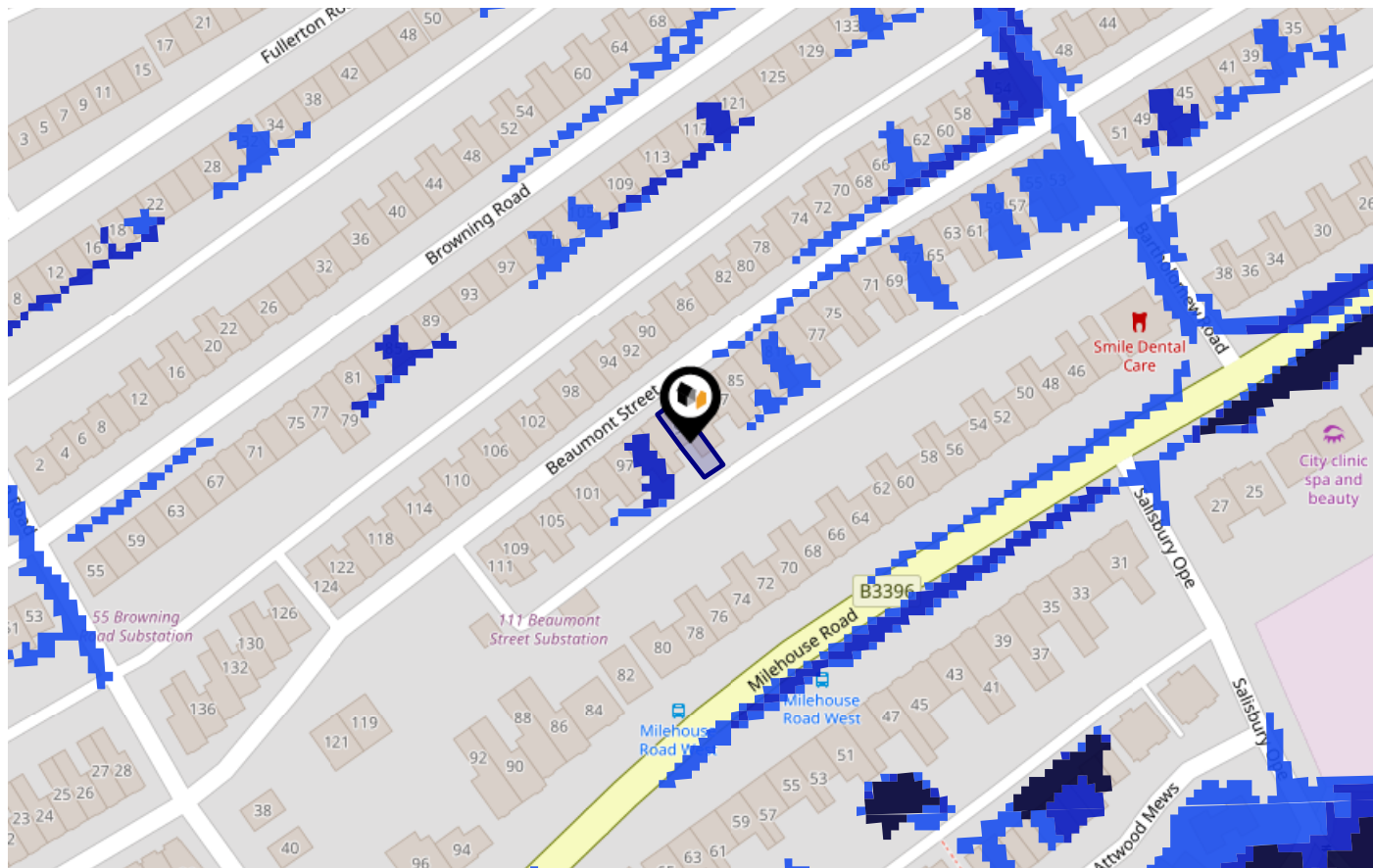

Risk Rating: Very low

The map does not contain sufficient information for it to be used to determine flood risk to individual properties, but it does give you an indication of whether your area may be affected by surface water flooding at this risk level.

- High Risk** - an area which has a chance of flooding of greater than 1 in 30 (3.3%) in any one year.
- Medium Risk** - an area which has a chance of flooding of greater than 1 in 100 (1.0%) in any one year.
- Low Risk** - an area which has a chance of flooding of greater than 1 in 1000 (0.1%) in any one year.
- Very Low Risk** - an area in which the risk is below 1 in 1000 (0.1%) in any one year.

Chance of flooding to the following depths at this property:

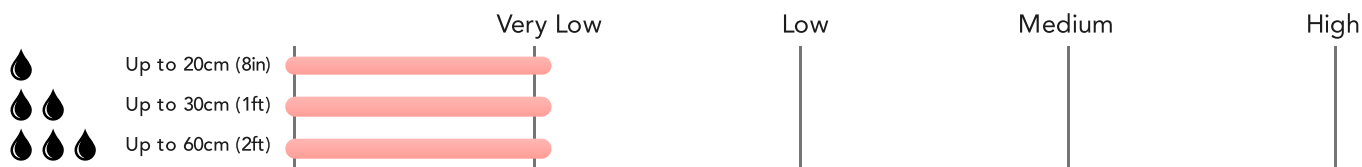

This map displays nearby areas that have been designated as Green Belt...

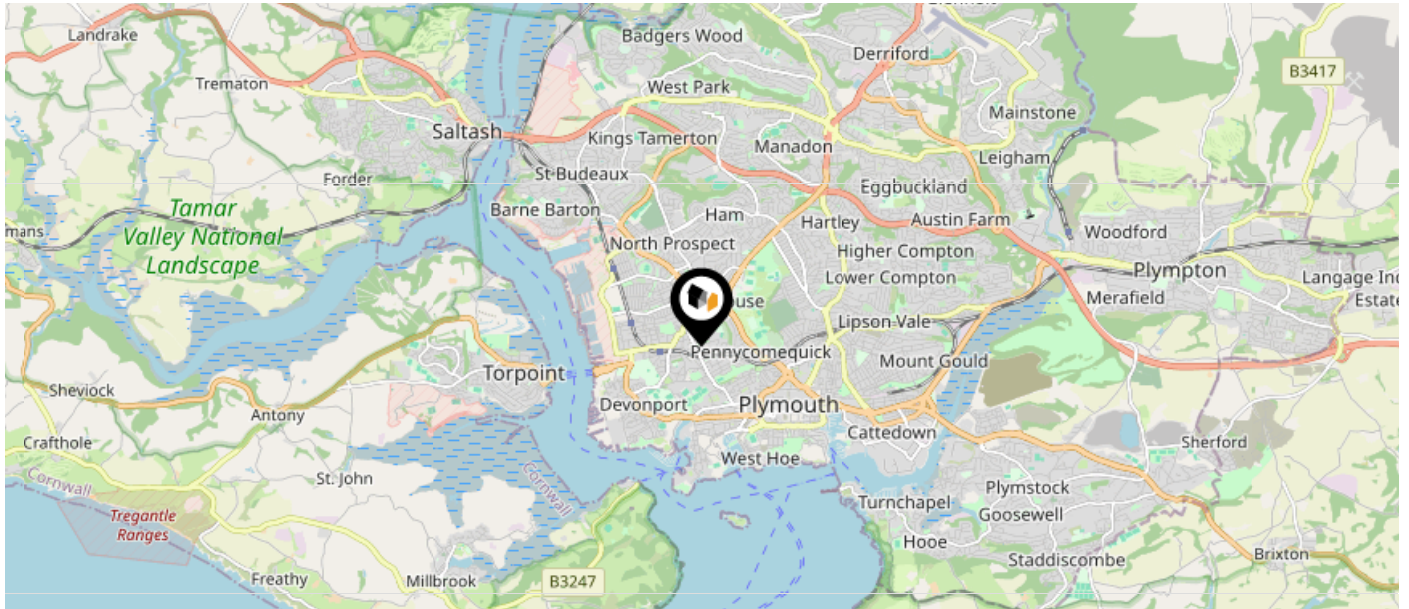

Nearby Green Belt Land

No data available.

This map displays the location of known landfill sites. Historic sites are where there is no environmental permit in force. Active sites are currently authorised by the Environment Agency under Environmental Permitting Regulations.

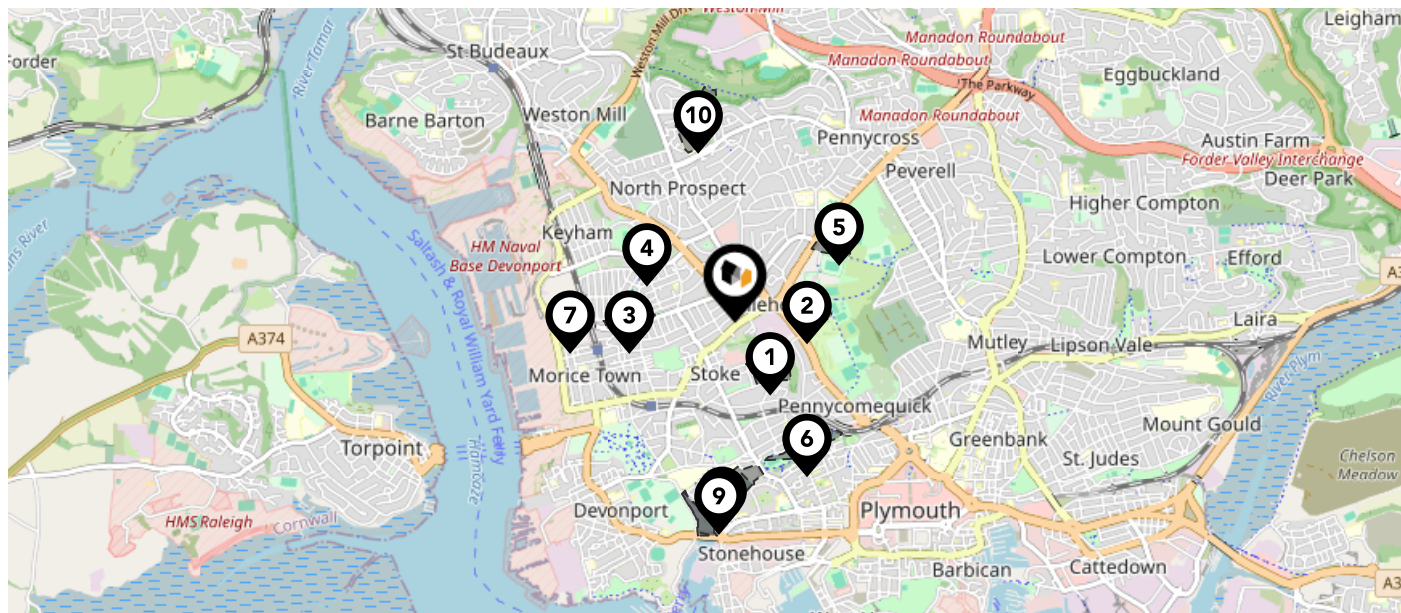

Nearby Landfill Sites

	Stoke School Playing Field And Allotments-Stoke School Playing Field And Allotments, Plymouth	Historic Landfill 
	Central Park Milehouse-Central Park (Milehouse), Plymouth	Historic Landfill 
	Recreation Ground St Levan Ground And Alexandra Road-Recreation Ground, St Levan Road, Plymouth	Historic Landfill 
	Disused Railway Cutting-North Down, Devonport, Plymouth	Historic Landfill 
	Peverell Cricket Ground-Peverell Cricket Ground, Plymouth	Historic Landfill 
	Victoria Park-Victoria Park, Plymouth	Historic Landfill 
	St Levan Road Recreation Ground-St Levan Road Recreation Ground, Devonport, Plymouth	Historic Landfill 
	Stonehouse Lake-Plymouth, Devon	Historic Landfill 
	Stonehouse Playing Fields-Stonehouse Playing Fields, Stonehouse, Plymouth, Devon	Historic Landfill 
	Ham-Ham, Plymouth	Historic Landfill 

Maps

Listed Buildings



This map displays nearby listed buildings and protected structures, as well as their listed tier and distance from the target property...



Listed Buildings in the local district		Grade	Distance
	1386318 - 3, Penlee Gardens	Grade II	0.3 miles
	1386320 - 6 And 7, Penlee Gardens	Grade II	0.3 miles
	1386327 - Lamp Standard Opposite Number 12	Grade II	0.3 miles
	1386326 - 12 And 13, Penlee Gardens	Grade II	0.3 miles
	1386323 - 10 And 11, Penlee Gardens	Grade II	0.3 miles
	1386250 - 102 And 104, Molesworth Road	Grade II	0.3 miles
	1386322 - 8 And 9, Penlee Gardens	Grade II	0.3 miles
	1386319 - 4 And 5, Penlee Gardens	Grade II	0.3 miles
	1386321 - Lamp Standard Opposite Number 7	Grade II	0.3 miles
	1386324 - Lamp Standard In Front Of Number 10	Grade II	0.3 miles

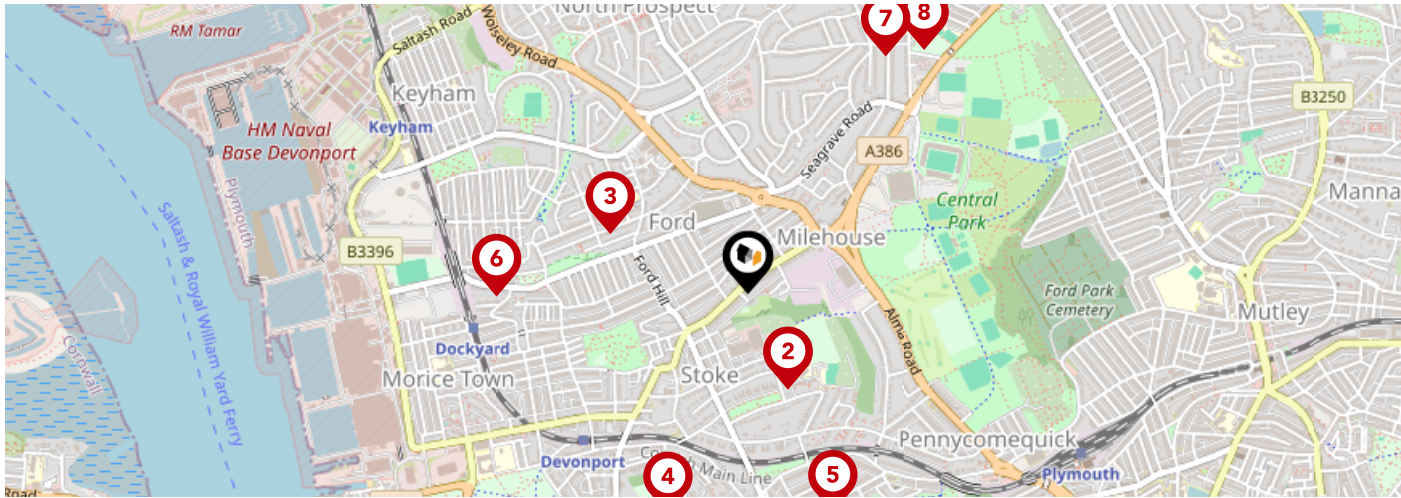

		Nursery	Primary	Secondary	College	Private
1	Scott Medical and Healthcare College Ofsted Rating: Good Pupils: 233 Distance:0.25	<input type="checkbox"/>	<input type="checkbox"/>	<input checked="" type="checkbox"/>	<input type="checkbox"/>	<input type="checkbox"/>
2	Stoke Damerel Community College Ofsted Rating: Good Pupils: 1301 Distance:0.25	<input type="checkbox"/>	<input type="checkbox"/>	<input checked="" type="checkbox"/>	<input type="checkbox"/>	<input type="checkbox"/>
3	Ford Primary School Ofsted Rating: Requires improvement Pupils: 214 Distance:0.35	<input type="checkbox"/>	<input checked="" type="checkbox"/>	<input type="checkbox"/>	<input type="checkbox"/>	<input type="checkbox"/>
4	Stoke Damerel Primary Academy Ofsted Rating: Good Pupils: 400 Distance:0.55	<input type="checkbox"/>	<input checked="" type="checkbox"/>	<input type="checkbox"/>	<input type="checkbox"/>	<input type="checkbox"/>
5	Stuart Road Primary Academy Ofsted Rating: Good Pupils: 189 Distance:0.56	<input type="checkbox"/>	<input checked="" type="checkbox"/>	<input type="checkbox"/>	<input type="checkbox"/>	<input type="checkbox"/>
6	College Road Primary School Ofsted Rating: Good Pupils: 204 Distance:0.6	<input type="checkbox"/>	<input checked="" type="checkbox"/>	<input type="checkbox"/>	<input type="checkbox"/>	<input type="checkbox"/>
7	Montpelier Primary School Ofsted Rating: Good Pupils: 652 Distance:0.65	<input type="checkbox"/>	<input checked="" type="checkbox"/>	<input type="checkbox"/>	<input type="checkbox"/>	<input type="checkbox"/>
8	Devonport High School for Girls Ofsted Rating: Good Pupils: 860 Distance:0.71	<input type="checkbox"/>	<input type="checkbox"/>	<input checked="" type="checkbox"/>	<input type="checkbox"/>	<input type="checkbox"/>

Area Schools

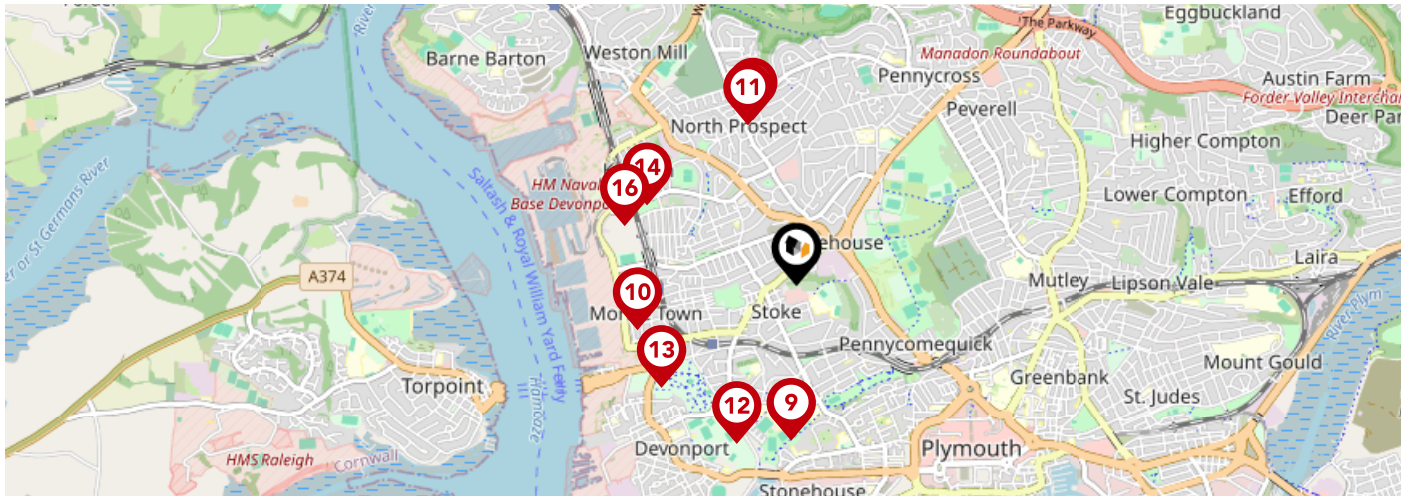

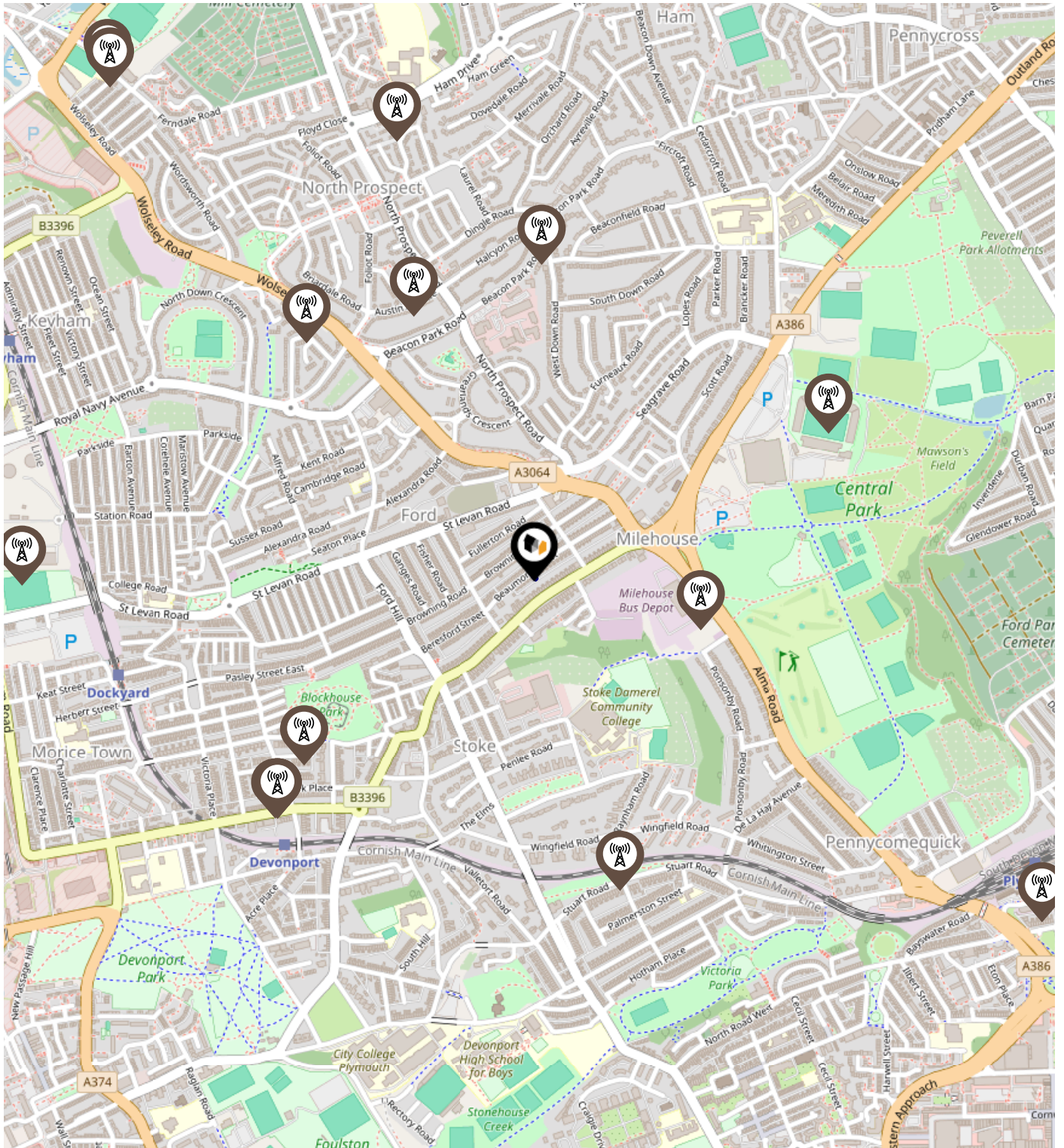

		Nursery	Primary	Secondary	College	Private
9	Devonport High School for Boys Ofsted Rating: Good Pupils: 1231 Distance:0.73	<input type="checkbox"/>	<input type="checkbox"/>	<input checked="" type="checkbox"/>	<input type="checkbox"/>	<input type="checkbox"/>
10	Morice Town Primary Academy Ofsted Rating: Good Pupils: 185 Distance:0.78	<input type="checkbox"/>	<input checked="" type="checkbox"/>	<input type="checkbox"/>	<input type="checkbox"/>	<input type="checkbox"/>
11	Mayflower Academy Ofsted Rating: Outstanding Pupils: 458 Distance:0.79	<input type="checkbox"/>	<input checked="" type="checkbox"/>	<input type="checkbox"/>	<input type="checkbox"/>	<input type="checkbox"/>
12	City College Plymouth Ofsted Rating: Good Pupils:0 Distance:0.79	<input type="checkbox"/>	<input type="checkbox"/>	<input checked="" type="checkbox"/>	<input type="checkbox"/>	<input type="checkbox"/>
13	UTC Plymouth Ofsted Rating: Good Pupils: 551 Distance:0.79	<input type="checkbox"/>	<input type="checkbox"/>	<input checked="" type="checkbox"/>	<input type="checkbox"/>	<input type="checkbox"/>
14	Keyham Barton Catholic Primary School Ofsted Rating: Good Pupils: 146 Distance:0.8	<input type="checkbox"/>	<input checked="" type="checkbox"/>	<input type="checkbox"/>	<input type="checkbox"/>	<input type="checkbox"/>
15	Ham Drive Nursery School and Day Care Ofsted Rating: Good Pupils: 78 Distance:0.81	<input checked="" type="checkbox"/>	<input type="checkbox"/>	<input type="checkbox"/>	<input type="checkbox"/>	<input type="checkbox"/>
16	Drake Primary Academy Ofsted Rating: Good Pupils: 173 Distance:0.86	<input type="checkbox"/>	<input checked="" type="checkbox"/>	<input type="checkbox"/>	<input type="checkbox"/>	<input type="checkbox"/>

Local Area Masts & Pylons



Key:

-  Power Pylons
-  Communication Masts

What is Radon?

Radon is a natural radioactive gas, which enters buildings from the ground. Exposure to high concentrations increases the risk of lung cancer. The UK Health Security Agency (UKHSA) recommends that radon levels should be reduced in homes where the annual average is at or above 200 becquerels per cubic metre (200 Bq/m³).

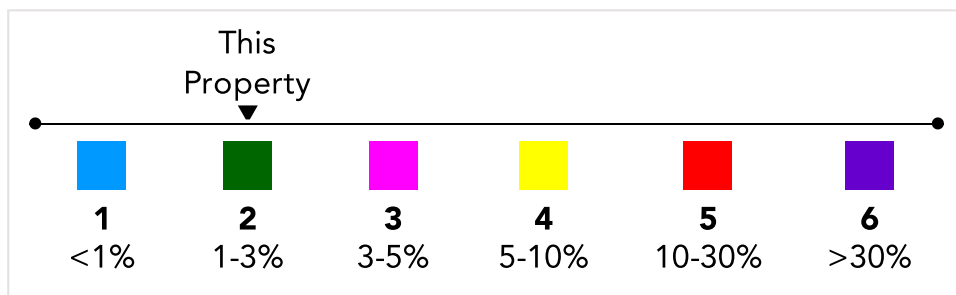
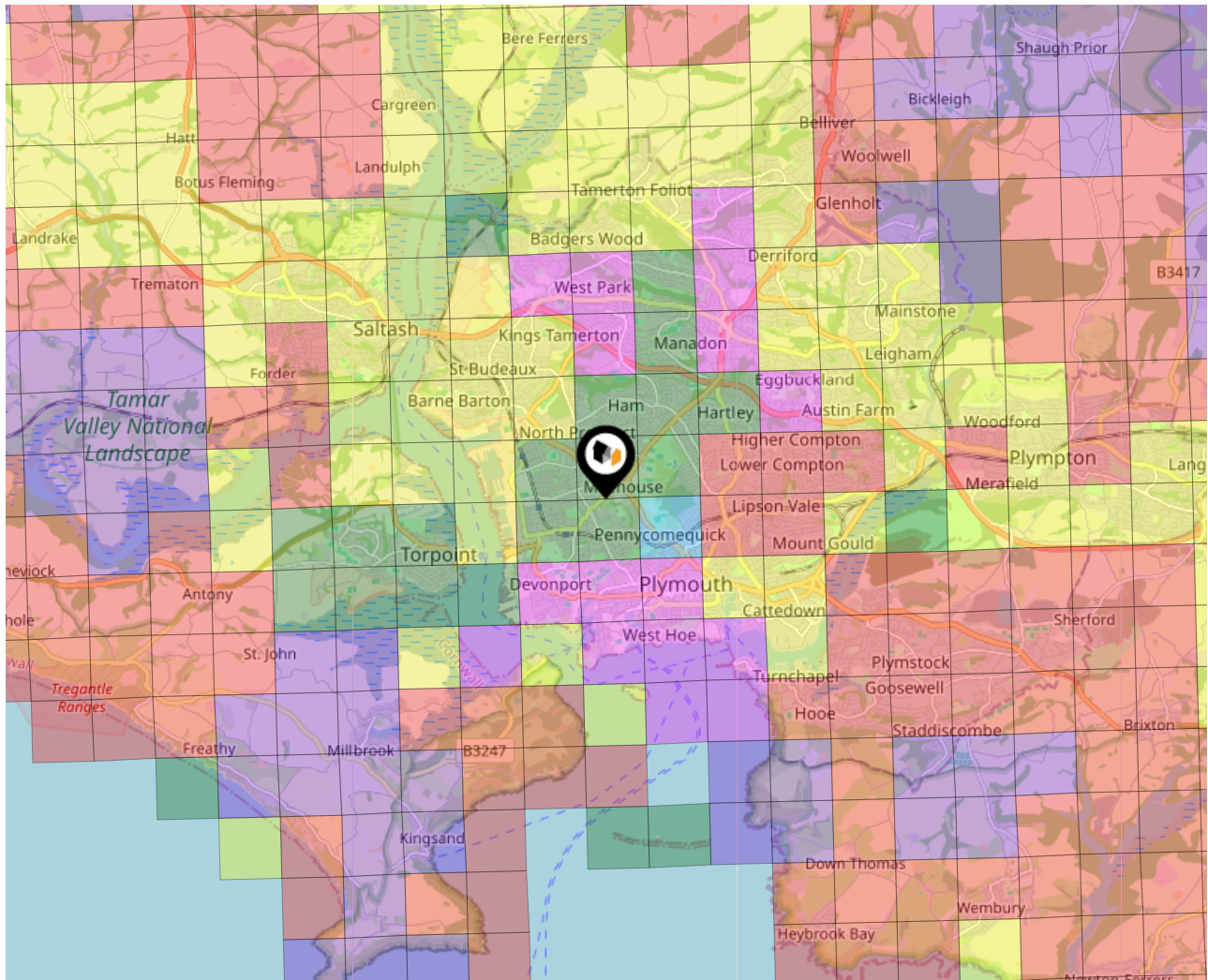

Local Area Road Noise

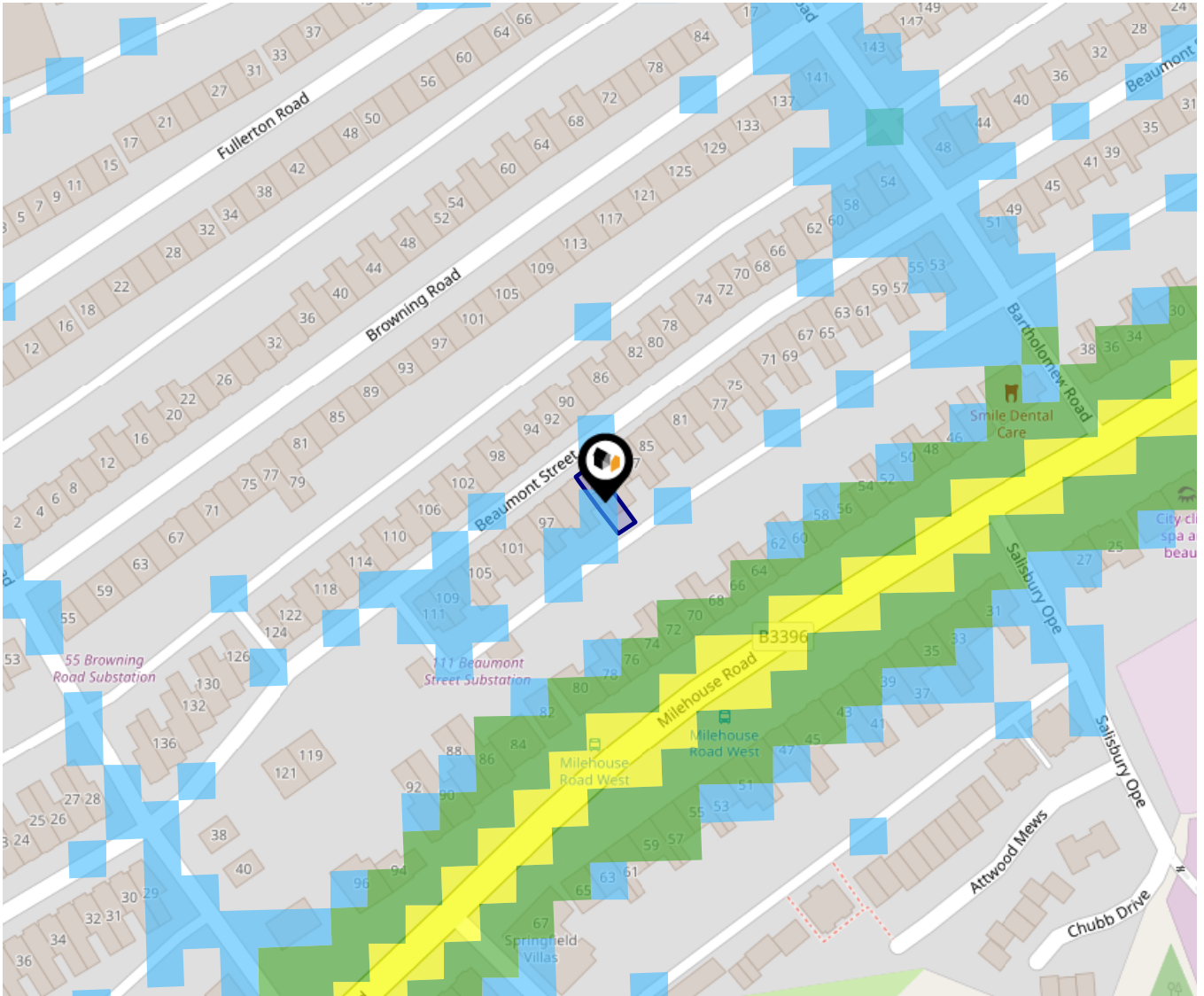

The data indicates the level of noise according to strategic noise sources across all traffic routes. This indicates a 25 house annual average noise level with separate weightings for the evening and the night periods.

- 75.0+ dB
- 70.0-74.9 dB
- 65.0-69.9 dB
- 60.0-64.9 dB
- 55.0-59.9 dB

Ground Composition for this Address (Surrounding square kilometer zone around property)

Carbon Content:	NONE	Soil Texture:	SILTY LOAM
Parent Material Grain:	ARGILLACEOUS	Soil Depth:	INTERMEDIATE-SHALLOW
Soil Group:	MEDIUM(SILTY)		

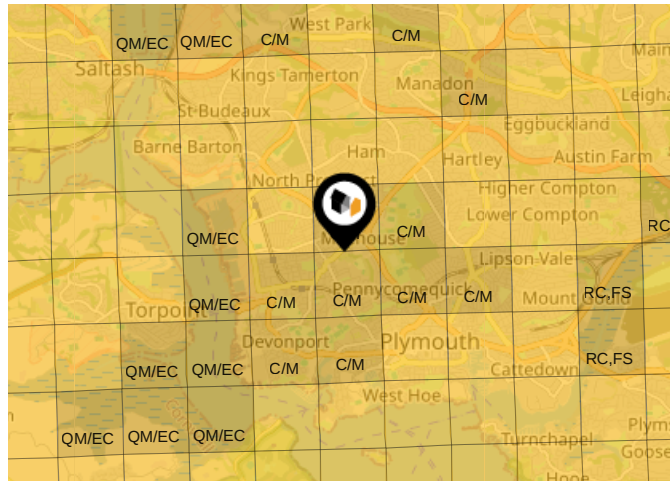

Primary Classifications (Most Common Clay Types)

C/M	Claystone / Mudstone
FPC,S	Floodplain Clay, Sand / Gravel
FC,S	Fluvial Clays & Silts
FC,S,G	Fluvial Clays, Silts, Sands & Gravel
PM/EC	Prequaternary Marine / Estuarine Clay / Silt
QM/EC	Quaternary Marine / Estuarine Clay / Silt
RC	Residual Clay
RC/LL	Residual Clay & Loamy Loess
RC,S	River Clay & Silt
RC,FS	Riverine Clay & Floodplain Sands and Gravel
RC,FL	Riverine Clay & Fluvial Sands and Gravel
TC	Terrace Clay
TC/LL	Terrace Clay & Loamy Loess

Area Transport (National)

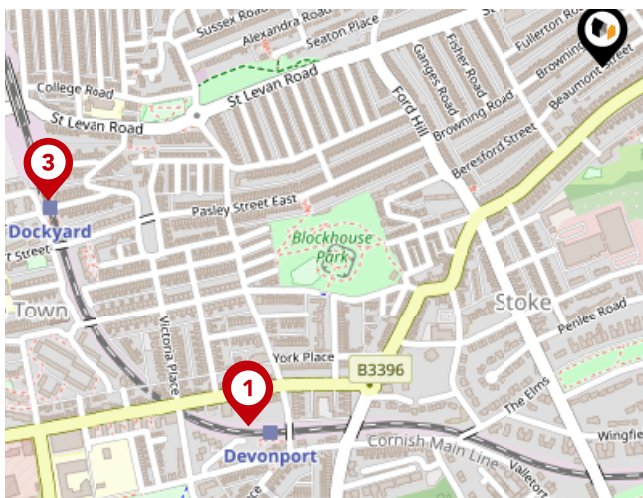

National Rail Stations

Pin	Name	Distance
1	Devonport Rail Station	0.59 miles
2	Devonport Rail Station	0.59 miles
3	Dockyard (Plymouth) Rail Station	0.67 miles

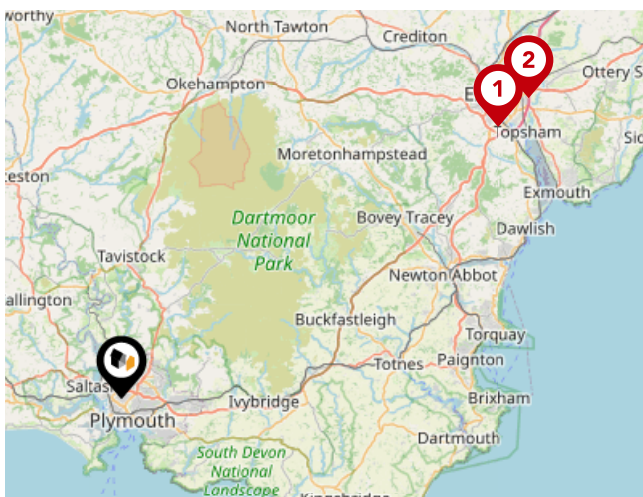

Trunk Roads/Motorways

Pin	Name	Distance
1	M5 J31	34.99 miles
2	M5 J30	38.13 miles

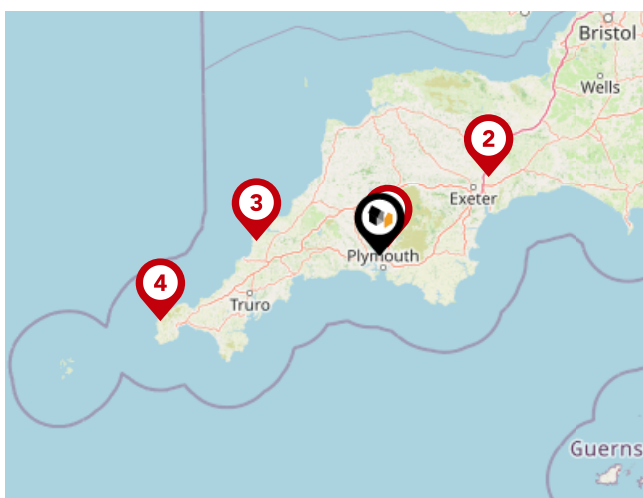

Airports/Helipads

Pin	Name	Distance
1	Glenholt	3.45 miles
2	Exeter Airport	40.56 miles
3	St Mawgan	37.45 miles
4	Joppa	69.44 miles

Area Transport (Local)

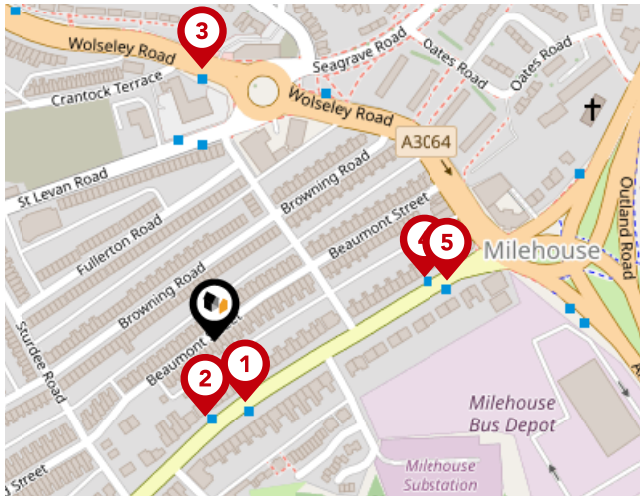

Bus Stops/Stations

Pin	Name	Distance
1	Milehouse Road West	0.04 miles
2	Milehouse Road West	0.04 miles
3	Queens House	0.16 miles
4	Milehouse Road East	0.13 miles
5	Milehouse Road East	0.14 miles

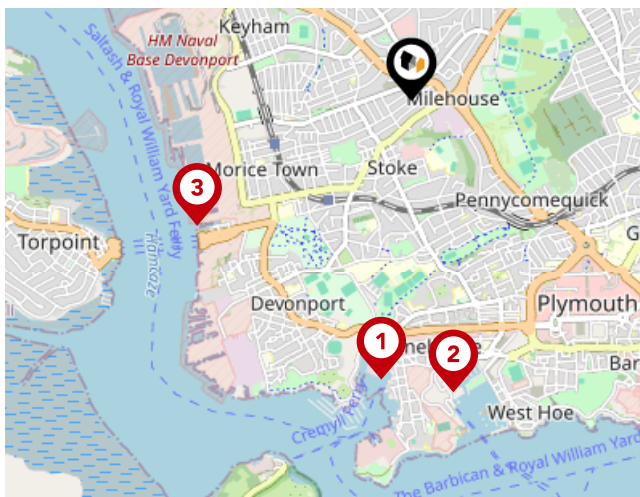

Ferry Terminals

Pin	Name	Distance
1	Plymouth Stonehouse Ferry Terminal	1.32 miles
2	Plymouth Ferry Terminal	1.39 miles
3	Devonport Ferry Terminal	1.17 miles

Lang Town & Country

Data Quality

We are committed to comprehensive property data being made available upfront to make the home buying and selling process quicker, easier and cheaper. This is why we have partnered with Sprift, the UK's leading supplier of property-specific data.



Contains public sector information licensed under the Open Government License v3.0

The information contained within this report is for general information purposes only.

Sprift Technologies Ltd aggregate this data from a wide variety of sources and while we endeavour to keep the information up to date and correct, we make no representations or warranties of any kind, express or implied, about the completeness, accuracy, reliability, of the information or related graphics contained within this report for any purpose.

Any reliance you place on such information is therefore strictly at your own risk. In no event will we be liable for any loss or damage including without limitation, indirect or consequential loss or damage, or any loss or damage whatsoever arising from loss of data or profits arising out of, or in connection with, the use of this report.



Lang Town & Country

6 Mannamead Road, Plymouth, PL4 7AA

01752 456000

carrie@langtownandcountry.com

www.langtownandcountry.com

