



Guide Price
£130,000

Leasehold

2x  1x  1x 

**Kingston House, 29-31
Kingston Crt,
Portsmouth, Hampshire,
PO2**

OVER 60?

Secure this property
for up to **59% less!**

cubitt & west
Helping you move forwards



Main features

- Perfect for first time buyers or investors
- Allocated parking space
- Close to local shops and transport links
- Open plan living with modern decor
- Lift in the building

Accommodation

FIRST FLOOR

Entrance Hallway

Lounge/Kitchen: 16'6 x 11'3 (5.03m x 3.43m)

Bedroom 1: 13'1 x 10'1 (3.99m x 3.08m)

Bedroom 2: 13'2 x 7'5 (4.02m x 2.26m)

Bathroom: 6'4 x 5'6 (1.93m x 1.68m)

OUTSIDE

Allocated Parking

First Floor

Approx. 40.5 sq. metres (436.4 sq. feet)

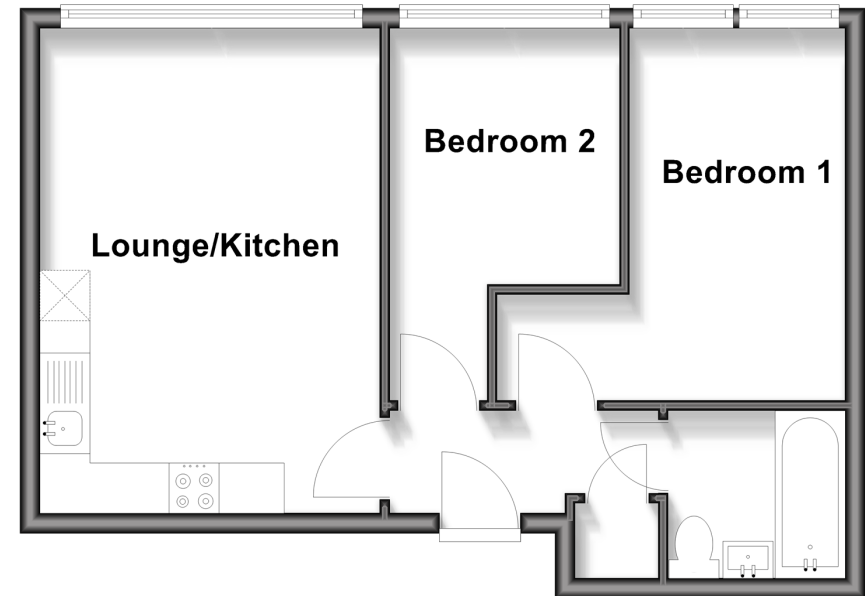

Call Portsmouth - 023 9266 1213 ■ cubittandwest.co.uk

- A private rental licensing scheme applies to some properties in this area, please check with the Local Authority before proceeding
- Appliances & services are untested, dimensions are approximate and floor plans are not to scale

- Legal advice should be taken to verify fixtures/fittings, planning, alterations and/or lease details
- Through a Homewise Home For Life Plan people aged 60+ can secure this property for up to 59% less, by purchasing a Lifetime Lease



41635221/20260210/MO1/JG