



HUNTERS[®]
HERE TO GET *you* THERE



HUNTERS[®]
HERE TO GET *you* THERE



HUNTERS[®]
HERE TO GET *you* THERE



HUNTERS[®]
HERE TO GET *you* THERE

4 Stirling Court Stirling Court, Nightingale Close, Chesterfield, S41 7NZ

- NO CHAIN
- FOR OVER 55'S
- LANDSCAPED GARDENS
- GROUND FLOOR APARTMENT
- TWO BEDROOMS
- VIEW NOW

Offers In The Region Of £120,000

HUNTERS[®]
HERE TO GET *you* THERE

GROUND FLOOR RETIREMENT APARTMENT FOR OVER 55'S - OFFERED WITH NO CHAIN - Situated within walking distance to Chesterfield Town Centre & train station.

This apartment comprises of: hallway, two bedrooms (one with fitted wardrobe), lounge / diner, fitted kitchen, and a three piece suite shower room.

BEAUTIFUL COMMUNAL LANDSCAPED GARDENS - ALL YEAR ROUND - ample parking is available in an adjacent parking court.

LEASEHOLD - The service charge is £276.47 per month. The lease term is 189 years from 01 January 2003. The monthly service charge which includes buildings insurance and access to the communal facilities. The service charge also understood to include on site Manager, Careline, access to a Guest Room for a small fee and servicing of the emergency call system. Prospective purchasers will require legal advice to confirm lease details.

We understand 1 small pet is permitted per property.

CALL HUNTERS TO VIEW NOW - BY APPOINTMENT ONLY

COUNCIL TAX BAND C | ELECTRIC STORAGE HEATERS





HUNTERS
HERE TO GET YOU THERE



HUNTERS
HERE TO GET YOU THERE



HUNTERS
HERE TO GET YOU THERE



HUNTERS
HERE TO GET YOU THERE

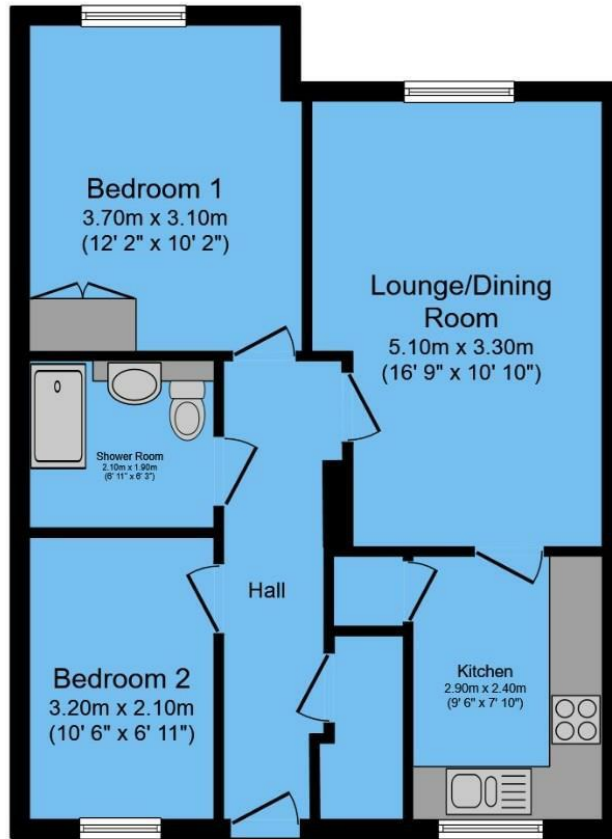

ENERGY PERFORMANCE CERTIFICATE

The energy efficiency rating is a measure of the overall efficacy of a home. The higher the rating the more energy efficient the home is and the lower the fuel bills will be.

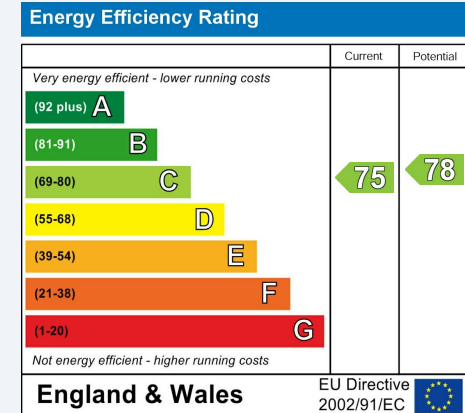

These particulars are intended to give a fair and reliable description of the property but no responsibility for any inaccuracy or error can be accepted and do not constitute an offer or contract. We have not tested any services or appliances (including central heating if fitted) referred to in these particulars and the purchasers are advised to satisfy themselves as to the working order and condition. If a property is unoccupied at any time there may be reconnection charges for any switched off/disconnected or drained services or appliances - All measurements are approximate.

THINKING OF SELLING? If you are thinking of selling your home or just curious to discover the value of your property, Hunters would be pleased to provide free, no obligation sales and marketing advice. Even if your home is outside the area covered by our local offices we can arrange a Market Appraisal through our national network of Hunters estate agents.

Total floor area 55.4 sq.m. (596 sq.ft.) approx

This floor plan is for illustrative purposes only. It is not drawn to scale. Any measurements, floor areas (including any total floor area), openings and orientation are approximate. No details are guaranteed, they cannot be relied upon for any purpose and they do not form part of any agreement. No liability is taken for any error, omission or misstatement. A party must rely upon its own inspection(s).

Powered by www.focalagent.com

Viewing

Please contact our Hunters Chesterfield Office on 01246 540540 if you wish to arrange a viewing appointment for this property or require further information.



Unit 4, The Glass Yard Sheffield Road, Chesterfield, S41 8JY

Tel: 01246 540540 Email:

Chesterfield@hunters.com <https://www.hunters.com>