

HUNTERS[®]

HERE TO GET *you* THERE



May Avenue

Northfleet, DA11 8RH

£1,300 Per Month

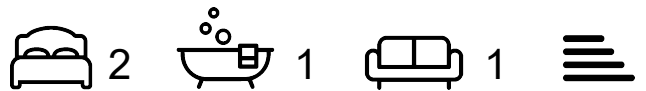

A well maintained two bedroom terrace house located in a sought after location and comprising of a good size living room opening onto the kitchen / dining area, ground floor bathroom with shower cubicle, two double bedrooms and an enclosed courtyard garden. Situated close to local amenities on Perry Street as well as Gravesend town centre, railway station and motorway connections. AVAILABLE FROM JANUARY 2026.



Area Map



Floor Plans

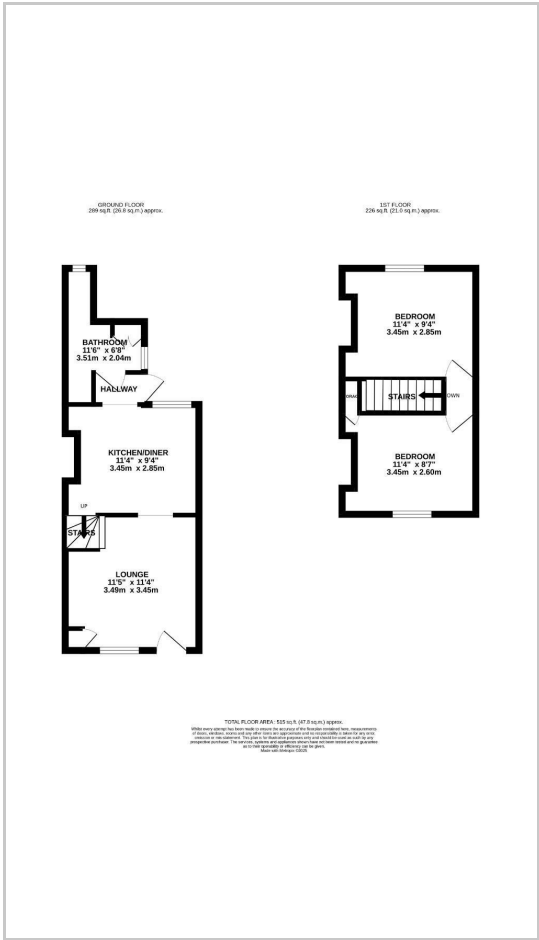

Energy Efficiency Graph



These particulars are intended to give a fair and reliable description of the property but no responsibility for any inaccuracy or error can be accepted and do not constitute an offer or contract. We have not tested any services or appliances (including central heating if fitted) referred to in these particulars and the purchasers are advised to satisfy themselves as to the working order and condition. If a property is unoccupied at any time there may be reconnection charges for any switched off/disconnected or drained services or appliances - All measurements are approximate. **THINKING OF SELLING?** If you are thinking of selling your home or just curious to discover the value of your property, Hunters would be pleased to provide free, no obligation sales and marketing advice. Even if your home is outside the area covered by our local offices we can arrange a Market Appraisal through our national network of Hunters estate agents.