



Adams

Cliffe Road WA4

£575,000

4 2 3



Beautiful 4-Bedroom Semi-Detached Home – Sought-After Appleton Location

Located in the highly desirable area of Appleton, this spacious 4-bedroom semi-detached property offers the perfect blend of modern family living and stylish design.

Key features:

- Four generous bedrooms, including one with en-suite
- Bright and spacious lounge
- Separate dining room and conservatory
- Modern kitchen diner
- Downstairs W/C
- Large welcoming hallway with stunning feature window
- Stylish family bathroom
- Well-maintained rear garden – ideal for families and entertaining
- Garage and private driveway providing off-road parking
- Quiet, sought-after residential location

This fantastic home is well laid out for family life, with multiple reception areas and a versatile layout. The standout garden offers plenty of outdoor space, while the large hallway and feature window add a real sense of character. The addition of a garage and driveway provides practical parking solutions for families or visiting guests.

Located close to excellent local schools, transport links, and Appleton's popular amenities, this property offers both convenience and a great community feel.

Early viewing is highly recommended – properties in this area rarely stay on the market for long.

Viewing

By prior appointment through our Stockton Heath office on 01925-398343.



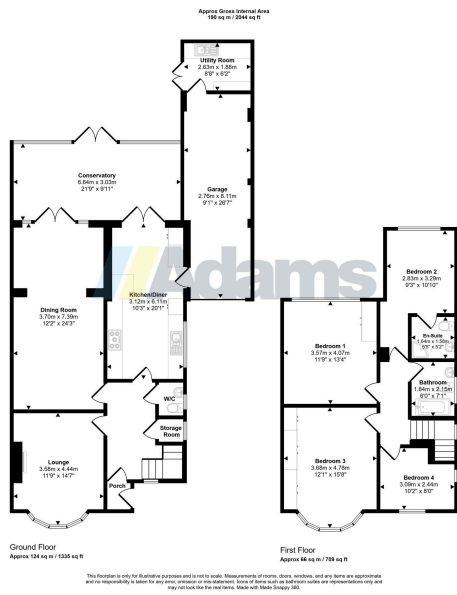

- Four Spacious Bedrooms
- Bright And Airy Conservatory
- Modern Kitchen Diner
- Separate Dining Room
- Generous Lounge
- Large Entrance Hallway
- Downstairs W/C
- Driveway Parking
- Garage
- Well-Maintained, Large Rear Garden

