



**Bagge Road, Gaywood, King's Lynn, PE30 4NL**

**welcome to**

**Bagge Road, Gaywood, King's Lynn**

William H Brown are delighted to offer to market this well presented, spacious three bedroom semi detached home with conservatory, downstairs cloakroom/ utility and family bathroom. Located in a popular area close to local amenities. Viewing highly recommended!



## Entrance Hall

## Lounge

19' 6" x 10' 11" ( 5.94m x 3.33m )

Window to Front, Fireplace, Radiator

## Kitchen/Diner

16' 2" x 9' 8" ( 4.93m x 2.95m )

Wall and Base Unit, Sink and Mixer Tap, Space for Cooker, Space for Dishwasher, Space for Freestanding Fridge/Freezer, Window to Rear, Door to Conservatory

## Cloakroom/Utility

6' 3" x 5' 9" ( 1.91m x 1.75m )

Wall and Base Units, Sink with drainer and Mixer Tap, WC, Space for Washing Machine and Tumble Dryer, Radiator

## Conservatory

Sliding Door To Rear Garden

## Bedroom One

11' 11" x 8' 8" ( 3.63m x 2.64m )

Window to Front, Radiator

## Bedroom Two

11' 1" x 10' 10" ( 3.38m x 3.30m )

Window to Rear, Radiator

## Bedroom Three

10' 8" max x 9' 8" max ( 3.25m max x 2.95m max )

Window to Front, Radiator

## Bathroom

Bath, Shower, WC, Hand Wash Basin, Radiator,

Window to Rear

## Outside

Enclosed Rear Garden, with Slabbed Patio Area and Remainder Laid to Lawn



Ground Floor

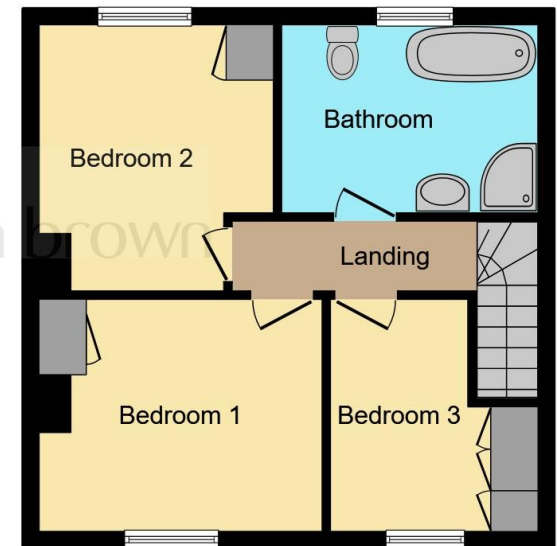

First Floor

This floor plan is for illustrative purposes only. It is not drawn to scale. Any measurements, floor areas (including any total floor area), openings and orientation are approximate. No details are guaranteed, they cannot be relied upon for any purpose and they do not form part of any agreement. No liability is taken for any error, omission or misstatement. A party must rely upon its own inspection(s). Powered by [www.focalagent.com](http://www.focalagent.com)



**view this property online** [williamhbrown.co.uk/Property/KLN119522](http://williamhbrown.co.uk/Property/KLN119522)



welcome to

## Bagge Road, Gaywood, King's Lynn

- Semi Detached Home
- Three Well Proportioned Bedrooms
- Lounge & Kitchen/ Diner
- Family Bathroom & Downstairs Cloakroom/ Utility
- Enclosed Rear Garden

Tenure: Freehold EPC Rating: C  
Council Tax Band: A

# £220,000



Please note the marker reflects the postcode not the actual property

**view this property online** [williambrown.co.uk/Property/KLN119522](https://www.williambrown.co.uk/Property/KLN119522)



Property Ref:  
KLN119522 - 0004

1. MONEY LAUNDERING REGULATIONS Intending purchasers will be asked to produce identification documentation at a later stage and we would ask for your co-operation in order that there is no delay in agreeing the sale. 2. These particulars do not constitute part or all of an offer or contract. 3. The measurements indicated are supplied for guidance only and as such must be considered incorrect. Potential buyers are advised to recheck measurements before committing to any expense. 4. We have not tested any apparatus, equipment, fixtures or services and it is in the buyers interest to check the working condition of any appliances. 5. Where an EPC, or a Home Report (Scotland only) is held for this property, it is available for inspection at the branch by appointment. If you require a printed version of a Home Report, you will need to pay a reasonable production charge reflecting printing and other costs. 6. We are not able to offer an opinion either written or verbal on the content of these reports and this must be obtained from your legal representative. 7. Whilst we take care in preparing these reports, a buyer should ensure that his/her legal representative confirms as soon as possible all matters relating to title including the extent and boundaries of the property and other important matters before exchange of contracts.

William H Brown is a trading name of Sequence (UK) Limited which is registered in England and Wales under company number 4268443, Registered Office is Cumbria House, 16-20 Hockliffe Street, Leighton Buzzard, Bedfordshire, LU7 1GN. VAT Registration Number is 500 2481 05.



william h brown



**01553 771337**



[KingsLynn@williambrown.co.uk](mailto:KingsLynn@williambrown.co.uk)



40-42 King Street, KING'S LYNN, Norfolk, PE30 1ES



[williambrown.co.uk](https://www.williambrown.co.uk)