



R B WALTERS
ESTATE AGENTS



*Didbrook Mews, Abbeymead, Gloucester,
Gloucestershire, GL4 4SJ.*

£220,000

Being sold chain free and located at the end of a small residential close this home is an ideal first time buy or investment purchase and comes complete with up to date gas safety and electrical inspection certificates.

In a popular part of Gloucester this is a two double bedroom terraced home with off road parking for two cars. The property has a living room and kitchen/diner on the ground floor and then the 2 bedrooms and bathroom on the first floor.

Outside there is off road tandem parking at the front and an enclosed rear garden.

Services

Mains Gas Central Heating

Electric

Mains Water and Drainage

Broadband Available

Living Room

15' 4" x 11' 9" (4.67m x 3.58m)

Kitchen/Diner

11' 9" x 9' 2" (3.58m x 2.79m)

First Floor Landing

Bedroom

11' 9" x 9' 1" (3.58m x 2.77m)

Bedroom

11' 9" x 7' 3" (3.58m x 2.21m)

Bathroom

8' 0" x 4' 7" (2.44m x 1.40m)

Outside

Tandem Parking for Two Cars

Rear Garden





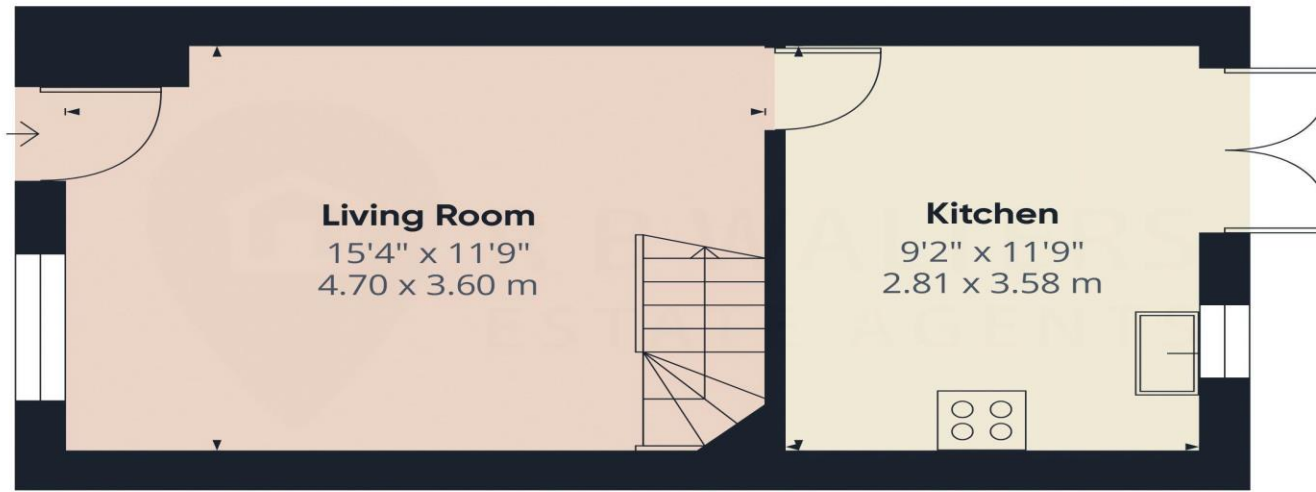

Ground Floor

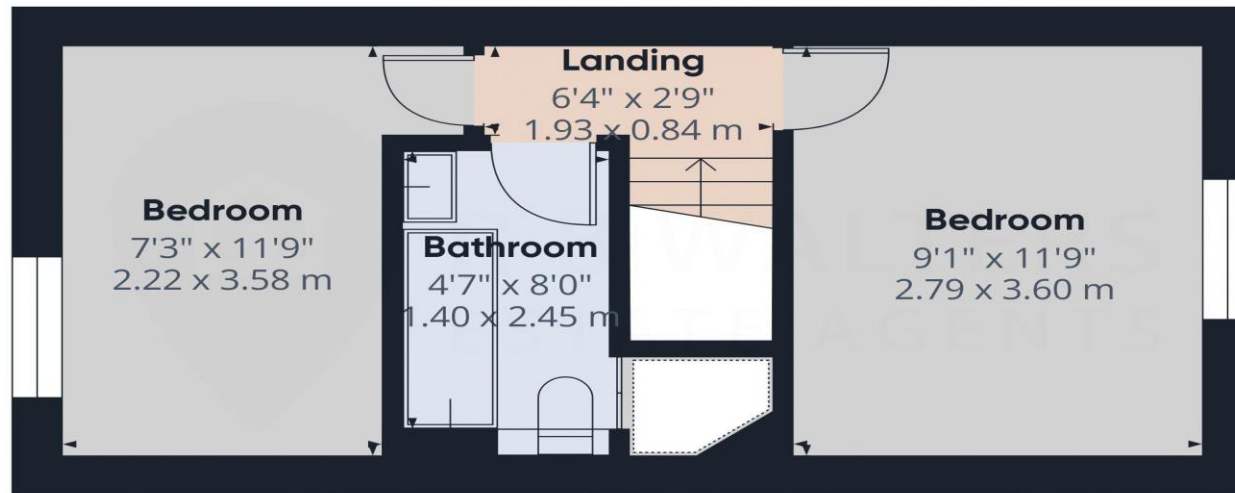

Floor 1



Approximate total area⁽¹⁾

548 ft²
50.9 m²

Reduced headroom

6 ft²
0.6 m²

(1) Excluding balconies and terraces

Reduced headroom
..... Below 5 ft/1.5 m

Calculations reference the RICS IPMS 3C standard. Measurements are approximate and not to scale. This floor plan is intended for illustration only.

GIRAFFE360