



Meadway, KT5

£465,000

This mid-terrace house has a kitchen/dining room, two reception rooms, three spacious bedrooms and a large landscaped rear garden. This property further benefits from the potential to extend (STPP).

Meadway has easy access to the A3 and is conveniently less than half a mile away from Tolworth train station and a vast selection of local shops, bars and restaurants.

Features

Mid Terrace Property
Three Bedrooms
Multiple Reception Rooms
Downstairs Shower Room
No Onward Chain
Potential to Extend (STPP)

Meadway, Surbiton, KT5

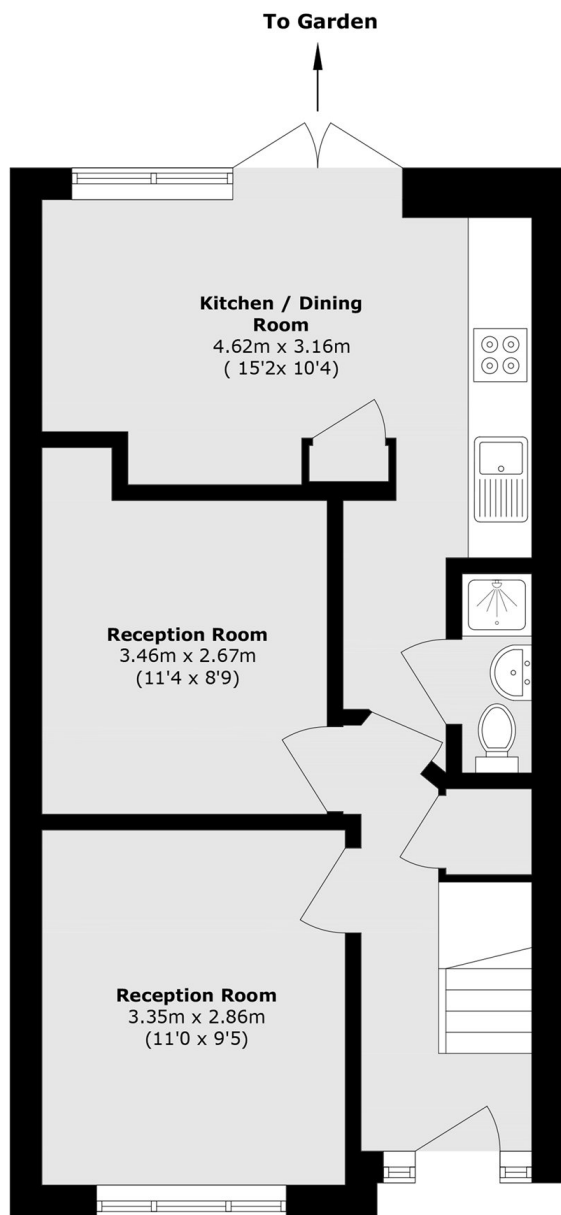

Ground Floor

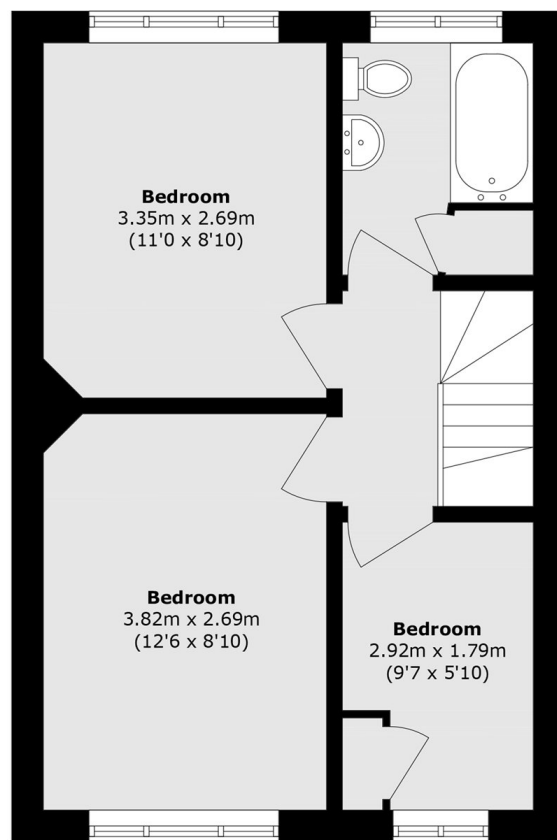

First Floor

Total area (approx.): 75.8 sq. m (815.9 sq. ft)