



## Newington Causeway, SE1

£325,000

A beautifully presented apartment featuring a spacious open-plan living and kitchen area, two generously sized double bedrooms, and a modern three-piece bathroom. Residents enjoy 24-hour concierge service, parking, a gym, and a swimming pool. Offered chain free

Elephant & Castle station provides superb links into the City via the Bakerloo and Northern lines, as well as the Overground, with London Bridge and Waterloo just one stop away. The area is alive with energy, offering a diverse mix of shops, bars, and restaurants, from independent coffee houses to vibrant street food markets, along with cultural landmarks such as the Southbank, the Imperial War Museum, and the buzzing Mercato Metropolitano food hall all within easy reach.

### Features

Gym & Swimming Pool  
24 Hour Concierge  
Residents' Parking  
Valid EWS1 Form  
Chain Free Sale

# Newington Causeway, London, SE1

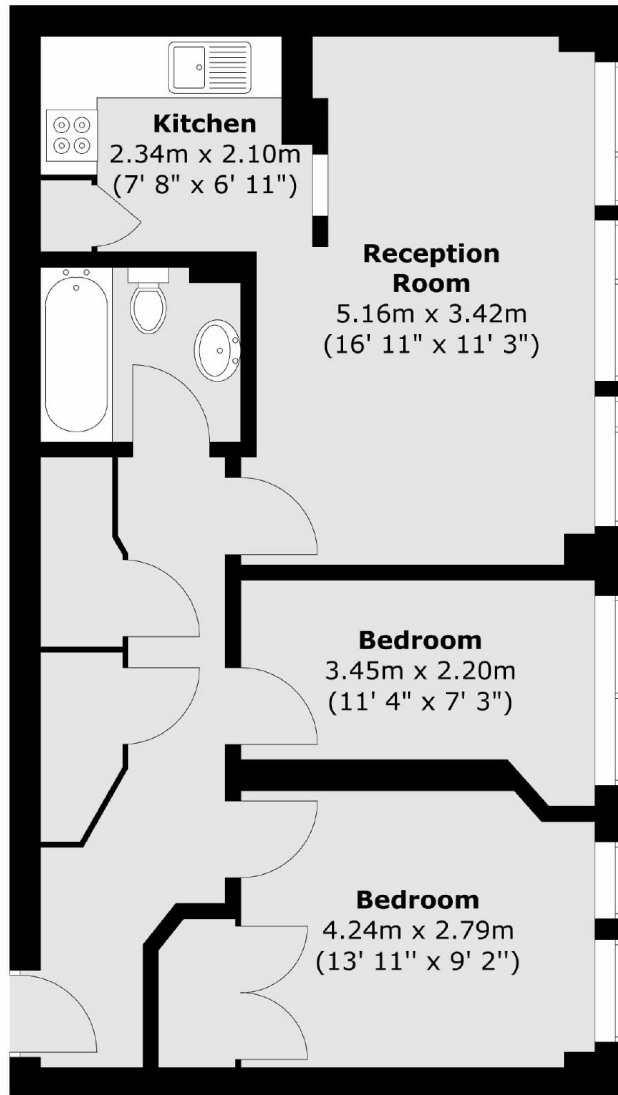

Total area (approx.) : 54.4 sq. m (585 sq. ft)