





**Towers
Wills**

Town & Country

42 Elmleigh, Yeovil, Somerset, BA21 3UJ

£520,000

 01935 577 032 | 01460 298 530 |  info@towerswills.co.uk



Towers Wills welcome to the market this stunning five-bedroom detached family home in a quiet cul-de-sac within the sought-after Elmleigh area of Abbey Manor Park. Features include a dual-aspect living room with wood-burning stove, a stylish kitchen/diner, and a striking dining room with vaulted ceiling and arched windows overlooking the garden. Five double bedrooms, two en-suite, plus a luxurious family bathroom. Driveway, integral double garage, enclosed rear garden, and open aspect to the front.

Key Features

Detached Family Home

Immaculate Presentation Throughout

Popular Abbey Manor Park

Five Bedrooms

Master En-suite

Double Garage

Driveway

Gardens





Tucked away at the end of a peaceful cul-de-sac within a highly sought-after position Abbey Manor Park, this exceptional five-bedroom detached family home enjoys a prime position with no passing traffic and a delightful open outlook—offering both privacy and tranquillity in equal measure.

A spacious and welcoming reception hallway sets the tone for the home, providing an impressive first impression and a natural flow into the principal living spaces. The living room is a warm and inviting retreat, centred around a charming wood-burning stove with a stone surround, while a window to the front aspect fills the room with natural light. Glazed double doors open seamlessly into the family room, a versatile space perfectly suited to modern family life, with French doors leading out to the rear garden.



At the heart of the home lies a stunning open-plan kitchen/dining space—designed with both style and functionality in mind. The kitchen is beautifully appointed with a comprehensive range of quality wall, base and drawer units, complemented by quartz work surfaces and matching upstands. Integrated appliances include an electric oven, gas hob with stainless steel cooker hood, and dishwasher, all enhanced by subtle under-cupboard lighting. Flowing effortlessly into the dining area, this space is ideal for entertaining, with a striking vaulted ceiling and arched window creating a wonderful sense of light and volume.

The triple-aspect dining room enjoys a pleasant outlook over the rear garden, making it a perfect setting for gatherings with family and friends. The ground floor is further complemented by a convenient cloakroom/WC.



Upstairs, the property continues to impress with five well-proportioned bedrooms, all of which are generous doubles with built-in wardrobes (no built-in wardrobes to bedroom 5). The principal bedroom benefits from a luxurious en suite, featuring a double shower, vanity wash hand basin and WC with stylish tiling. Bedroom two also enjoys its own en suite shower room, providing additional comfort and convenience for family or guests.

Externally, the property occupies a superb plot at the end of the cul-de-sac, with a driveway offering ample off-road parking and leading to an integral double garage with twin up-and-over doors, power and lighting. To the rear, the garden has been thoughtfully designed for both relaxation and entertaining, with a large patio area ideal for al fresco dining, a well-maintained lawn, and established borders stocked with a variety of plants and shrubs. Additional features include an outside tap, external lighting, and gated side access.

This is a truly outstanding family home, combining generous living space, high-quality finishes and an enviable location—perfect for those seeking a peaceful yet well-connected setting.





GROUND FLOOR

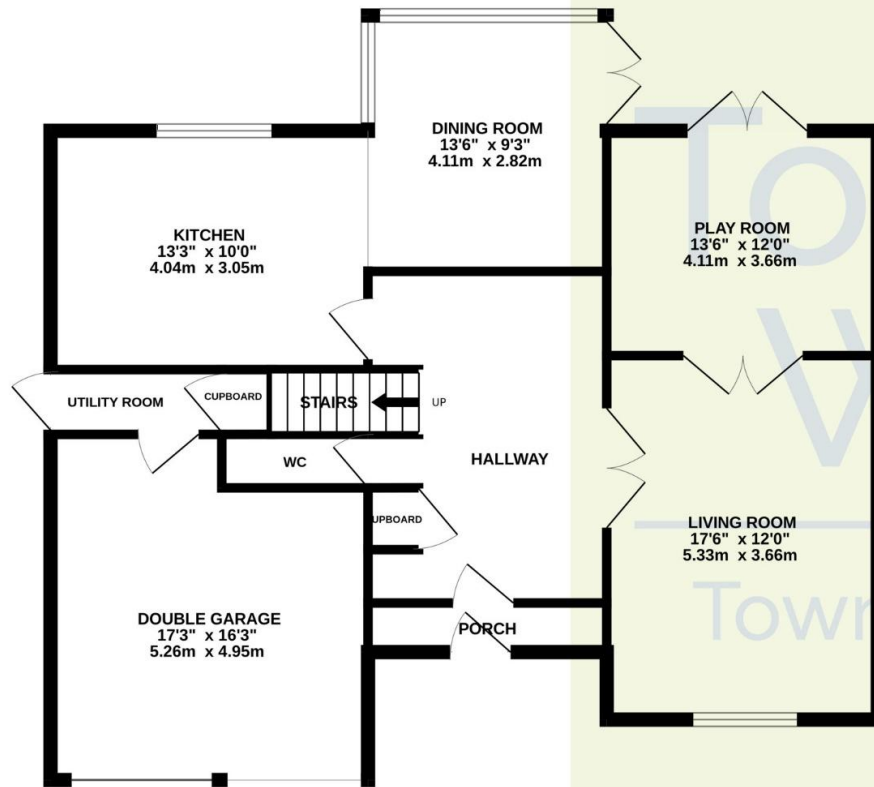

1ST FLOOR

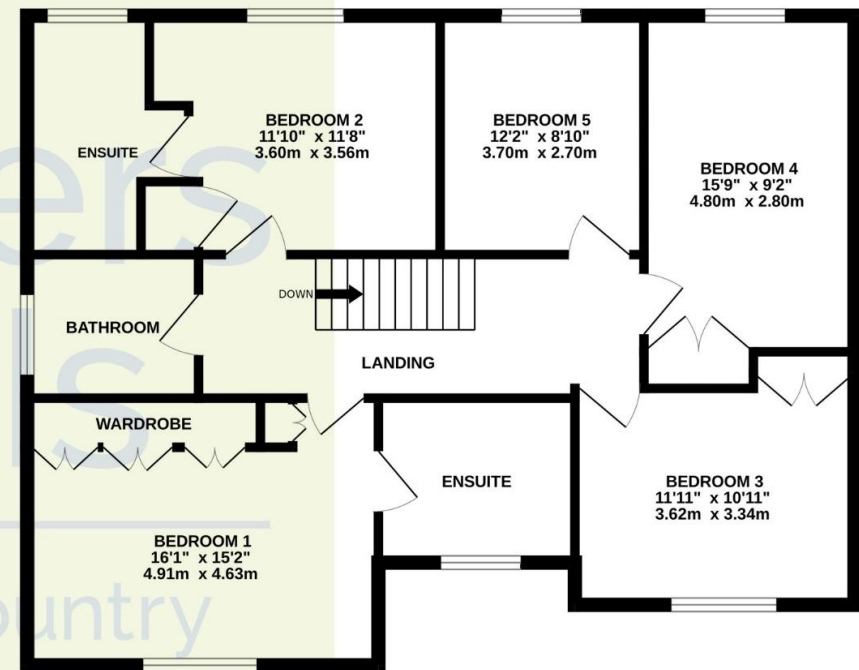

Whilst every attempt has been made to ensure the accuracy of the floorplan contained here, measurements of doors, windows, rooms and any other items are approximate and no responsibility is taken for any error, omission or mis-statement. This plan is for illustrative purposes only and should be used as such by any prospective purchaser. The services, systems and appliances shown have not been tested and no guarantee as to their operability or efficiency can be given.

Made with Metropix ©2026

T: 01935 577032 E: info@towerswills.co.uk

The White House 114 Hendford Hill, Yeovil, Somerset BA20 2RF

www.towerswills.co.uk

Please Note No tests have been undertaken of any of the services and any intending purchasers should satisfy themselves in this regard. Towers Wills Ltd for themselves and for the vendor of this property whose agents they are, give notice that, (i) these particulars do not constitute any part of an offer or contract, (ii) all statements contained within these particulars are made without responsibility on the part of Towers Wills or the vendor, (iii) whilst made in good faith, none of the statements contained within these particulars are to be relied upon as a statement of representation or fact, (iv) any intending purchaser must satisfy him/herself by inspection or otherwise as to the correctness of each of the statements contained within these particulars, (v) the vendor does not make or give either Towers Wills or any person in their employment any authority to make or give representation or warranty whatsoever in relation to this property. Photographs / Floor Plans Photographs are reproduced for general information and it must not be inferred that any item is included for sale with this property. Please note floor plans are not to scale and are for identification purposes only. The photographs used in these particulars may have been taken with the use of a wide angle lens. If you have any queries as to the size of the accommodation or plot, please address these with the agent prior to making an appointment to view.