

33 Blacklock Close  
Sheriff Hill  
Gateshead  
NE9 6AS

Auction Guide  
£75,000



33 Blacklock Close  
Sheriff Hill  
Gateshead  
NE9 6AS

- \*\*\* MODERN METHOD OF AUCTION \*\*\* 2 Bed 1st Floor Flat
- Secure Entry System
- 23' Open Plan Lounge/Kitchen
- Bathroom/WC with Shower
- Allocated Parking
- Purpose Built Development
- Entrance & Reception Halls
- Master Bedroom with En Suite Shower/WC
- Gas CH & SUDG
- Council Tax Band: C EPC: C





## Ground Floor

Approx. 66.7 sq. metres (718.3 sq. feet)

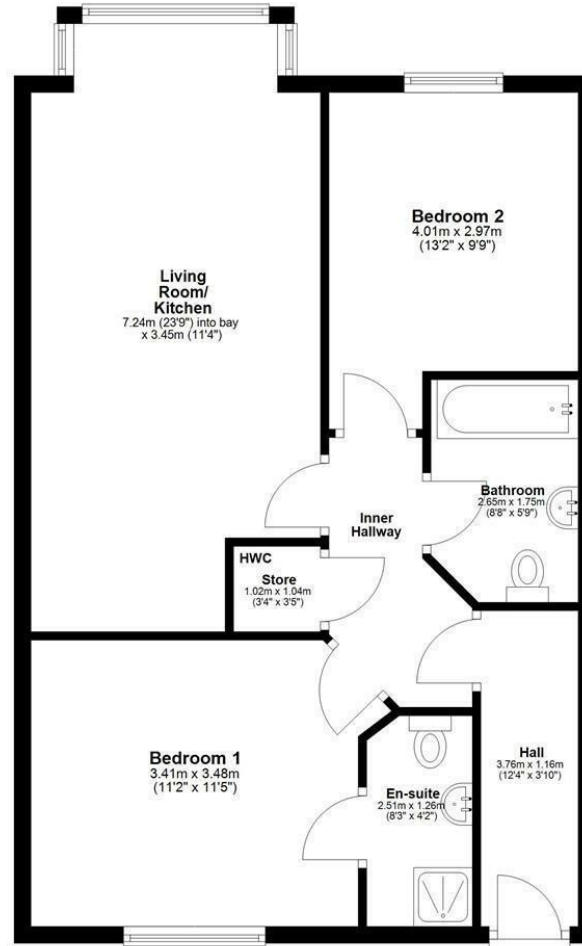

Total area: approx. 66.7 sq. metres (718.3 sq. feet)

EPC Rating: C  
Council Tax Band: C

Whilst every care has been taken to prepare these particulars, they are for guidance purposes only. All measurements are approximate and whilst every care has been taken to ensure their accuracy, they should not be relied upon and potential buyers/tenants are advised to recheck the measurements. The agent has not tested any equipment, services, fixtures or fittings and makes no representation regarding their condition.

### CONTACT

128 The Roman Way, West Denton,  
Newcastle upon Tyne, NE5 5AD

E:  
westdenton@goodfellowsestateagents.com  
T: 0191 2677500

**Goodfellows**  
estate agents.com